

- KEY: PLAN**
- Proposed Purple B Route Option
  - Proposed Maintenance Strip (3m min)
  - Proposed Indicative Structure Location
  - Stage 2 Fenceline
  - Proposed Culvert
  - Designated Watercourse
  - Undesignated Watercourse
  - Existing Ground Contours

- KEY: SECTION**
- Existing Ground Level - Mainline Purple B
  - Proposed Ground Level - Mainline Purple B

- NOTES**
- Contours are provided for illustration purposes only.
  - For information on drainage structures refer to preliminary drainage design drawings.

**PLAN: PROPOSED PURPLE B ALIGNMENT**  
SCALE 1:1250 @ A1; 1:2500 @ A3

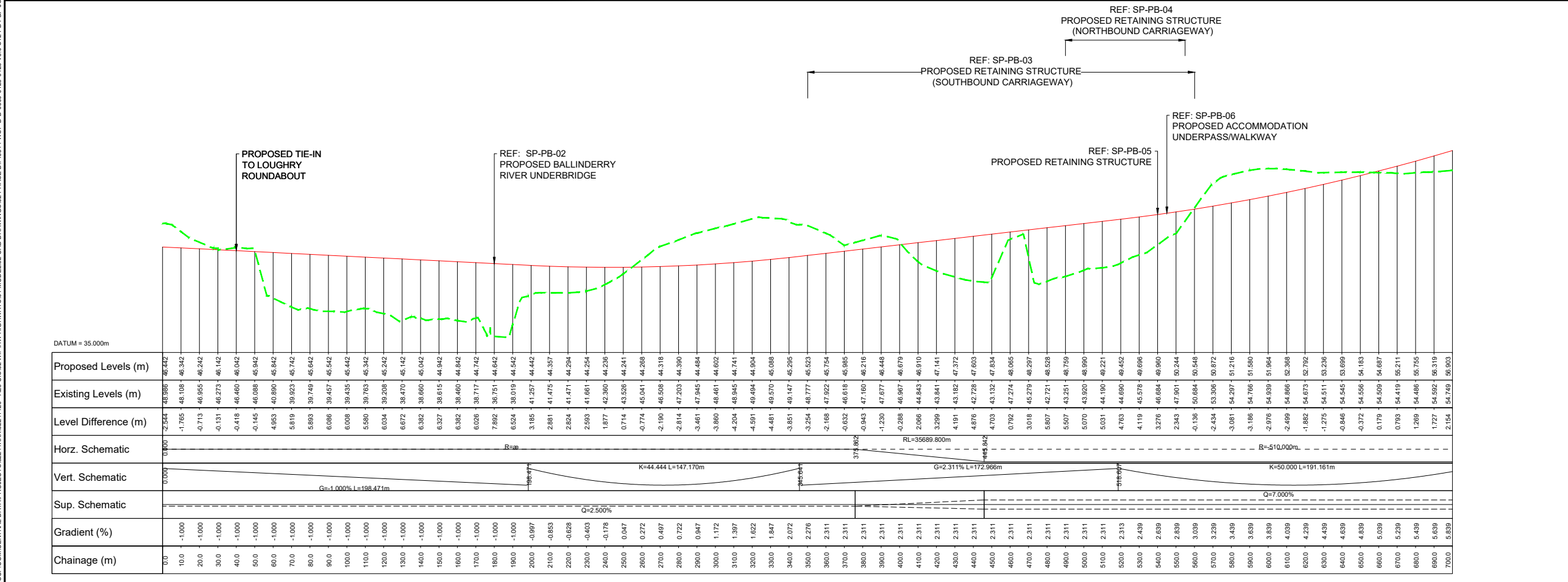

**PROFILE: PROPOSED PURPLE B ALIGNMENT**  
SCALE H 1:1250, V 1:250 @ A1; H 1:2500, V 1:500 @ A3

3.0	STG 2 FENCELINE & PROPOSED STRUCTURE LABELS ADDED	JS	LE	LE	01/10/20
2.0	EXISTING SURVEY UPDATED	RPW	RPW	EL	26/11/19
Ver	Amendment	By	Checked	Approved	Date

DRAWING STATUS: **PRELIMINARY**

Shorefield House, 30 Kinnegar Drive, Holywood, County Down, BT18 9JQ, UK  
T+ 44 (0) 28 95953020  
wsp.com

CLIENT: Department for Infrastructure  
 An Roinn Bonneagair  
www.infrastructure-ri.gov.uk

SITE PROJECT: **A29 COOKSTOWN BYPASS**

TITLE: **STAGE 2 - PURPLE B ROUTE MAINLINE PLAN AND PROFILE SHEET 1 OF 7**

SCALE @ A1: AS SHOWN	SCALE @ A3:	CHECKED: LE	25/06/2019	APPROVED: LE	25/06/2019
PROJECT NO: 718314	DESIGNED: WSP	DRAWN: RPW	DATE: 24/06/2019		
DRAWING NO: 718314-WSP-C-D-0800-0120				REV: 3.0	







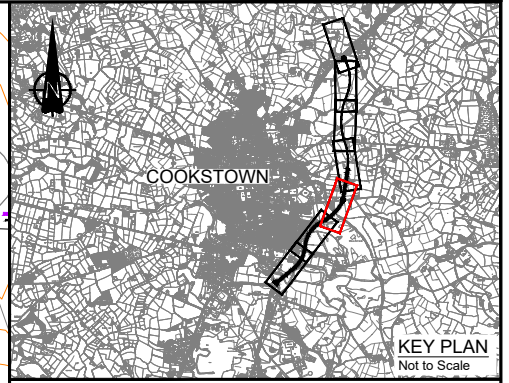
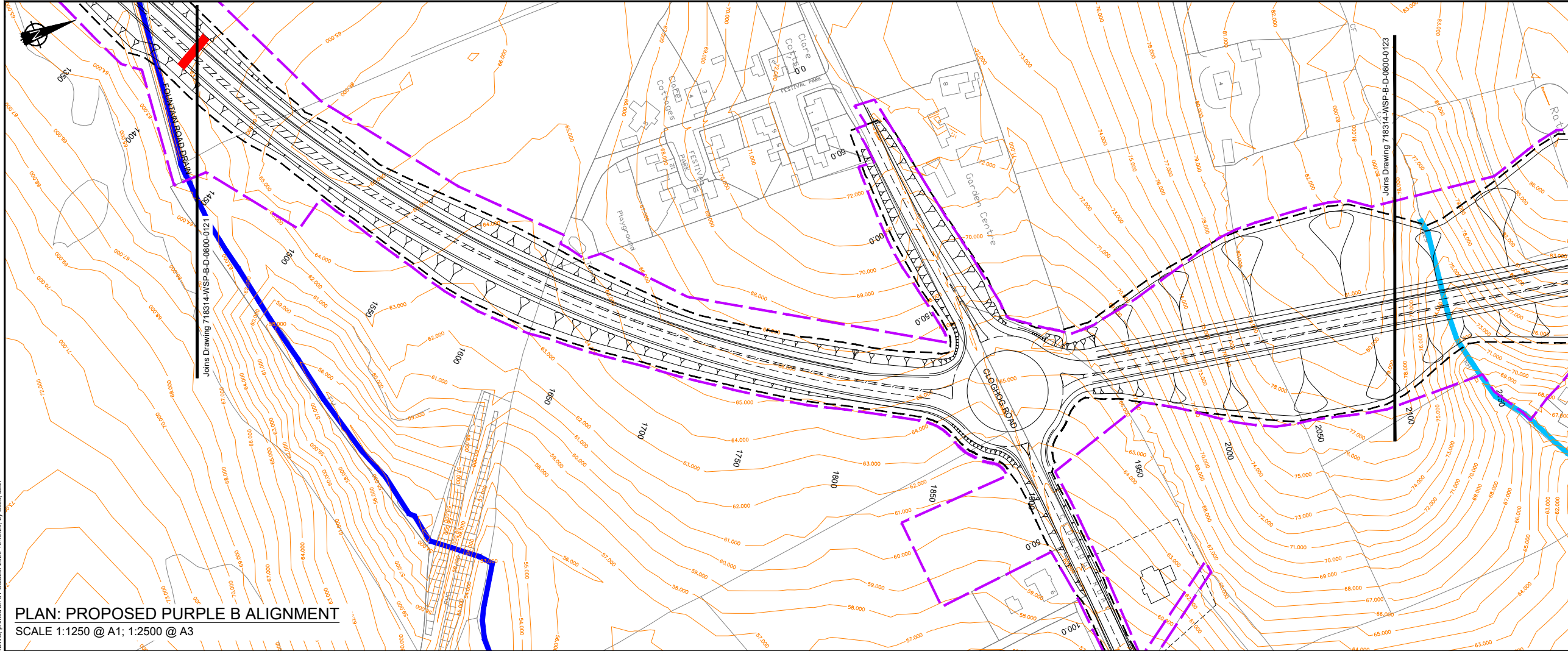

- KEY: PLAN**
- Proposed Purple B Route Option
  - Proposed Maintenance Strip (3m min)
  - Proposed Indicative Structure Location
  - Stage 2 Fenceline
  - Proposed Culvert
  - Designated Watercourse
  - Undesignated Watercourse
  - Existing Ground Contours

- KEY: SECTION**
- Existing Ground Level - Mainline Purple B
  - Proposed Ground Level - Mainline Purple B

- NOTES**
1. Contours are provided for illustration purposes only.
  2. For information on drainage structures refer to preliminary drainage design drawings.

**PLAN: PROPOSED PURPLE B ALIGNMENT**  
SCALE 1:1250 @ A1; 1:2500 @ A3

File name: I:\UK\WSPGROUP\COMP\CENTRAL DATA\PROJECTS\6241XX\6241420 - A29 - C1802\WIP\HW HIGHWAYS01 MODEL\02 CAD DRAWINGS\02 PHASE 61718314-WSP-B-D-0800-0120-0126 V3.0 ST2 PB P&F JS.DWG, printed on 01 October 2020 10:42:20, by Scott, Jack

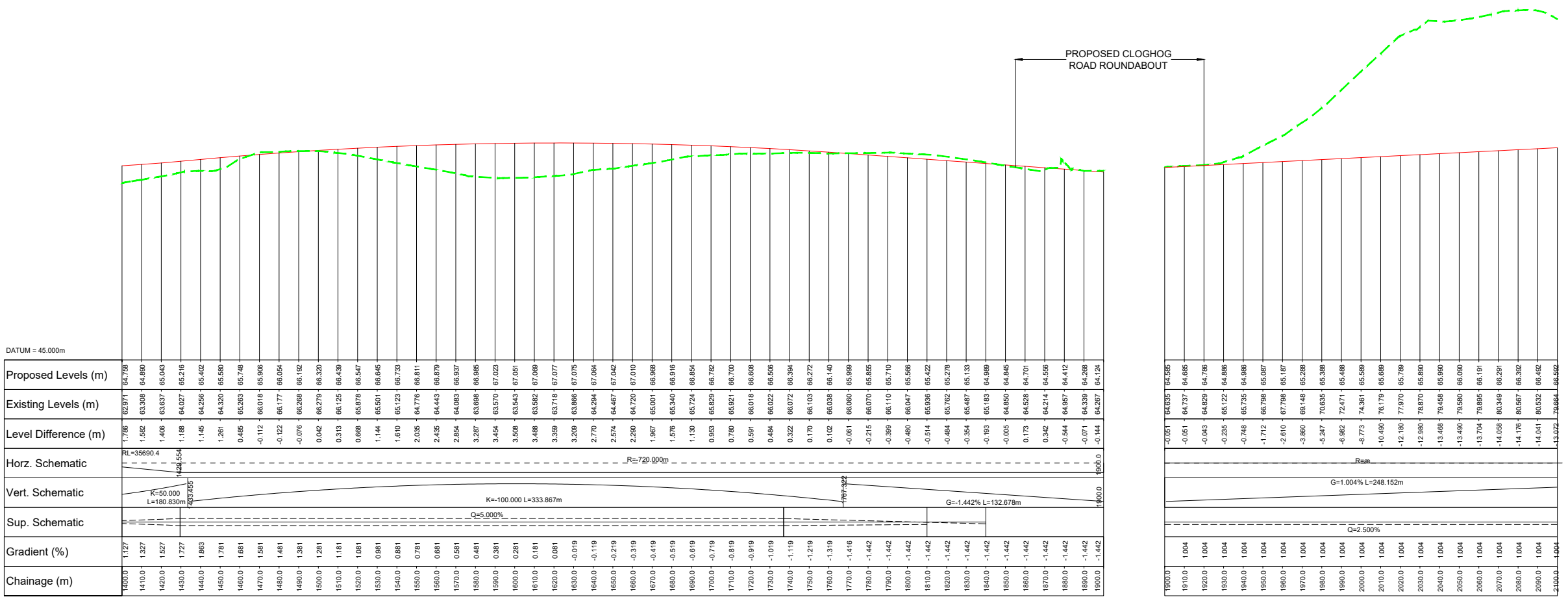

**PROFILE: PROPOSED PURPLE B ALIGNMENT**  
SCALE H 1:1250, V 1:250 @ A1; H 1:2500, V 1:500 @ A3

3.0	STG 2 FENCELINE & PROPOSED STRUCTURE LABELS ADDED	JS	LE	LE	01/10/20
2.0	EXISTING SURVEY UPDATED	RPW	RPW	EL	26/11/19
Ver	Amendment	By	Checked	Approved	Date

DRAWING STATUS: **PRELIMINARY**

Shorefield House, 30 Kinnegar Drive, Hollywood, County Down, BT18 9JQ, UK  
T+ 44 (0) 28 95953020  
wsp.com

CLIENT:

SITE PROJECT: **A29 COOKSTOWN BYPASS**

TITLE: **STAGE 2 - PURPLE B ROUTE MAINLINE PLAN AND PROFILE SHEET 3 OF 7**

SCALE @ A1: AS SHOWN	SCALE @ A3:	CHECKED: LE	25/06/2019	APPROVED: LE	25/06/2019
PROJECT NO: 718314	DESIGNED: WSP	DRAWN: RPW	DATE: 24/06/2019		
DRAWING NO: 718314-WSP-C-D-0800-0122					REV: 3.0



File name: \\UK.WSPGROUP\COMP\CENTRAL DATA\PROJECTS\A29 - A29 - C1502 WIP\HW HIGHWAYS\01 MODEL\02 CAD DRAWINGS\02 PHASE 01\718314-WSP-B-D-0800-0120-0120 V3.0 ST2 PB P&F JS.DWG, printed on 01 October 2020 10:42:43, by Scott, Jack

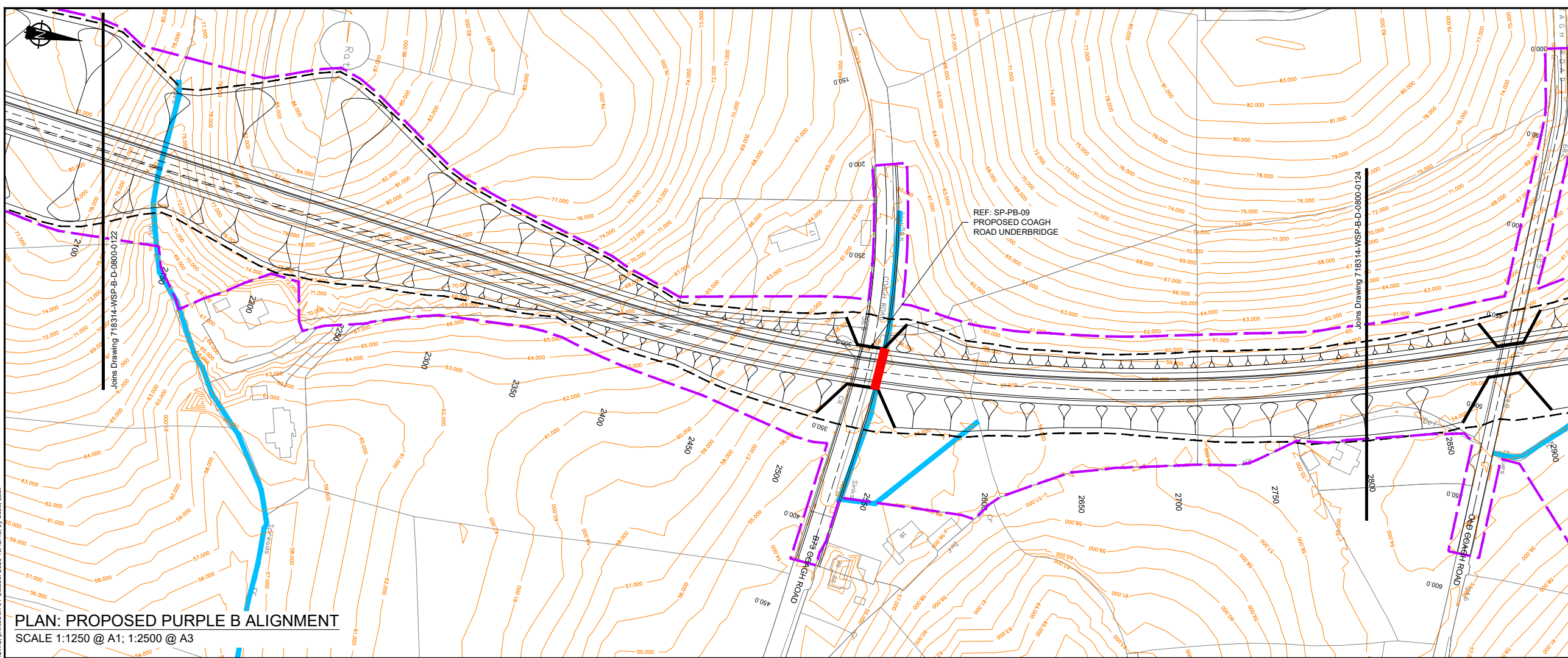

**PLAN: PROPOSED PURPLE B ALIGNMENT**  
SCALE 1:1250 @ A1; 1:2500 @ A3

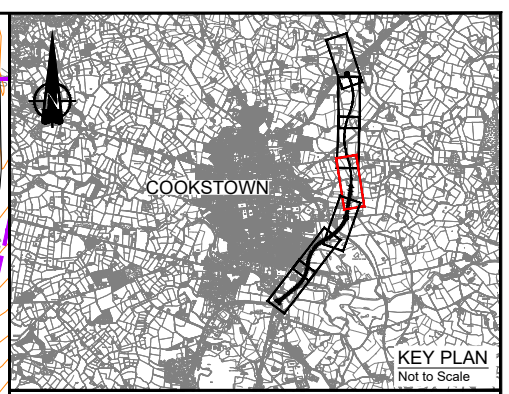

- KEY: PLAN**
- Proposed Purple B Route Option
  - Proposed Maintenance Strip (3m min)
  - Proposed Indicative Structure Location
  - Stage 2 Fenceline
  - Proposed Culvert
  - Designated Watercourse
  - Undesignated Watercourse
  - Existing Ground Contours

- KEY: SECTION**
- Existing Ground Level - Mainline Purple B
  - Proposed Ground Level - Mainline Purple B

- NOTES**
- Contours are provided for illustration purposes only.
  - For information on drainage structures refer to preliminary drainage design drawings.

3.0	STG 2 FENCELINE & PROPOSED STRUCTURE LABELS ADDED	JS	LE	LE	01/10/20
2.0	EXISTING SURVEY UPDATED	RPW	RPW	EL	26/11/19
Ver	Amendment	By	Checked	Approved	Date

DRAWING STATUS: **PRELIMINARY**

Shorefield House, 30 Kinnegar Drive, Holywood, County Down, BT18 9JQ, UK  
T+ 44 (0) 28 95953020  
wsp.com

CLIENT:

SITE PROJECT: **A29 COOKSTOWN BYPASS**

TITLE: **STAGE 2 - PURPLE B ROUTE MAINLINE PLAN AND PROFILE SHEET 4 OF 7**

SCALE @ A1: AS SHOWN	SCALE @ A3:	CHECKED: LE	25/06/2019	APPROVED: LE	25/06/2019
PROJECT NO: 718314	DESIGNED: WSP	DRAWN: RPW	DATE: 24/06/2019		

DRAWING NO: 718314-WSP-C-D-0800-0123	REV: 3.0
--------------------------------------	----------

© WSP UK Ltd

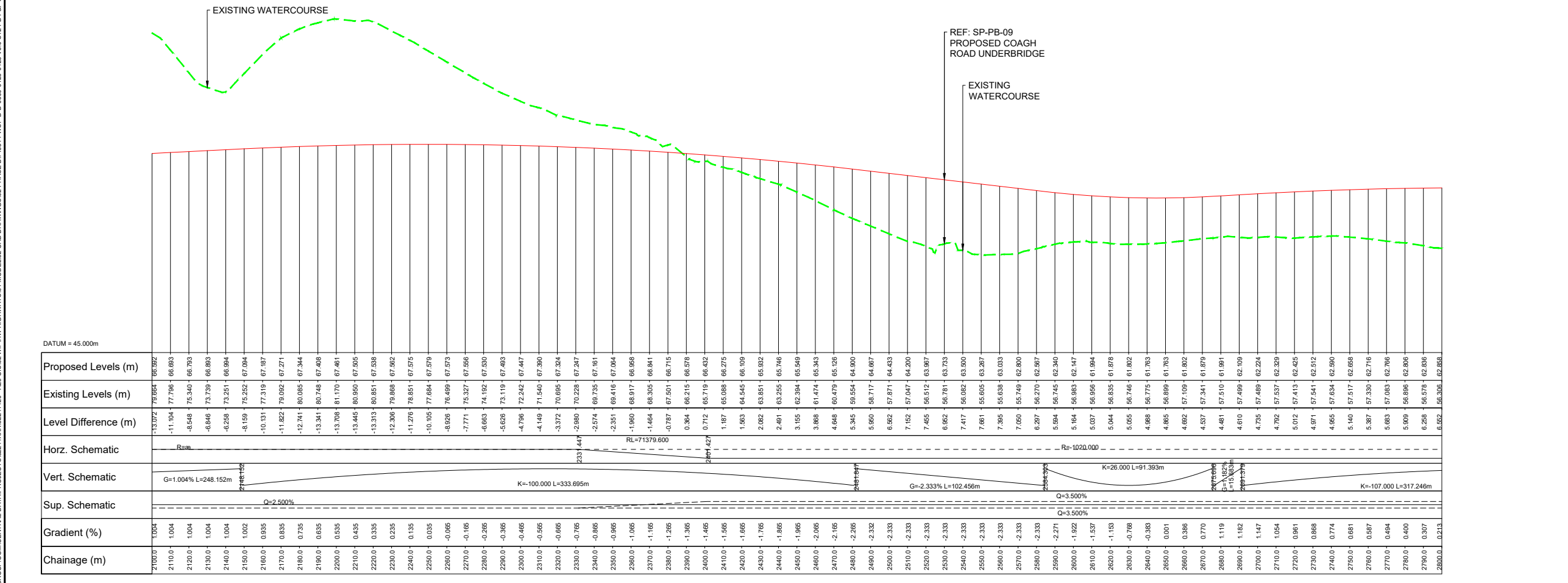

**PROFILE: PROPOSED PURPLE B ALIGNMENT**  
SCALE H 1:1250, V 1:250 @ A1; H 1:2500, V 1:500 @ A3



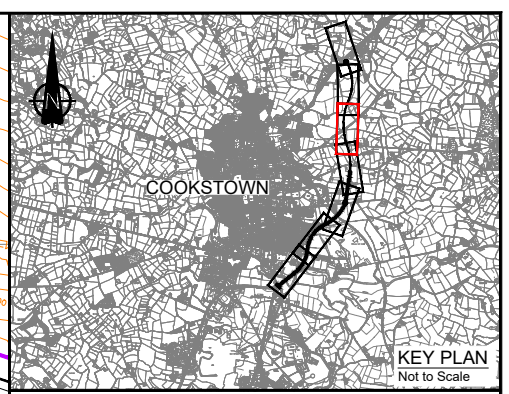
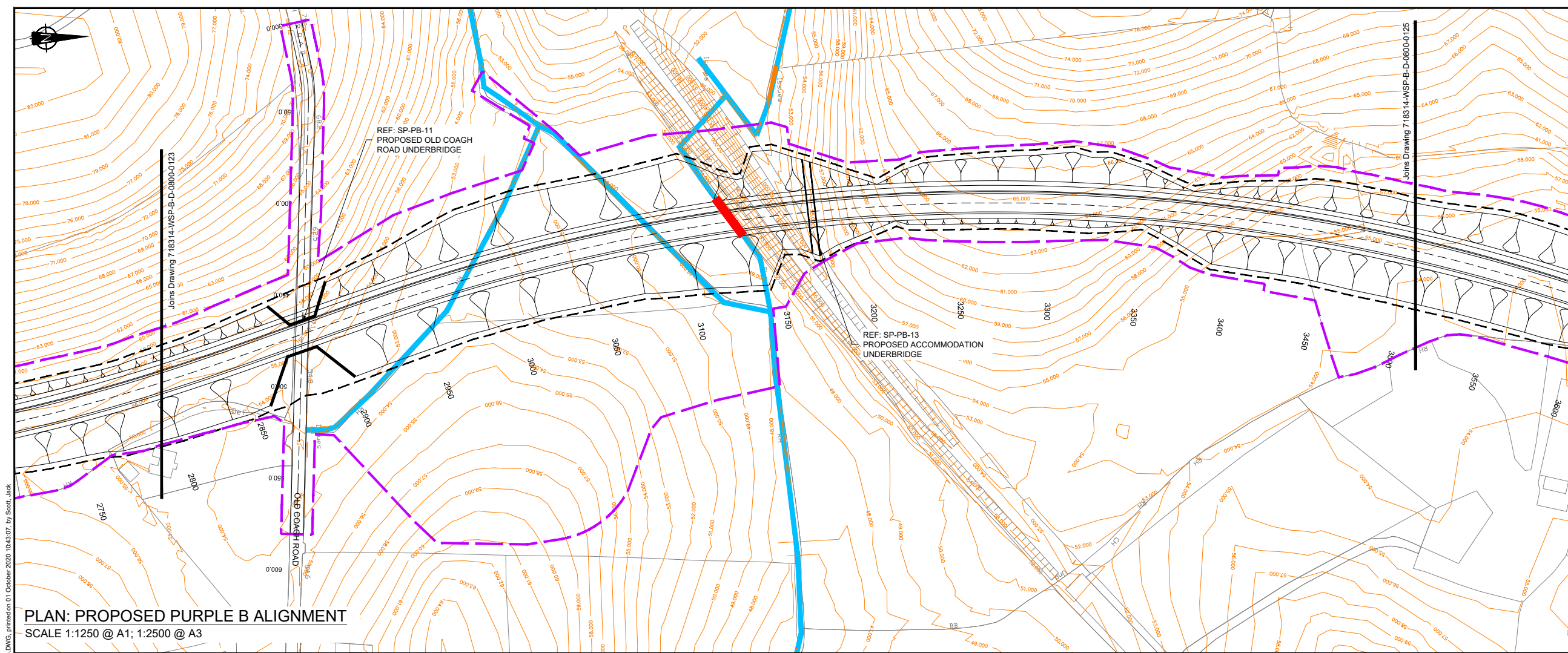

- KEY: PLAN**
- Proposed Purple B Route Option
  - Proposed Maintenance Strip (3m min)
  - Proposed Indicative Structure Location
  - Stage 2 Fenceline
  - Proposed Culvert
  - Designated Watercourse
  - Undesignated Watercourse
  - Existing Ground Contours

- KEY: SECTION**
- Existing Ground Level - Mainline Purple B
  - Proposed Ground Level - Mainline Purple B

- NOTES**
1. Contours are provided for illustration purposes only.
  2. For information on drainage structures refer to preliminary drainage design drawings.

**PLAN: PROPOSED PURPLE B ALIGNMENT**  
SCALE 1:1250 @ A1; 1:2500 @ A3

File name: I:\UK\WSP\GROUP\COMP\CENTRAL DATA\PROJECTS\A29\_A39\_C18\02\_WIP\HW\_Highways\01\_MODEL\02\_CAD DRAWINGS\02\_PHASE 01\0120-0126\_V3.0 ST2 PB P&P\_J.S.DWG, printed on 01 October 2020 10:43:07, by Scott, Jack

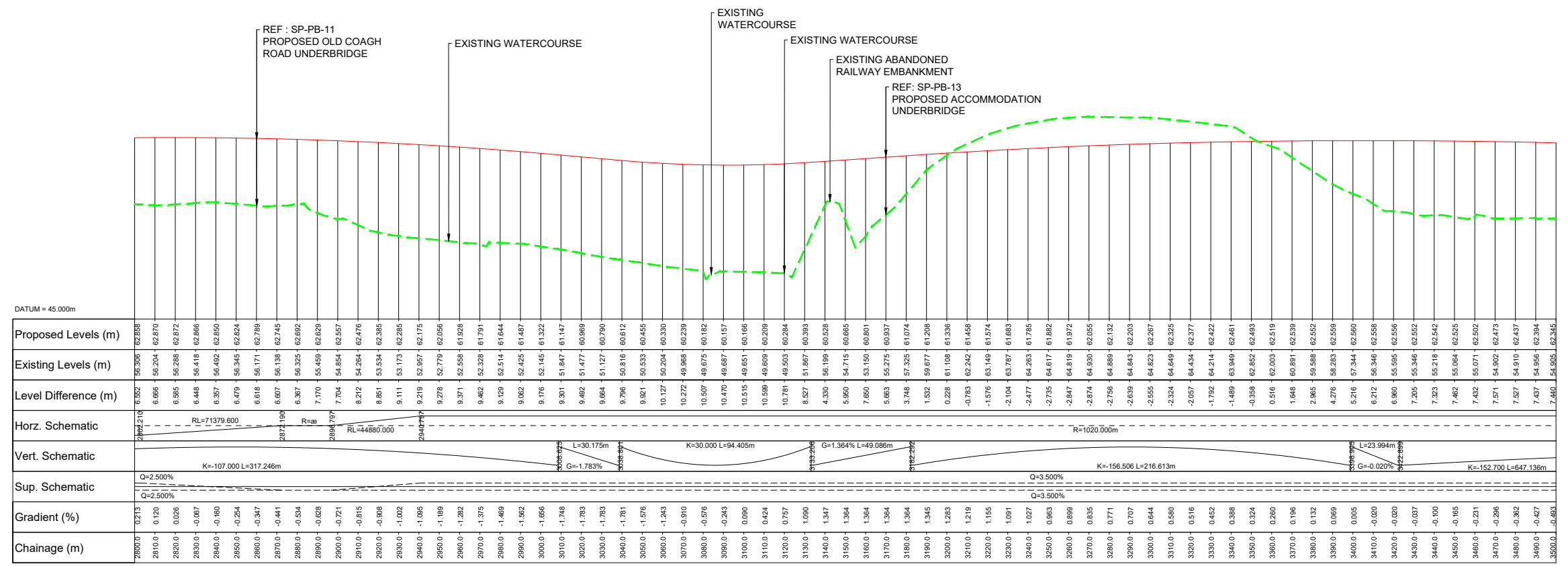

**PROFILE: PROPOSED PURPLE B ALIGNMENT**  
SCALE H 1:1250, V 1:250 @ A1; H 1:2500, V 1:500 @ A3

3.0	STG 2 FENCELINE & PROPOSED STRUCTURE LABELS ADDED	JS	LE	LE	01/10/20
2.0	EXISTING SURVEY UPDATED	RPW	RPW	EL	26/11/19
Ver	Amendment	By	Checked	Approved	Date

DRAWING STATUS: **PRELIMINARY**

Shorefield House, 30 Kinnegar Drive, Holywood, County Down, BT18 9JQ, UK  
T+ 44 (0) 28 95953020  
wsp.com

CLIENT: Department for Infrastructure  
**Bonneagair**  
www.infrastructure-ri.gov.uk

SITE PROJECT: **A29 COOKSTOWN BYPASS**

TITLE: **STAGE 2 - PURPLE B ROUTE MAINLINE PLAN AND PROFILE SHEET 5 OF 7**

SCALE @ A1: AS SHOWN	SCALE @ A3:	CHECKED: LE	25/06/2019	APPROVED: LE	25/06/2019
PROJECT NO: 718314	DESIGNED: WSP	DRAWN: RPW	DATE: 24/06/2019		
DRAWING NO: 718314-WSP-C-D-0800-0124					REV: 3.0



File name: I:\UK\WSP\GROUP\COMP\CENTRAL DATA\PROJECTS\A29 - A29 - C1502 WIP\HW HIGHWAYS01 MODEL02 CAD DRAWINGS\02 PHASE 01781314-WSP-B-D-0800-0126 V3.0 ST2 PB P&F JS.DWG, printed on 01 October 2020 10:43:31, by Scott, Jack

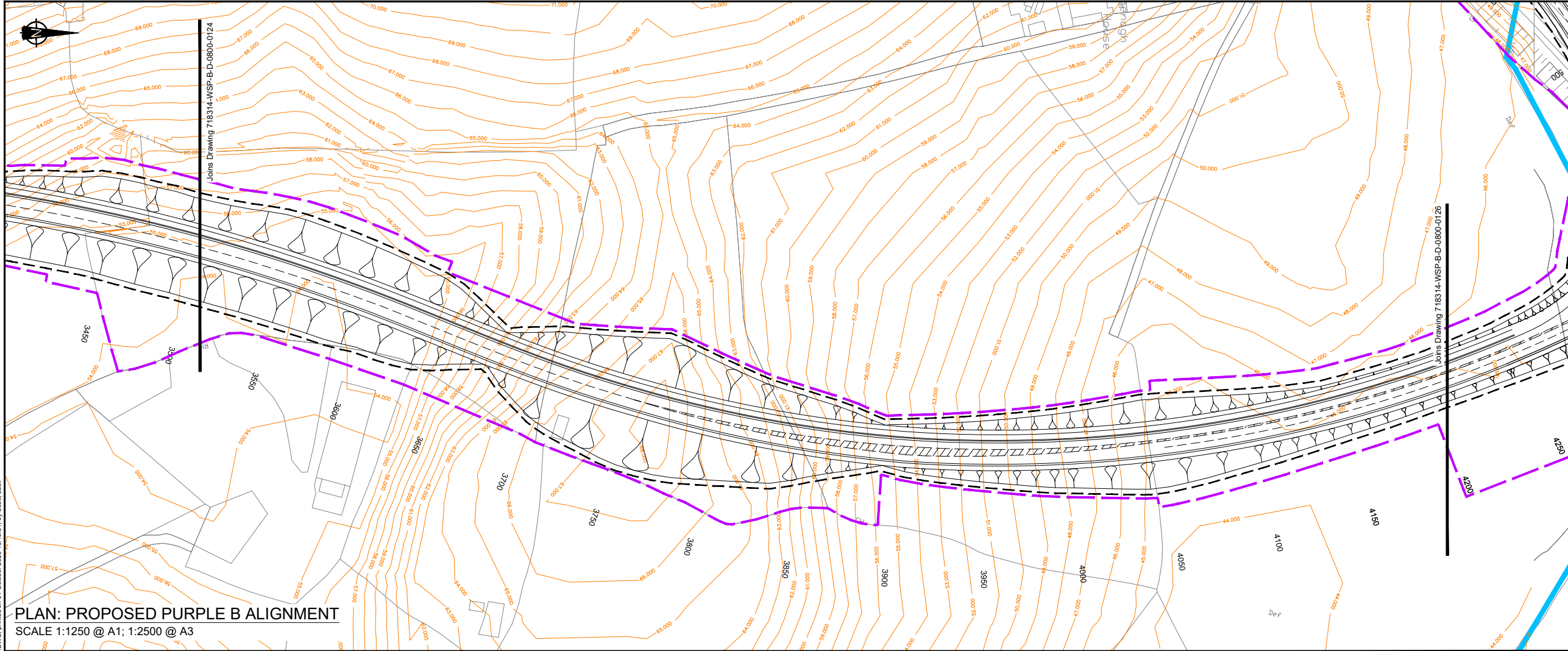

**PLAN: PROPOSED PURPLE B ALIGNMENT**  
SCALE 1:1250 @ A1; 1:2500 @ A3

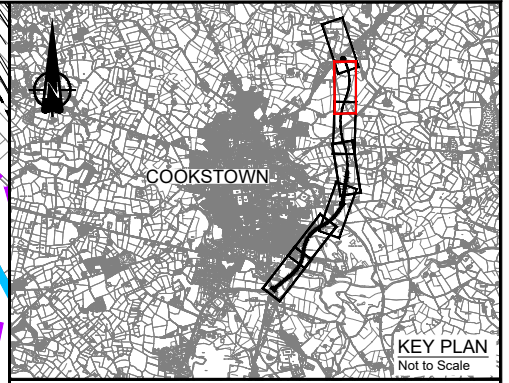

- KEY: PLAN**
- Proposed Purple B Route Option
  - Proposed Maintenance Strip (3m min)
  - Proposed Indicative Structure Location
  - Stage 2 Fenceline
  - Proposed Culvert
  - Designated Watercourse
  - Undesignated Watercourse
  - Existing Ground Contours

- KEY: SECTION**
- Existing Ground Level - Mainline Purple B
  - Proposed Ground Level - Mainline Purple B

- NOTES**
- Contours are provided for illustration purposes only.
  - For information on drainage structures refer to preliminary drainage design drawings.

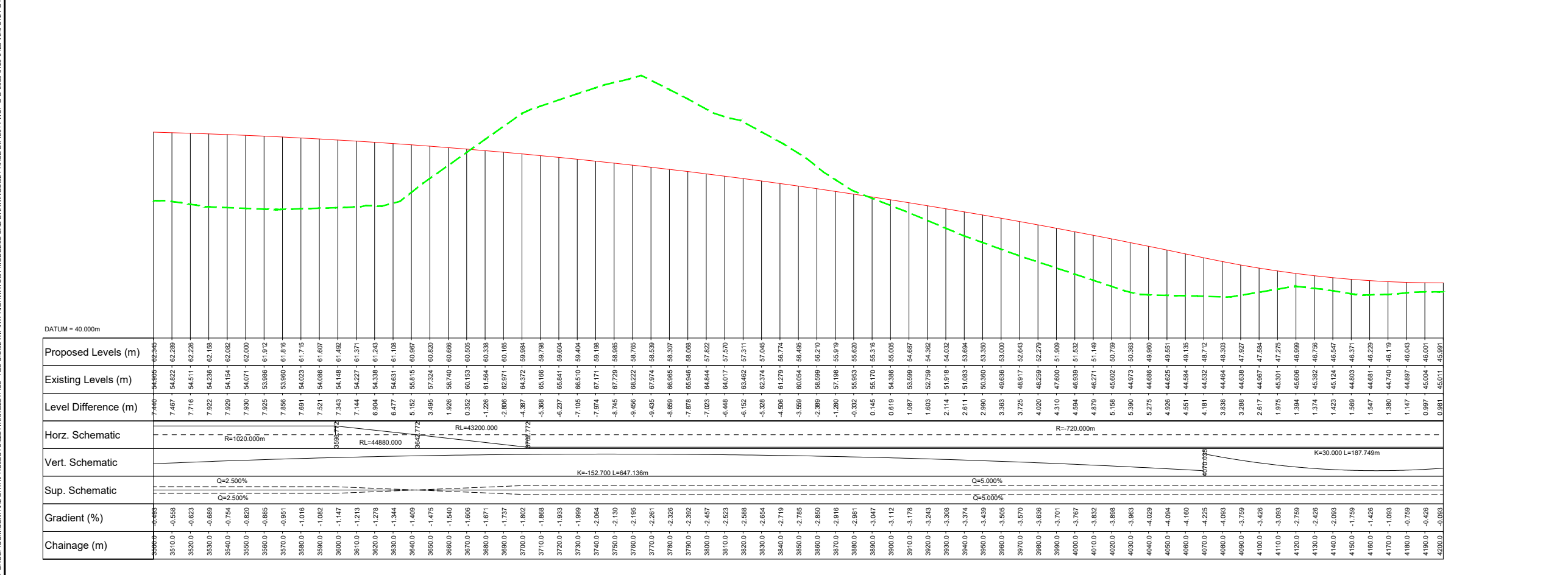

**PROFILE: PROPOSED PURPLE B ALIGNMENT**  
SCALE H 1:1250, V 1:250 @ A1; H 1:2500, V 1:500 @ A3

3.0	STG 2 FENCELINE & PROPOSED STRUCTURE LABELS ADDED	JS	LE	LE	01/10/20
2.0	EXISTING SURVEY UPDATED	RPW	RPW	EL	26/11/19
Ver	Amendment	By	Checked	Approved	Date

DRAWING STATUS: **PRELIMINARY**

Shorefield House, 30 Kinnegar Drive, Holywood, County Down, BT18 9JQ, UK  
T+ 44 (0) 28 95953020  
wsp.com

CLIENT: Department for Infrastructure

SITE PROJECT: **A29 COOKSTOWN BYPASS**

TITLE: **STAGE 2 - PURPLE B ROUTE MAINLINE PLAN AND PROFILE SHEET 6 OF 7**

SCALE @ A1: AS SHOWN	SCALE @ A3:	CHECKED: LE	25/06/2019	APPROVED: LE	25/06/2019
PROJECT NO: 718314	DESIGNED: WSP	DRAWN: RPW	DATE: 24/06/2019		

DRAWING NO: 718314-WSP-C-D-0800-0125	REV: 3.0
--------------------------------------	----------



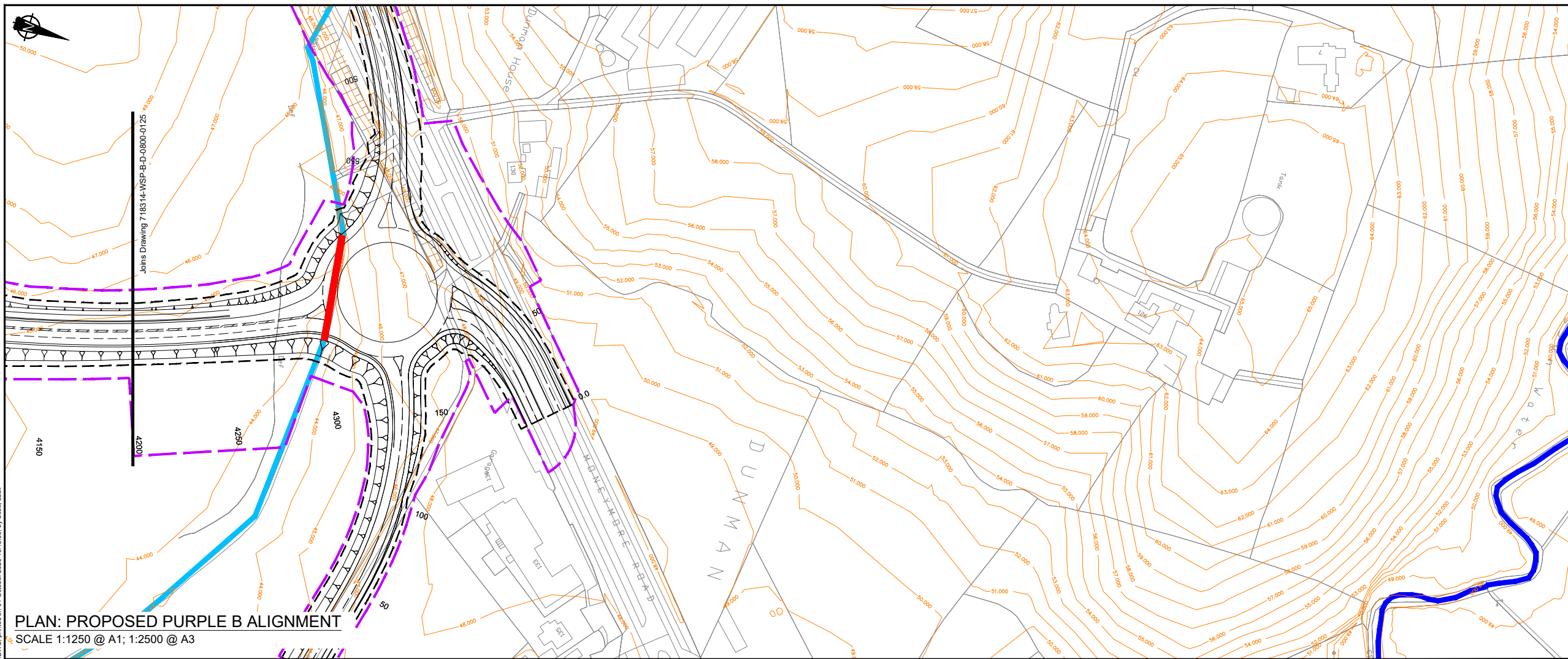

**PLAN: PROPOSED PURPLE B ALIGNMENT**  
 SCALE 1:1250 @ A1; 1:2500 @ A3

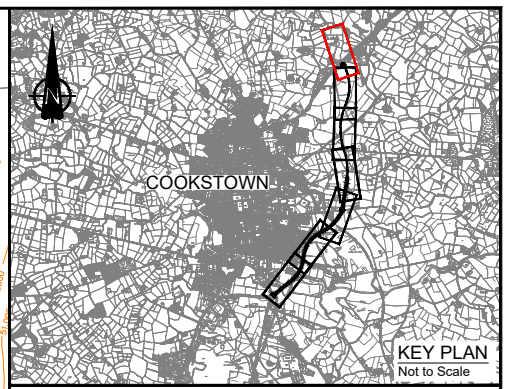

- KEY: PLAN**
- Proposed Purple B Route Option
  - Proposed Maintenance Strip (3m min)
  - Proposed Indicative Structure Location
  - Stage 2 Fenceline
  - Proposed Culvert
  - Designated Watercourse
  - Undesignated Watercourse
  - Existing Ground Contours

- KEY: SECTION**
- Existing Ground Level - Mainline Purple B
  - Proposed Ground Level - Mainline Purple B

- NOTES**
1. Contours are provided for illustration purposes only.
  2. For information on drainage structures refer to preliminary drainage design drawings.

File name: I:\UK\WSP\GROUP\COMP\CENTRAL DATA\PROJECTS\A29 COOKSTOWN\WIP\HW HIGHWAYS\01 MODEL\02 CAD DRAWINGS\02 PHASE 01\718314-WSP-B-D-0800-0126 V3.0 ST2 PB P&P J.S.DWG, printed on 01 October 2020 10:43:56, by Scott, Jack

3.0	STG 2 FENCELINE & PROPOSED STRUCTURE LABELS ADDED	JS	LE	LE	01/10/20
2.0	EXISTING SURVEY UPDATED	RPW	RPW	EL	26/11/19
Ver	Amendment	By	Checked	Approved	Date

DRAWING STATUS: **PRELIMINARY**

Shorefield House, 30 Kinnegar Drive, Holywood, County Down, BT18 9JQ, UK  
 T+ 44 (0) 28 95953020  
 wsp.com

CLIENT: **Infrastructure**  
 An Roimn **Bonneagair**  
[www.infrastructure-ri.co.uk](http://www.infrastructure-ri.co.uk)

SITE/PROJECT: **A29 COOKSTOWN BYPASS**

TITLE: **STAGE 2 - PURPLE B ROUTE MAINLINE PLAN AND PROFILE SHEET 7 OF 7**

SCALE @ A1:	SCALE @ A3:	CHECKED:	APPROVED:
AS SHOWN	LE	25/06/2019	LE 25/06/2019
PROJECT NO:	DESIGNED:	DRAWN:	DATE:
718314	WSP	RPW	24/06/2019
DRAWING NO:	718314-WSP-C-D-0800-0126		REV: 3.0

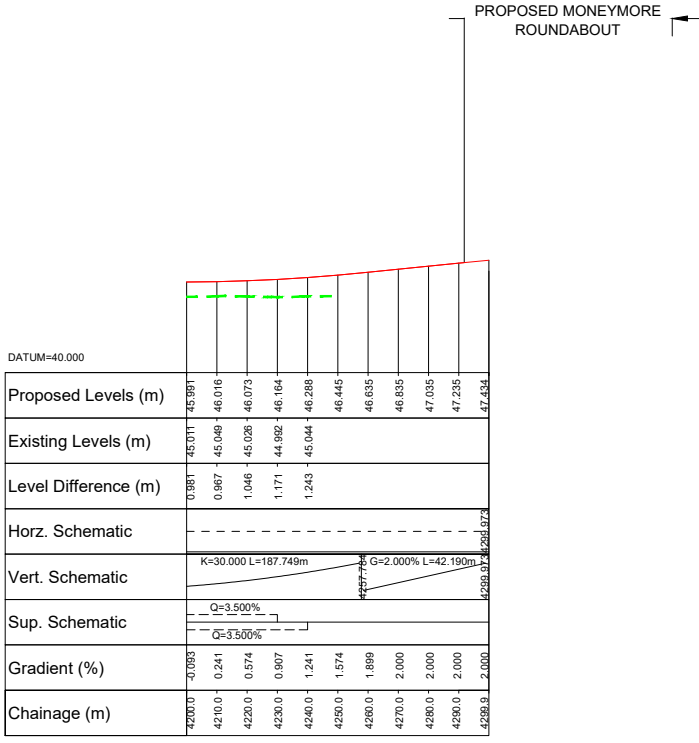

**PROFILE: PROPOSED PURPLE B ALIGNMENT**  
 SCALE H 1:1250, V 1:250 @ A1; H 1:2500, V 1:500 @ A3