

MAP 1

ORDNANCE SURVEY SHEET Nos. 097-08-SW, 097-08-SE, 097-12-NE, 097-12-SE, 097-12-NW, 097-12-SW

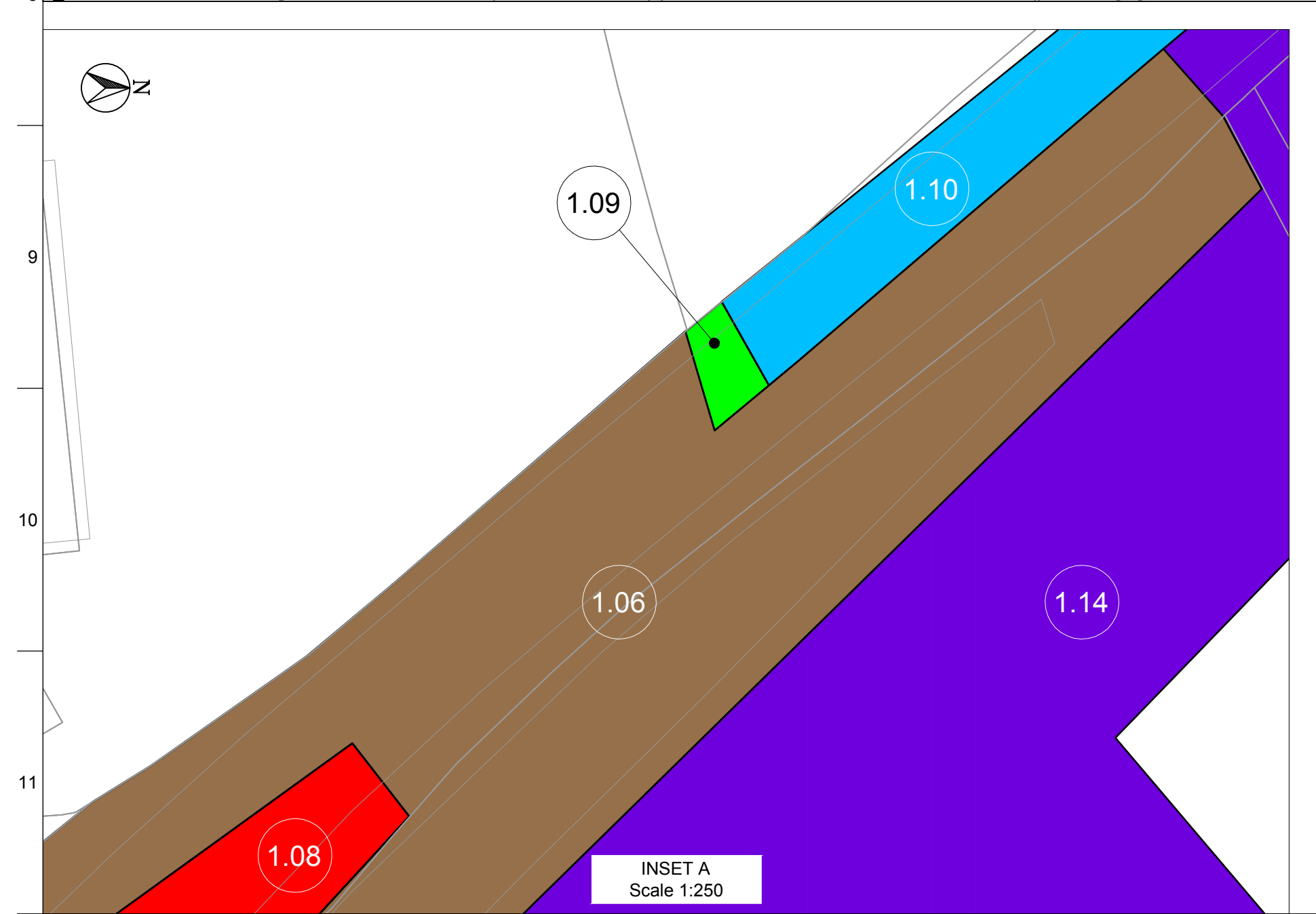
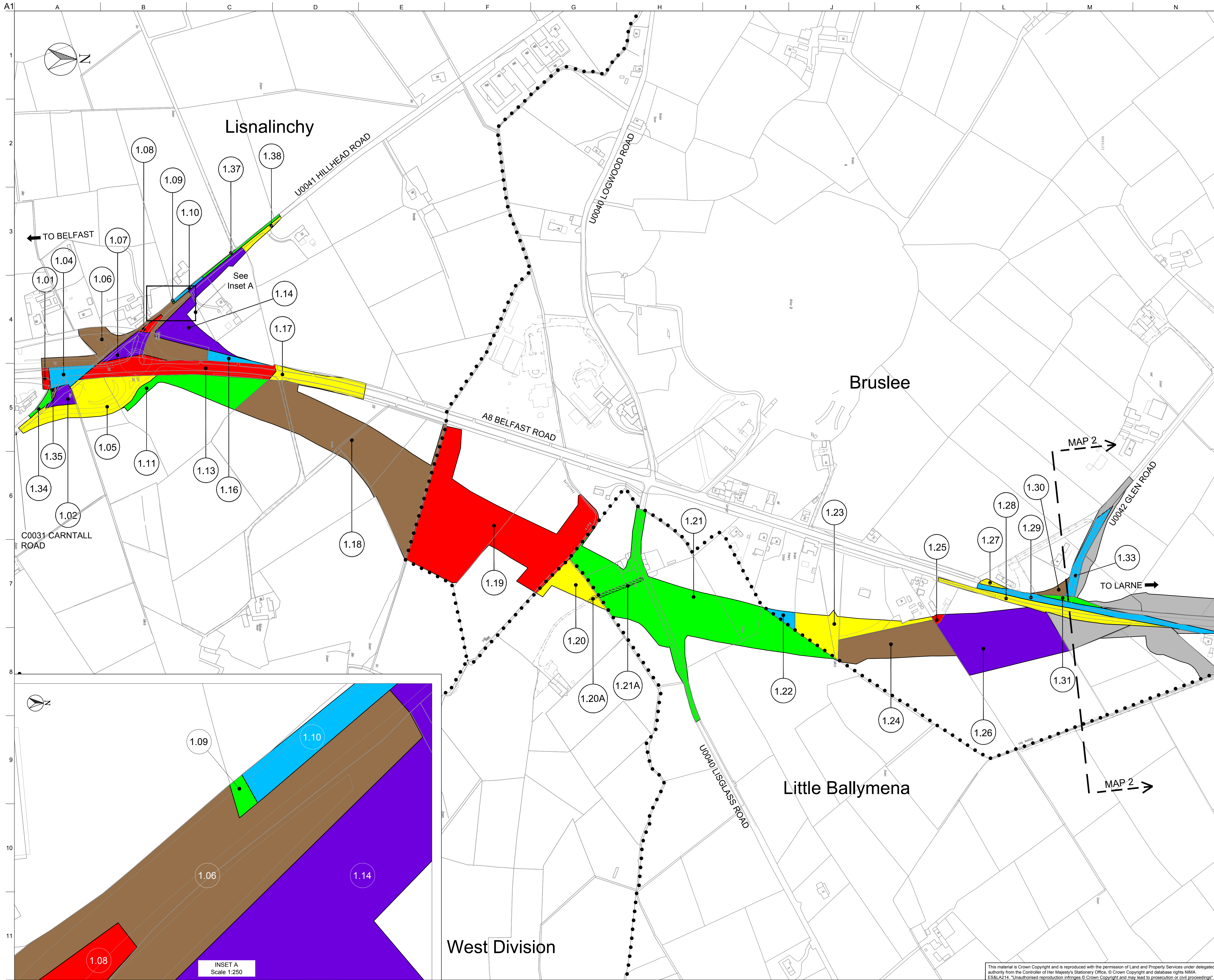

F4	06/12/11	MD	CE	JMcG
Final Vesting Order				
F3	10/11/10	CE	JMcG	CF
Increased inset box size				
F2	15/10/10	MD	JMcG	CF
Plot amended				
F1	10/09/10	MD	JMcG	CF
First Issue				
Issue	Date	By	Chkd	Appd

ARUP

The Linenhall, 8th Floor, 32-38 Linenhall Street, Belfast, BT2 8BG
Tel: +44(0)28 9089 0900 Fax: +44(0)28 9089 0901
www.arup.com



Client
Northern Division
Job Title
A8 Belfast to Larne
Dual Carriageway
(Coleman's Corner to
Ballyrickard Road)

Drawing Title
Land Plan
Sheet 1 of 10

Scale at A1 1:2500

Discipline Highways

Drawing Status
Final

Job No 124785-00 Drawing No A8_S3_4001 Issue F4

This material is Crown Copyright and is reproduced with the permission of Land and Property Services under delegated authority from the Controller of Her Majesty's Stationery Office. © Crown Copyright and database rights NIMA ES&LA214. "Unauthorised reproduction infringes © Crown Copyright and may lead to prosecution or civil proceedings"

J:\124785-004 Internal Project Data\3D Drawings\4.31 Issue Drawings_Surge 34000 Series - Land Plans\A8_S3_4001_F4.dwg 25 Jun 2012 10:43:59

MAP 2

ORDNANCE SURVEY SHEET Nos.
 097-04-SE, 097-04-SW, 097-08-NW, 097-08-NE,
 097-08-SW, 097-08-SE, 097-12-NE, 097-12-NW,
 098-05-NW, 098-05-SW, 098-09-NW, 098-01-SW

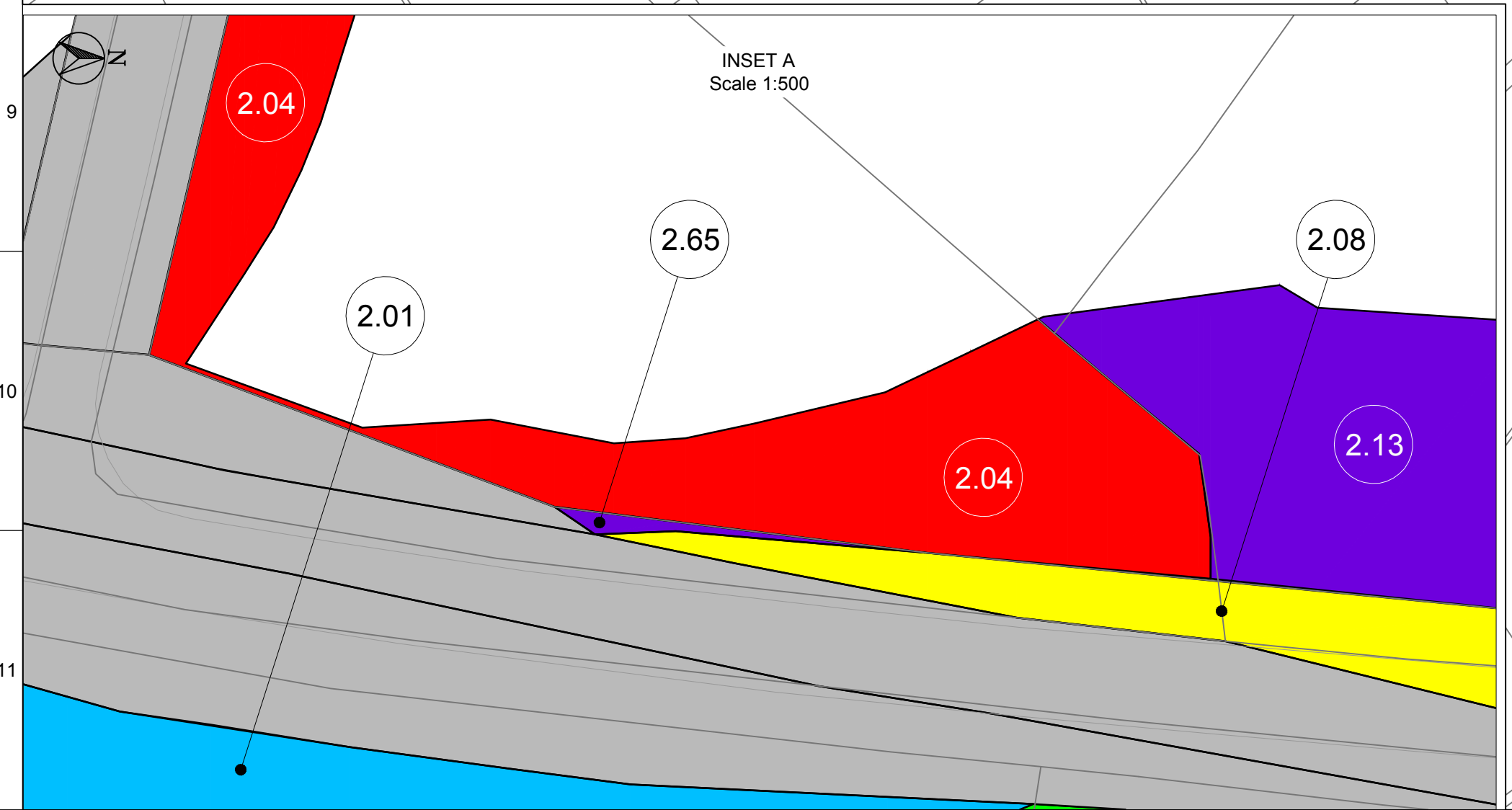
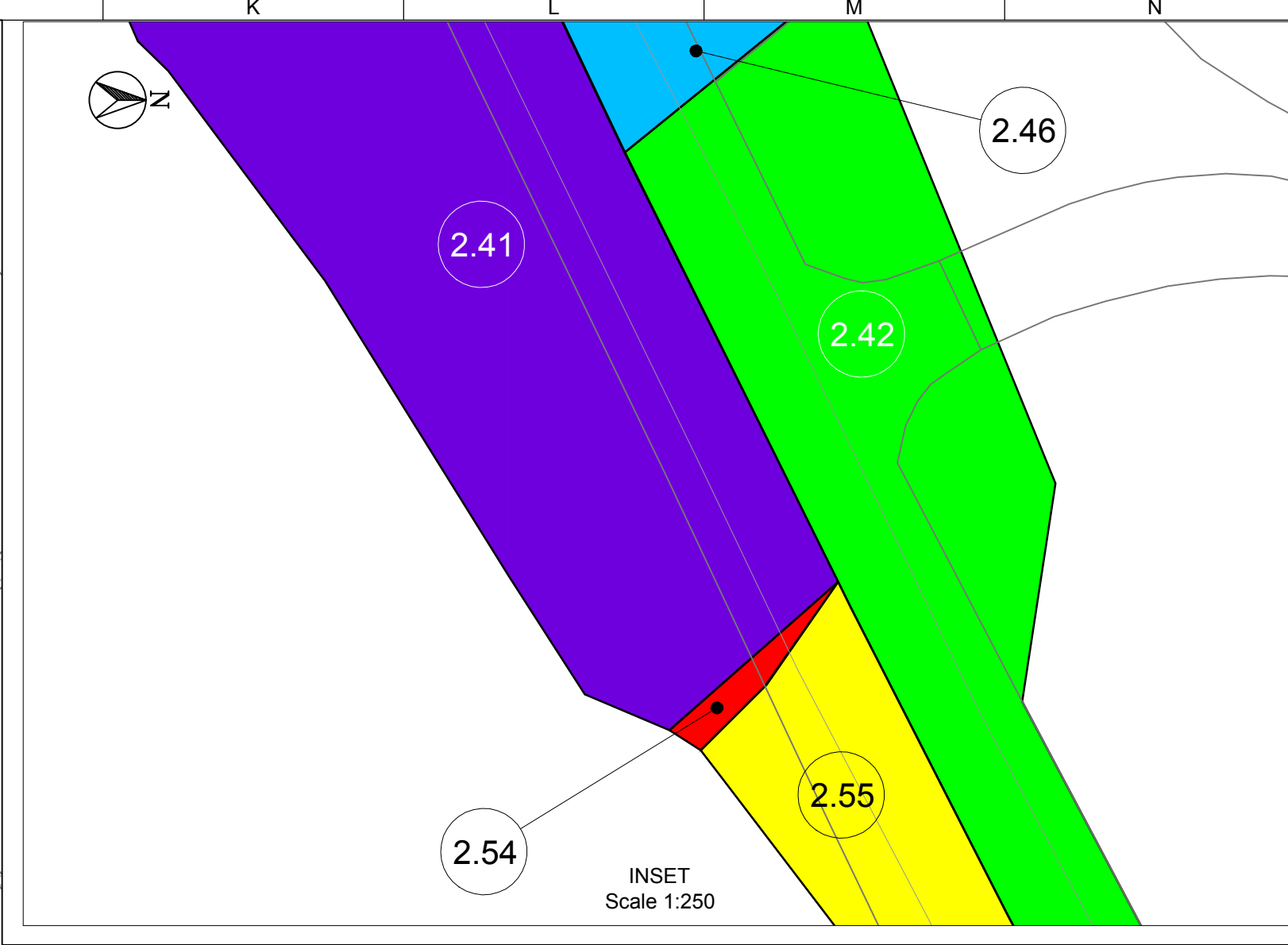
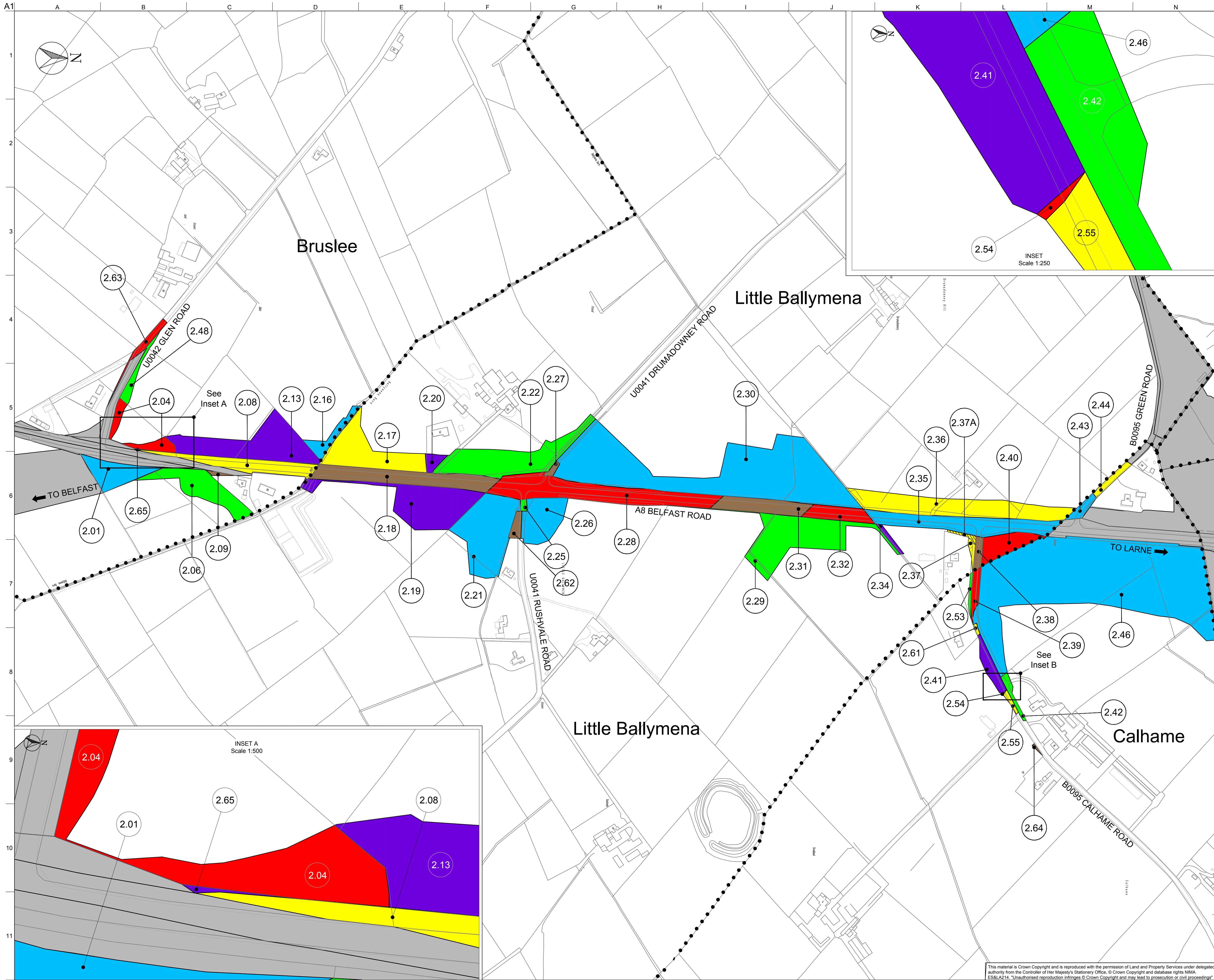

F4	06/12/11	MD	CE	JMcG
Final Vesting Order				
F3	10/11/10	CE	JMcG	CF
Plots Amended				
F2	20/10/10	MD	JMcG	CF
Plots Amended				
F1	10/09/10	MD	JMcG	CF
First Issue				
Issue	Date	By	Chkd	Appd

ARUP
 The Linerhall, 8th Floor, 32-38 Linerhall Street,
 Belfast, BT2 8BG
 Tel: +44(0)28 9089 0900 Fax: +44(0)28 9089 0901
 www.arup.com



Client
Northern Division
 Job Title
**A8 Belfast to Larne
 Dual Carriageway
 (Coleman's Corner to
 Ballyrickard Road)**

Drawing Title
**Land Plan
 Sheet 2 of 10**

Scale at A1
 1:2500

Discipline
 Highways

Drawing Status
Final

Job No	Drawing No	Issue
124785-00	A8_S3_4002	F4

This material is Crown Copyright and is reproduced with the permission of Land and Property Services under delegated authority from the Controller of Her Majesty's Stationery Office. © Crown Copyright and database rights NIMA ES&LA214. Unauthorised reproduction infringes © Crown Copyright and may lead to prosecution or civil proceedings

J:\124785-004 Internal Project Data\3D Drawings\4.31 Issue Drawings_Shape 34000 Series - Land Plans\A8_S3_4002_F4.dwg 25 Jan 2012 10:45:43

MAP 3

ORDNANCE SURVEY SHEET Nos. 097-04-NW, 097-04-NE, 097-04-SW, 097-04-SE, 098-01-NW, 098-01-SW

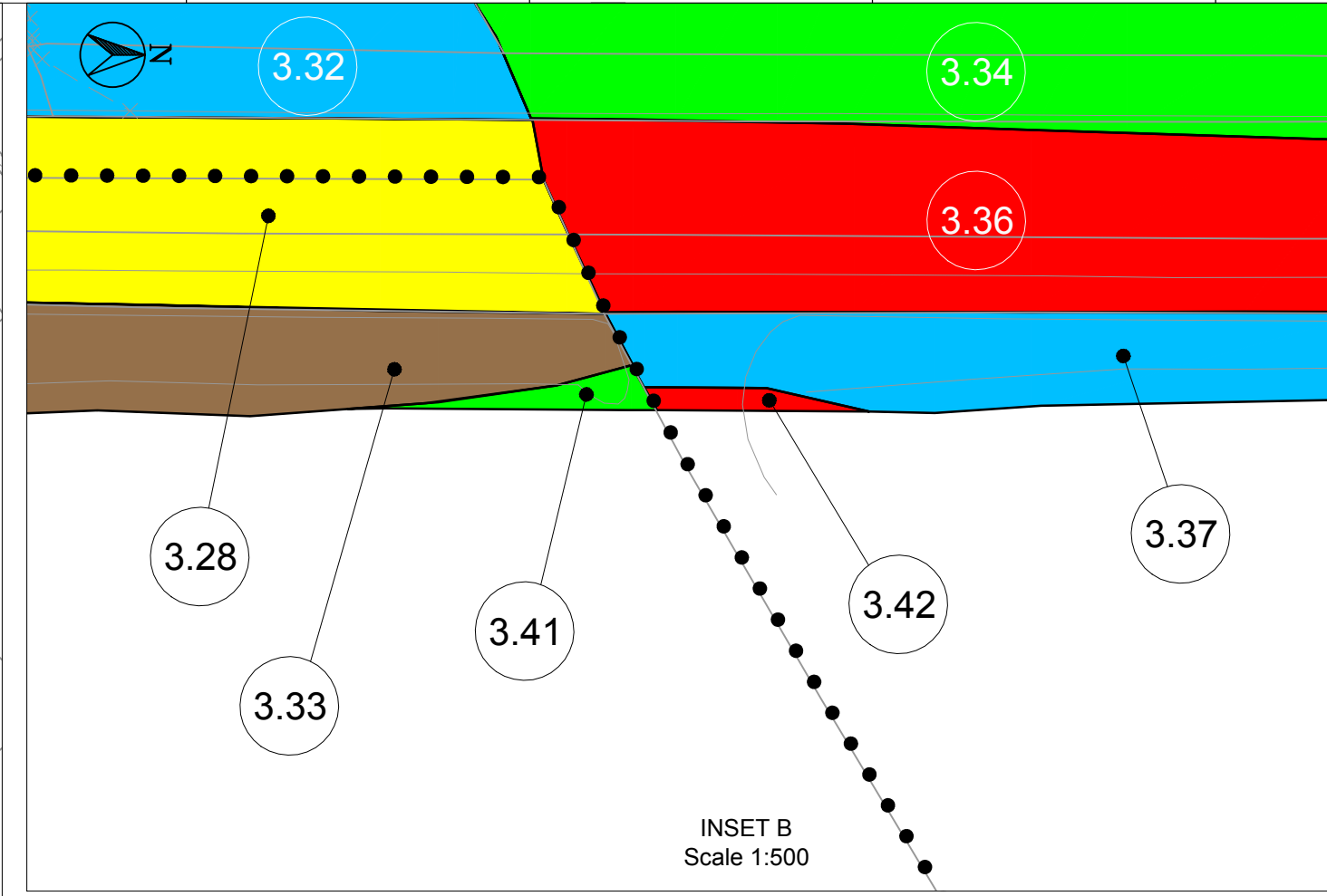
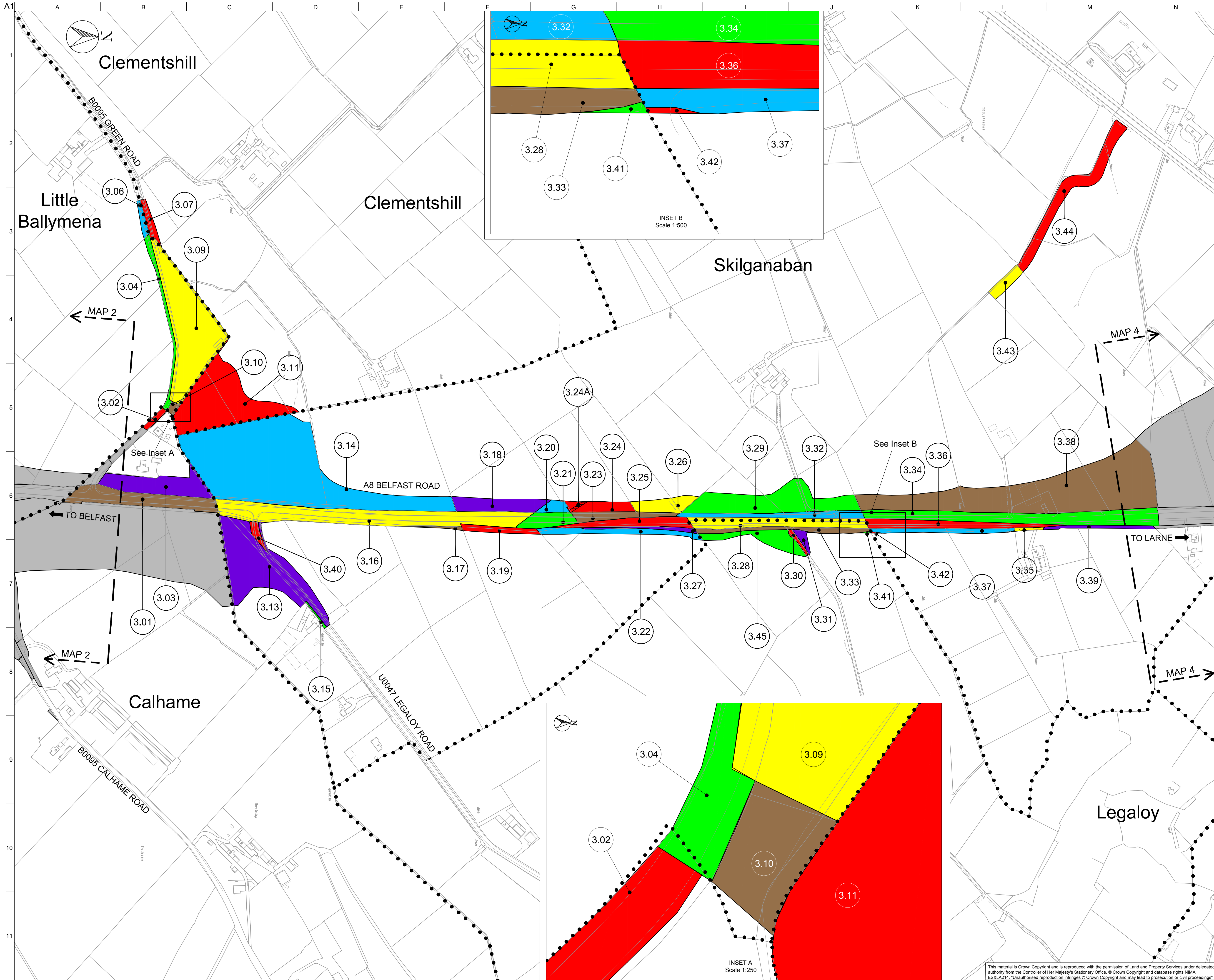

F4	06/12/11	MD	CE	JMcG
Final Vesting Order				
F3	06/01/11	CE	JMcG	CF
Inset annotation added				
F2	12/11/10	CE	JMcG	CF
Annotation amended				
F1	10/09/10	MD	JMcG	CF
First Issue				
Issue	Date	By	Chkd	Appd

ARUP
 The Linenhall, 8th Floor, 32-38 Linenhall Street,
 Belfast, BT2 8BG
 Tel: +44(0)28 9089 0900 Fax: +44(0)28 9089 0901
 www.arup.com



Client
Northern Division
 Job Title
A8 Belfast to Larne Dual Carriageway (Coleman's Corner to Ballyrickard Road)
 Drawing Title
Land Plan Sheet 3 of 10

Scale at A1: 1:2500
 Discipline: Highways
 Drawing Status: **Final**
 Job No: **124785-00** Drawing No: **A8_S3_4003** Issue: **F4**

This material is Crown Copyright and is reproduced with the permission of Land and Property Services under delegated authority from the Controller of Her Majesty's Stationery Office. © Crown Copyright and database rights NIMA ESSI/A214. Unauthorised reproduction infringes © Crown Copyright and may lead to prosecution or civil proceedings

MAP 4

ORDNANCE SURVEY SHEET Nos. 097-04-NW, 097-04-NE, 082-16-SW, 082-16-SE, 082-16-NW, 082-16-NE

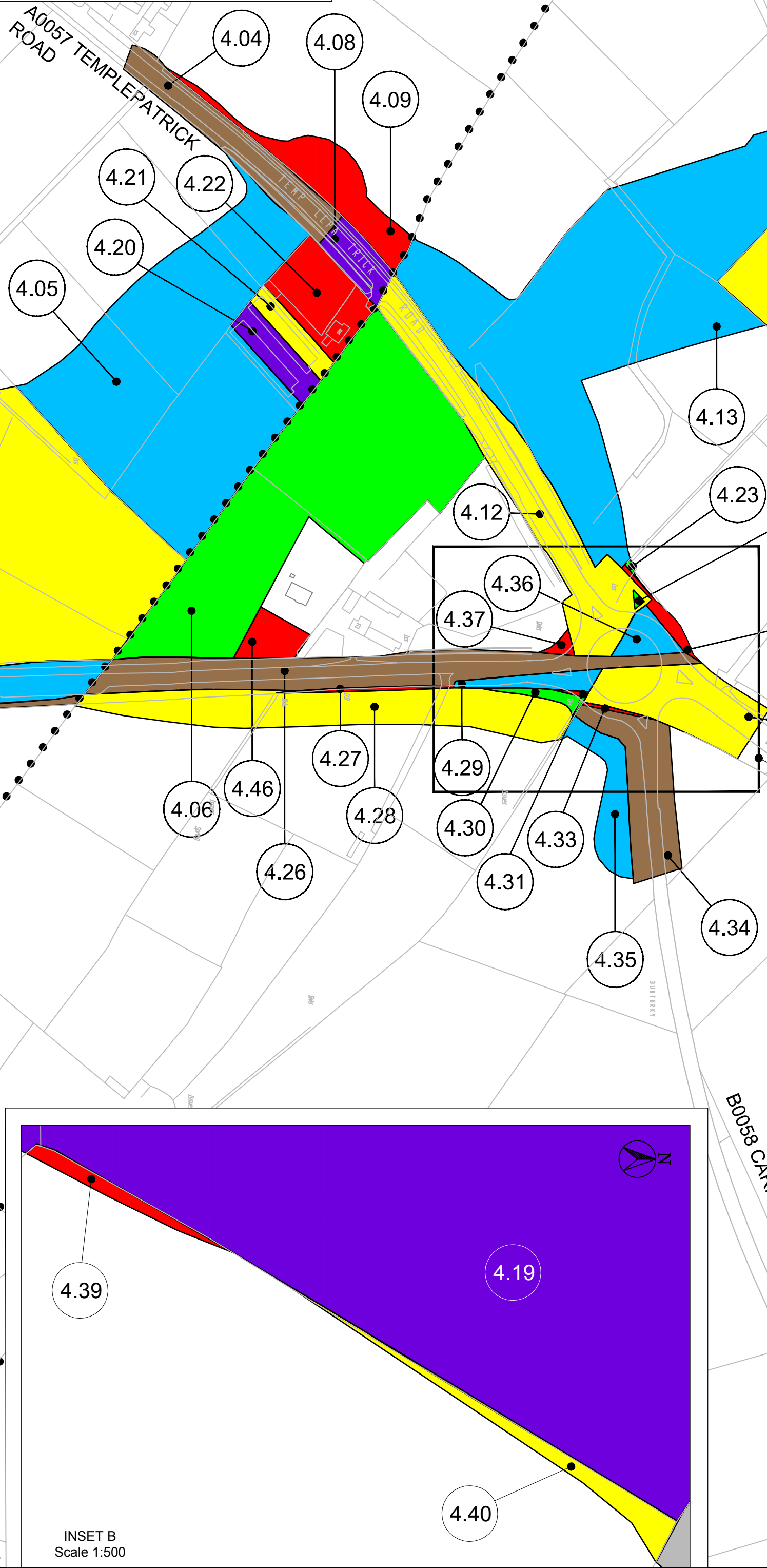
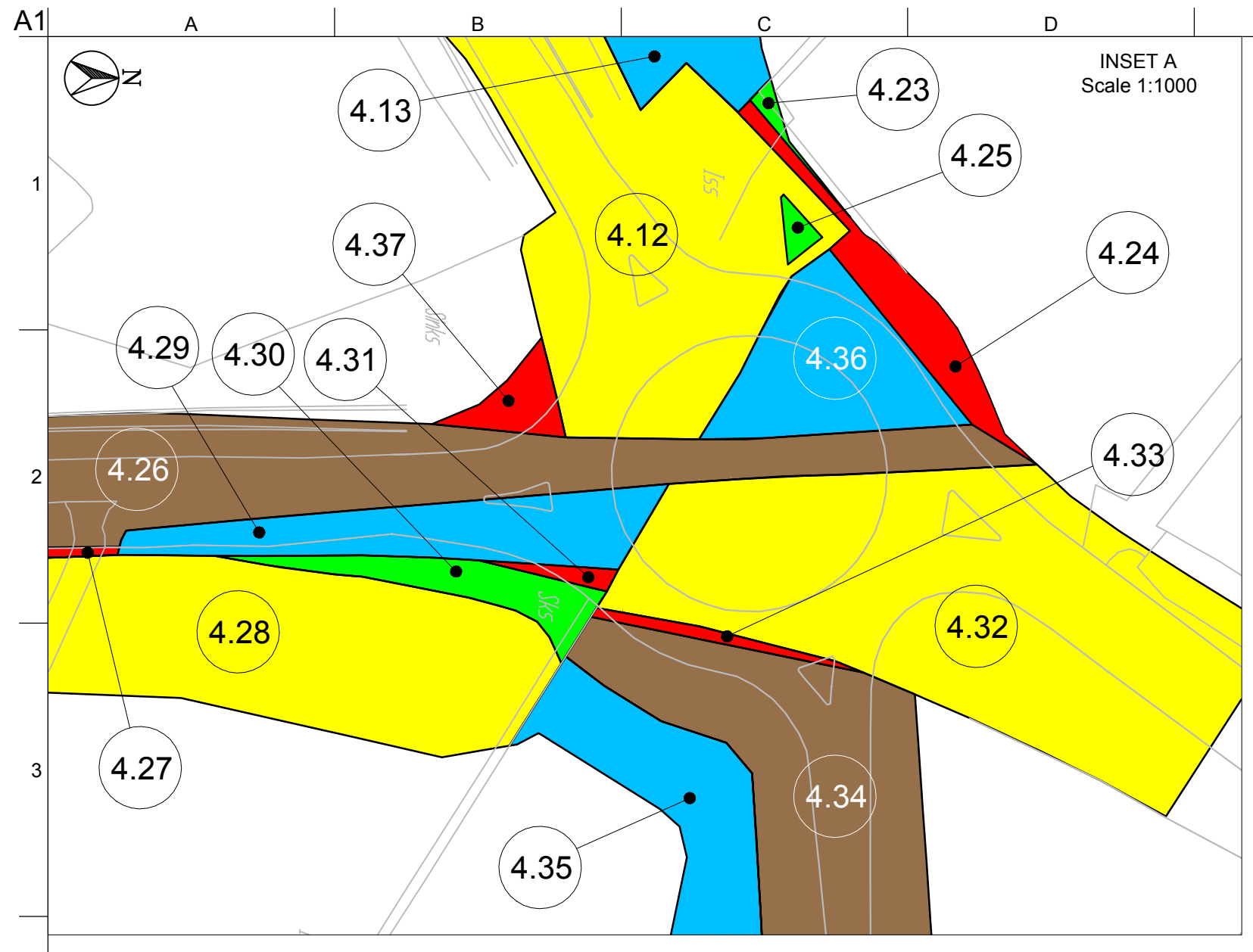
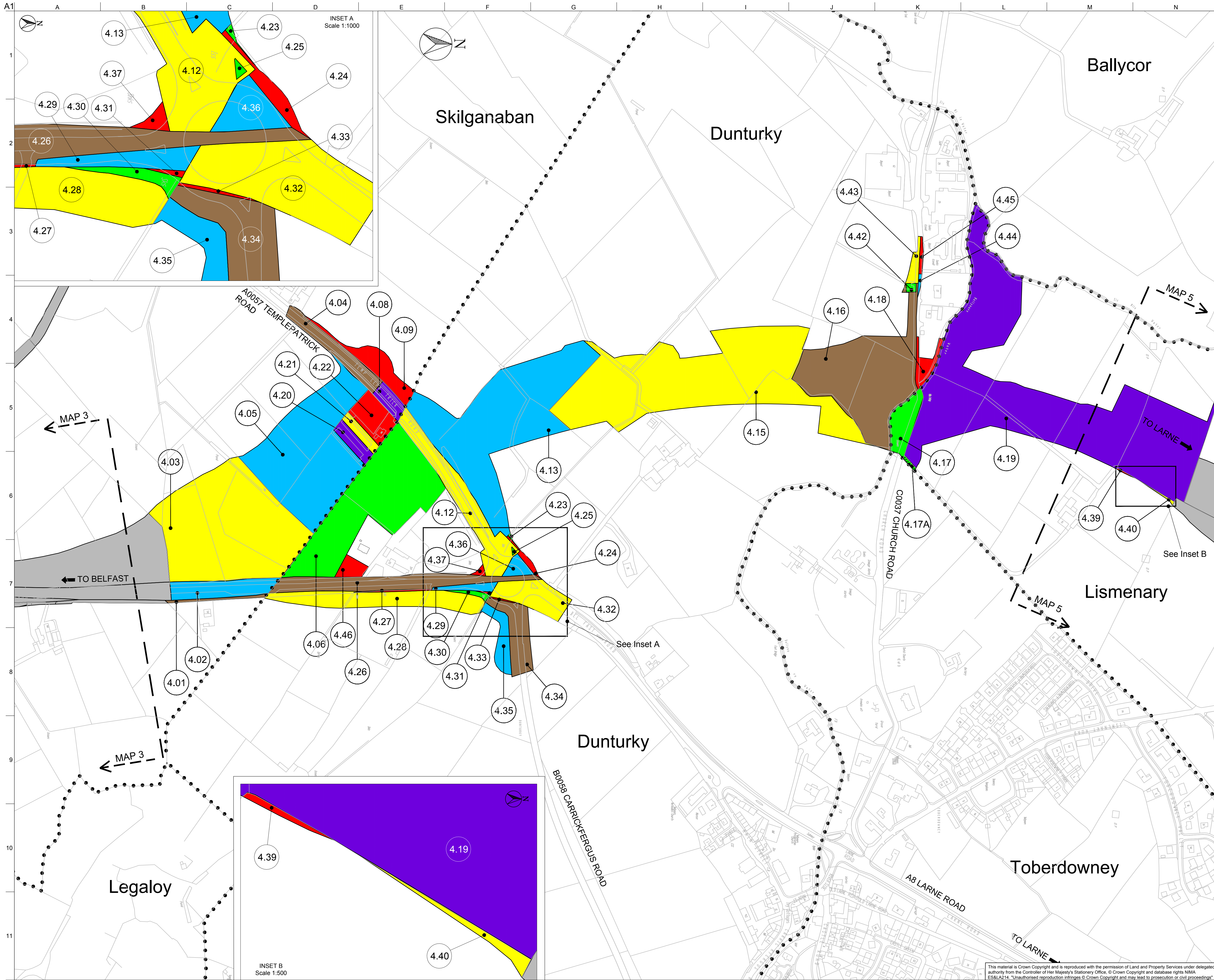

F6	09/03/12	MD	CE	JMcG
Minor Revisions				
F5	06/12/11	MD	CE	JMcG
Final Vesting Order				
F4	06/01/11	CE	JMcG	CF
Inset annotation added				
F3	14/12/10	CE	JMcG	CF
Plot Boundary Adjusted				
F2	08/12/10	MD	JMcG	CF
Plots Added				
F1	10/09/10	MD	JMcG	CF
First Issue				
Issue	Date	By	Chkd	Appd

ARUP
 The Linerhall, 8th Floor, 32-38 Linerhall Street,
 Belfast, BT2 8BG
 Tel: +44(0)28 9089 0900 Fax: +44(0)28 9089 0901
 www.arup.com



Client
 Northern Division
 Job Title
 A8 Belfast to Larne
 Dual Carriageway
 (Coleman's Corner to
 Ballyrickard Road)

Drawing Title
 Land Plan
 Sheet 4 of 10

Scale at A1 1:2500
 Discipline Highways
 Drawing Status
Final
 Job No 124785-00 Drawing No A8_S3_4004 Issue F6

This material is Crown Copyright and is reproduced with the permission of Land and Property Services under delegated authority from the Controller of Her Majesty's Stationery Office. © Crown Copyright and database rights NIMA ES&LA214. Unauthorised reproduction infringes © Crown Copyright and may lead to prosecution or civil proceedings.

MAP 5

ORDNANCE SURVEY SHEET Nos. 082-16-SE, 082-16-NE, 082-12-SE, 082-12-SW, 082-16-NW, 083-13-NW, 083-09-SW, 083-09-NW

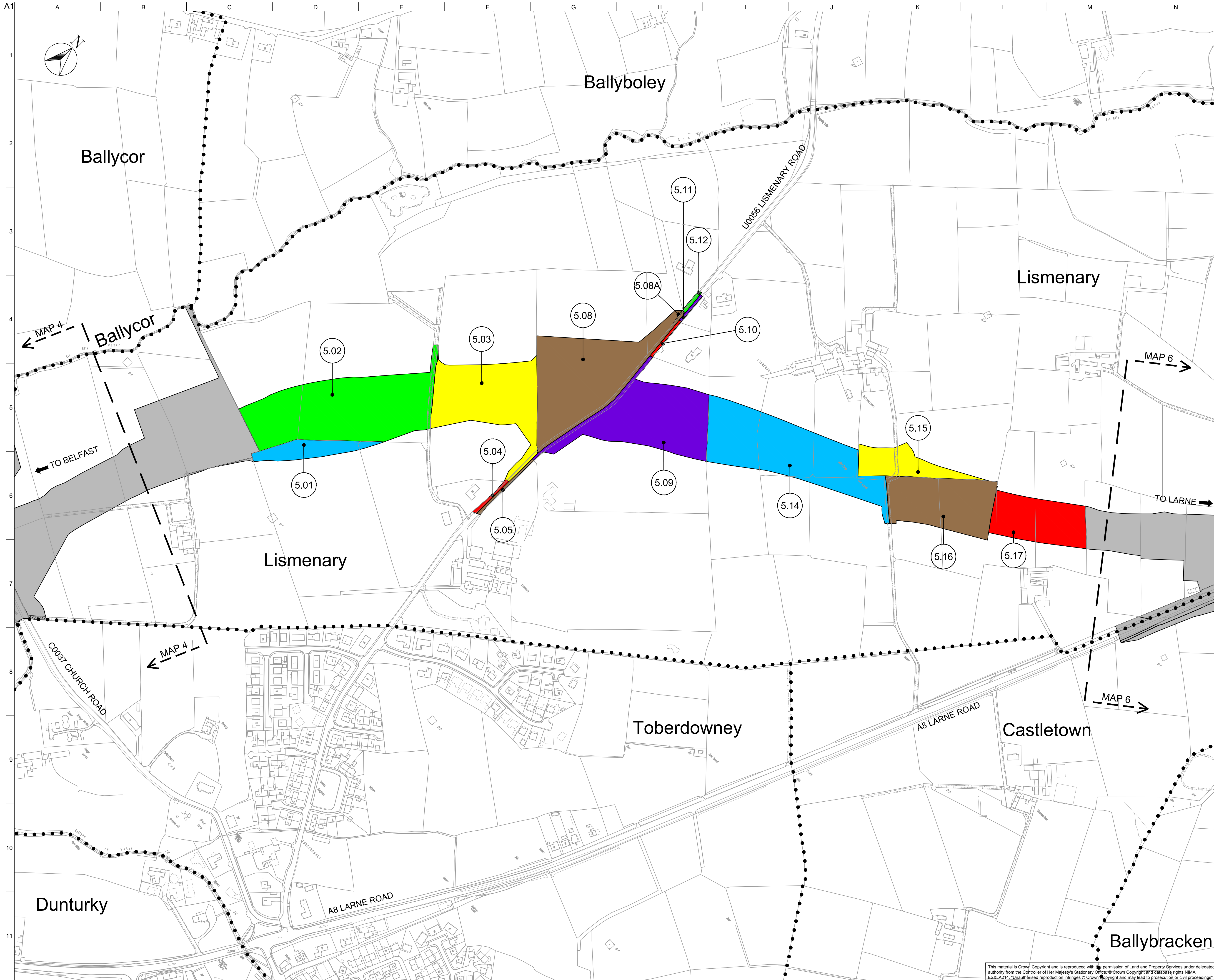

F2	06/12/11	MD	CE	JMcG
Final Vesting Order				
F1	10/09/10	MD	JMcG	CF
First Issue				
Issue	Date	By	Chkd	Appd

ARUP
 The Linerhall, 8th Floor, 32-38 Linerhall Street,
 Belfast, BT2 8BG
 Tel: +44(0)28 9089 0900 Fax: +44(0)28 9089 0901
 www.arup.com



Client
Northern Division
 Job Title
**A8 Belfast to Larne
 Dual Carriageway
 (Coleman's Corner to
 Ballyrickard Road)**
 Drawing Title
**Land Plan
 Sheet 5 of 10**

Scale at A1 1:2500
 Discipline Highways
 Drawing Status
Final
 Job No 124785-00 Drawing No A8_S3_4005 Issue F2

This material is Crown Copyright and is reproduced with the permission of Land and Property Services under delegated authority from the Controller of Her Majesty's Stationery Office. © Crown Copyright and database rights NIMA ES&A214. Unauthorised reproduction infringes © Crown copyright and may lead to prosecution or civil proceedings.

ORDNANCE SURVEY SHEET Nos. 083-13-NW, 083-09-SW, 083-09-SE, 083-09-NW, 083-09-NE, 083-05-SW, 083-05-SE, 082-12-NE, 082-12-SE

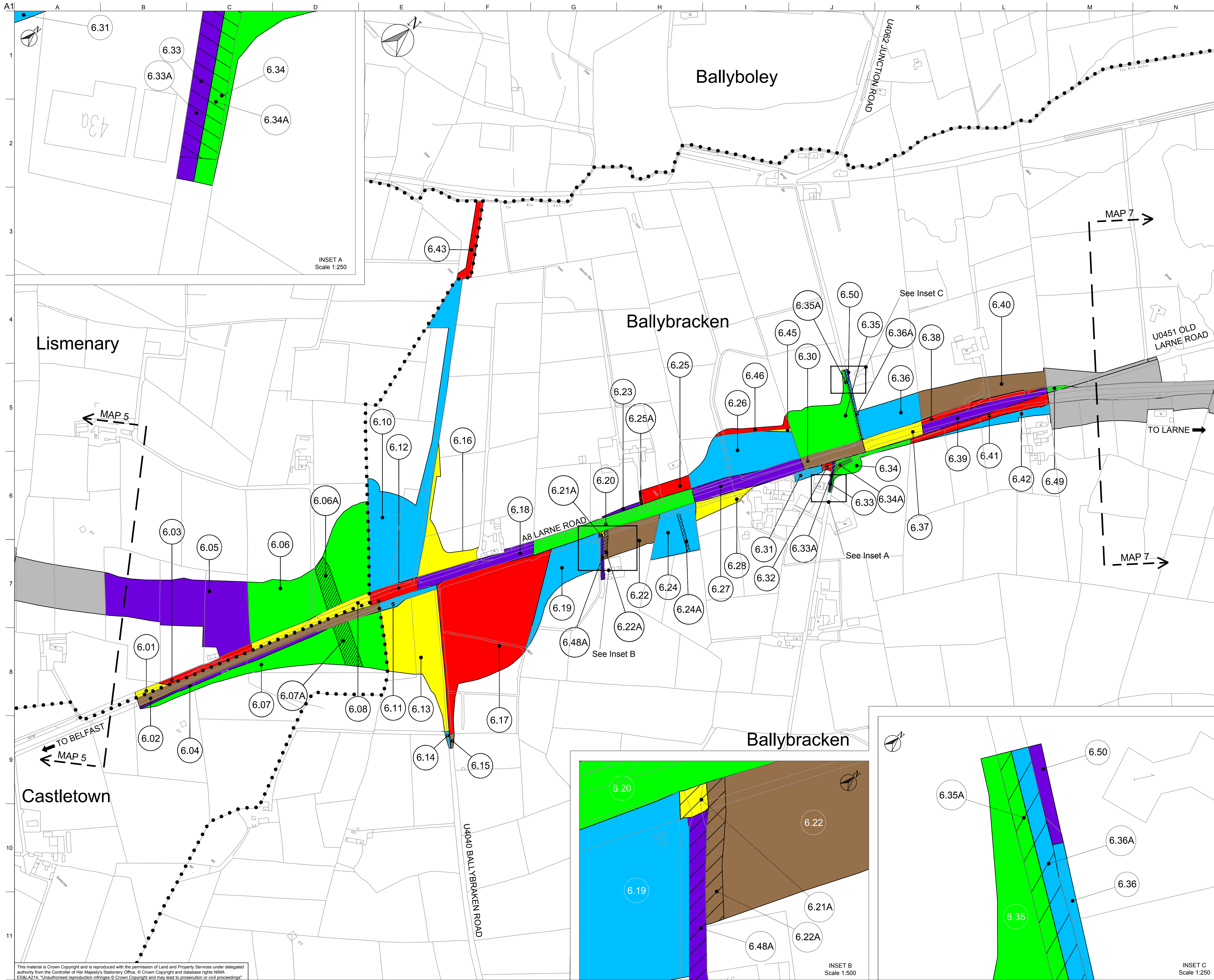

INSET A
Scale 1:250

INSET B
Scale 1:500

INSET C
Scale 1:250

F8	06/12/11	MD	CE	JMcG
Final Vesting Order				
F7	06/01/11	CE	JMcG	CF
Inset annotation added				
F6	07/12/10	CE	JMcG	CF
Boundary amendment				
F5	01/12/10	CE	JMcG	CF
Plot added				
F4	29/11/10	CE	JMcG	CF
Plots amended				
F3	11/10/10	MD	JMcG	CF
Plots amended				
F2	16/09/10	MD	JMcG	CF
Boundary amendments				
F1	10/09/10	MD	JMcG	CF
First Issue				
Issue	Date	By	Chkd	Appd

ARUP

The Linerhall, 8th Floor, 32-38 Linerhall Street, Belfast, BT2 8BG
Tel: +44(0)28 9089 0900 Fax: +44(0)28 9089 0901
www.arup.com



Northern Division
Job Title
A8 Belfast to Larne Dual Carriageway (Coleman's Corner to Ballyrickard Road)

Drawing Title
Land Plan Sheet 6 of 10

Scale at A1: 1:2500
Discipline: Highways
Drawing Status: **Final**
Job No: **124785-00** Drawing No: **A8_S3_4006** Issue: **F8**

This material is Crown Copyright and is reproduced with the permission of Land and Property Services under delegated authority from the Controller of Her Majesty's Stationery Office, © Crown Copyright and database rights NIMA ES&LA214. Unauthorised reproduction infringes © Crown Copyright and may lead to prosecution or civil proceedings.
Do not scale

J:\124785-00\Internal Project Data\A30 Drawings\F8 Issue Drawings_Shape 34000 Series - Land Plans\A8_S3_4006_F8.dwg 26 Jan 2012 09:35:56

MAP 7

ORDNANCE SURVEY SHEET Nos. 083-09-NW, 083-09-NE, 083-05-NW, 083-05-NE, 083-05-SW, 083-05-SE, 083-06-NW, 083-06-SW, 083-01-SE

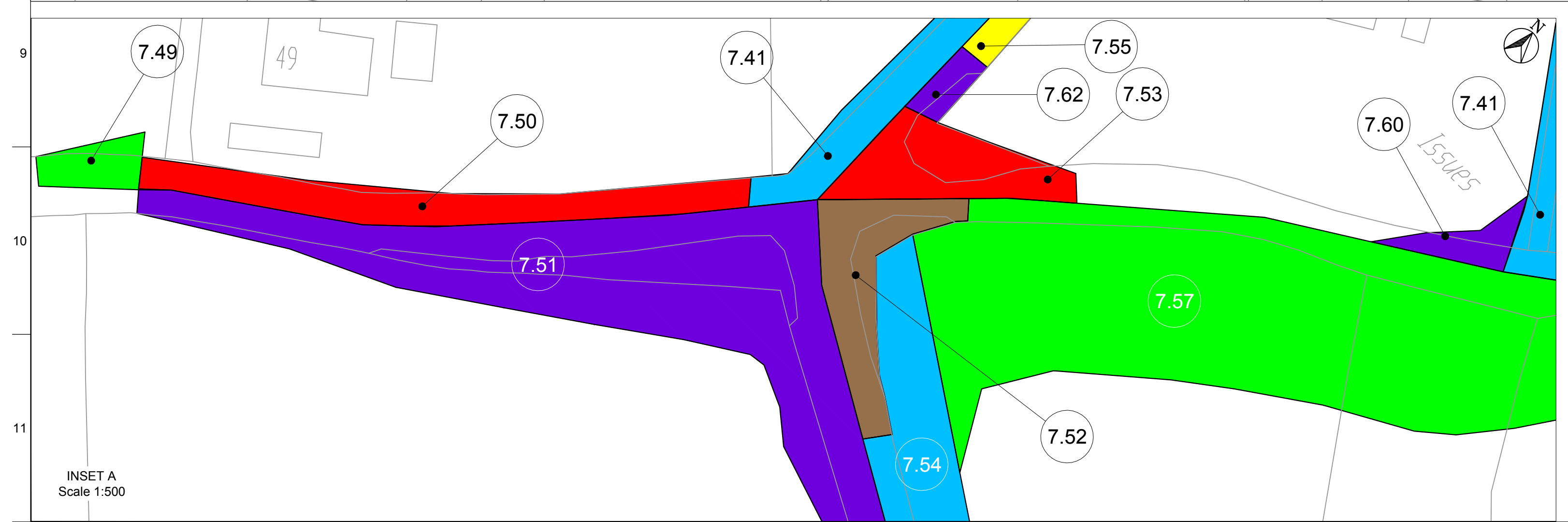
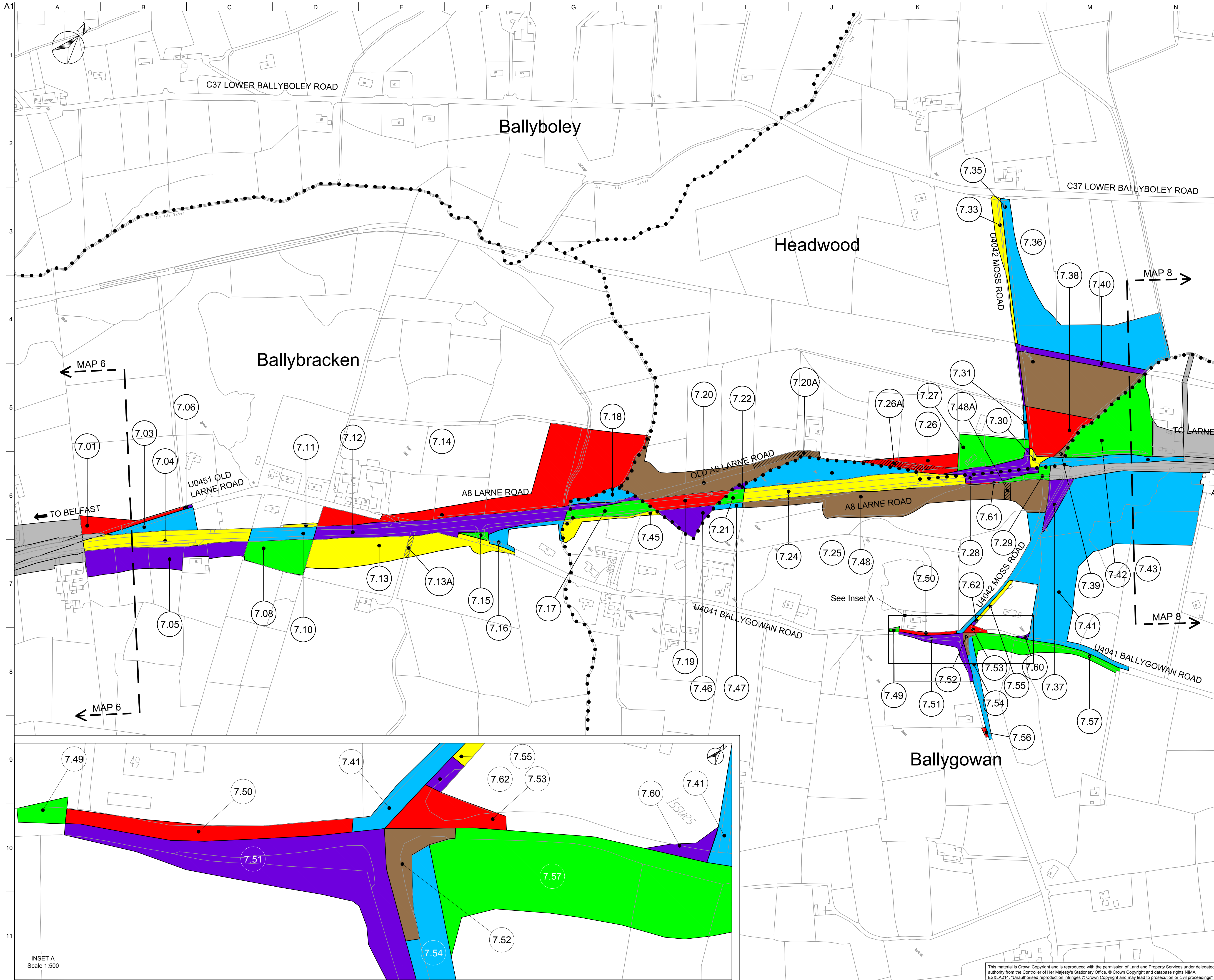

F5	06/12/11	MD	CE	JMcG
Final Vesting Order				
F4	29/11/10	CE	JMcG	CF
Plots amended				
F3	11/10/10	MD	JMcG	CF
Plots amended				
F2	15/09/10	MD	JMcG	CF
Boundary amendment				
F1	10/09/10	MD	JMcG	CF
First Issue				
Issue	Date	By	Chkd	Appd

ARUP
 The Linerhall, 8th Floor, 32-38 Linerhall Street,
 Belfast, BT2 8BG
 Tel: +44(0)28 9089 0900 Fax: +44(0)28 9089 0901
 www.arup.com



Client
Northern Division
 Job Title
**A8 Belfast to Larne
 Dual Carriageway
 (Coleman's Corner to
 Ballyrickard Road)**

Drawing Title
**Land Plan
 Sheet 7 of 10**

Scale at A1: 1:2500

Discipline: Highways

Drawing Status: **Final**

Job No	Drawing No	Issue
124785-00	A8_S3_4007	F5

This material is Crown Copyright and is reproduced with the permission of Land and Property Services under delegated authority from the Controller of Her Majesty's Stationery Office. © Crown Copyright and database rights NIMA ES&LA214. Unauthorised reproduction infringes © Crown Copyright and may lead to prosecution or civil proceedings.

MAP 8

ORDNANCE SURVEY SHEET Nos. 083-05-NE, 083-05-SE, 083-06-NW, 083-06-SW, 083-01-NE, 083-01-SE, 083-02-NW, 083-02-SW

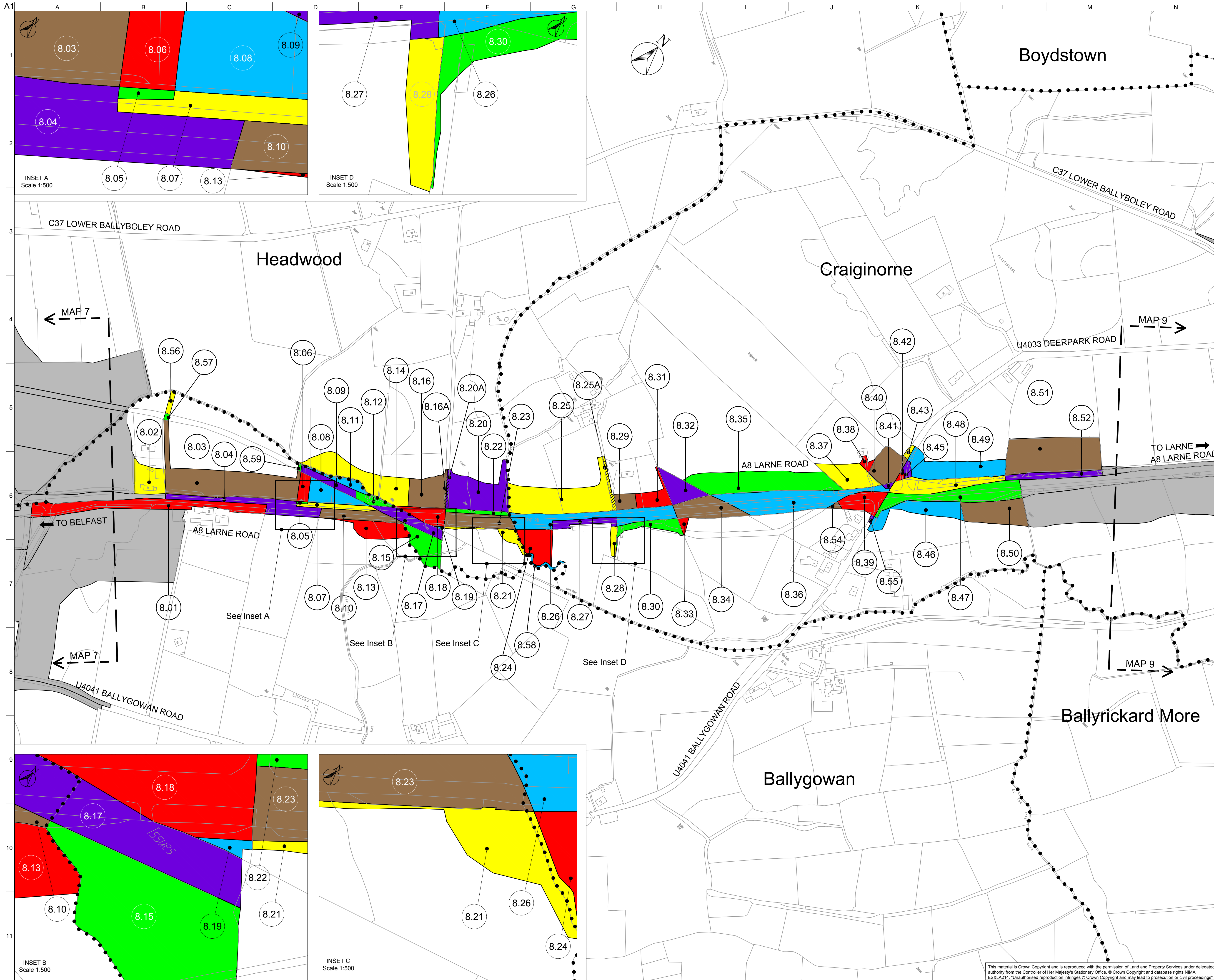

INSET A Scale 1:500

INSET D Scale 1:500

INSET B Scale 1:500

INSET C Scale 1:500

F6	06/12/11	MD	CE	JMcG
Final Vesting Order				
F5	06/01/11	CE	JMcG	CF
Inset annotation added				
F4	29/11/10	CE	JMcG	CF
Inset added				
F3	13/10/10	MD	JMcG	CF
Inset added				
F2	15/09/10	MD	JMcG	CF
Boundary amendment				
F1	10/09/10	MD	JMcG	CF
First Issue				
Issue	Date	By	Chkd	Appd

ARUP
 The Linerhall, 8th Floor, 32-38 Linerhall Street,
 Belfast, BT2 8BG
 Tel: +44(0)28 9089 0900 Fax: +44(0)28 9089 0901
 www.arup.com



Northern Division
 Job Title
**A8 Belfast to Larne
 Dual Carriageway
 (Coleman's Corner to
 Ballyrickard Road)**

Land Plan
 Sheet 8 of 10

Scale at A1 1:2500

Discipline Highways

Drawing Status

Final

Job No 124785-00 Drawing No A8_S3_4008 Issue F6

This material is Crown Copyright and is reproduced with the permission of Land and Property Services under delegated authority from the Controller of Her Majesty's Stationery Office. © Crown Copyright and database rights NIMA ES&LA214. Unauthorised reproduction infringes © Crown Copyright and may lead to prosecution or civil proceedings

J:\124001\124785-004 Internal Project Data\130 Drawings\31 Issue Drawings_Shape 34000 Series - Land Plans\A8_S3_4008_F6.dwg 16 Feb 2012 12:50:02

MAP 9

ORDNANCE SURVEY SHEET Nos. 083-02-NW, 083-02-SW, 083-02-NE, 083-02-SE, 083-01-NE, 070-14-SE, 070-14-SW

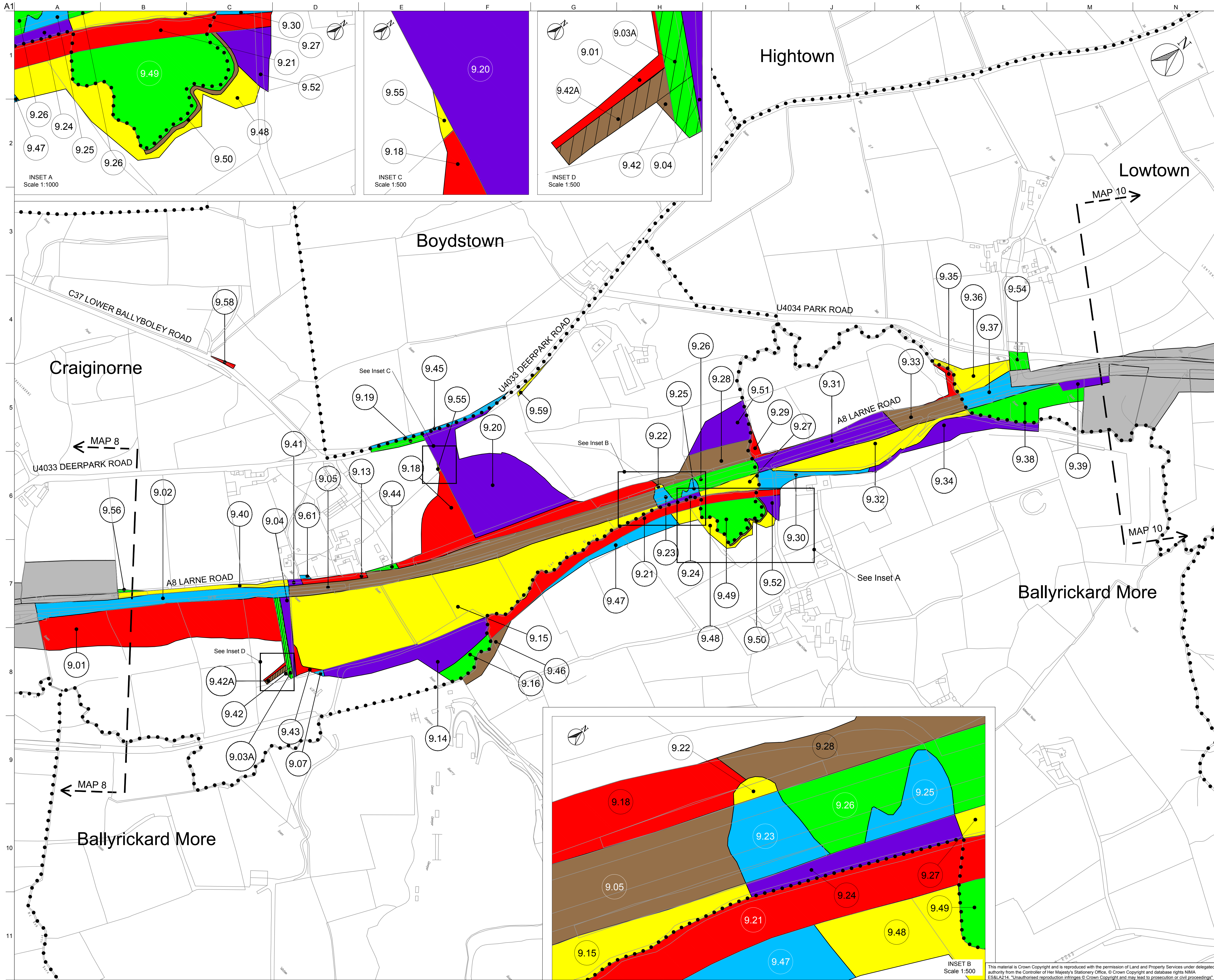

INSET A
Scale 1:1000

INSET C
Scale 1:500

INSET D
Scale 1:500

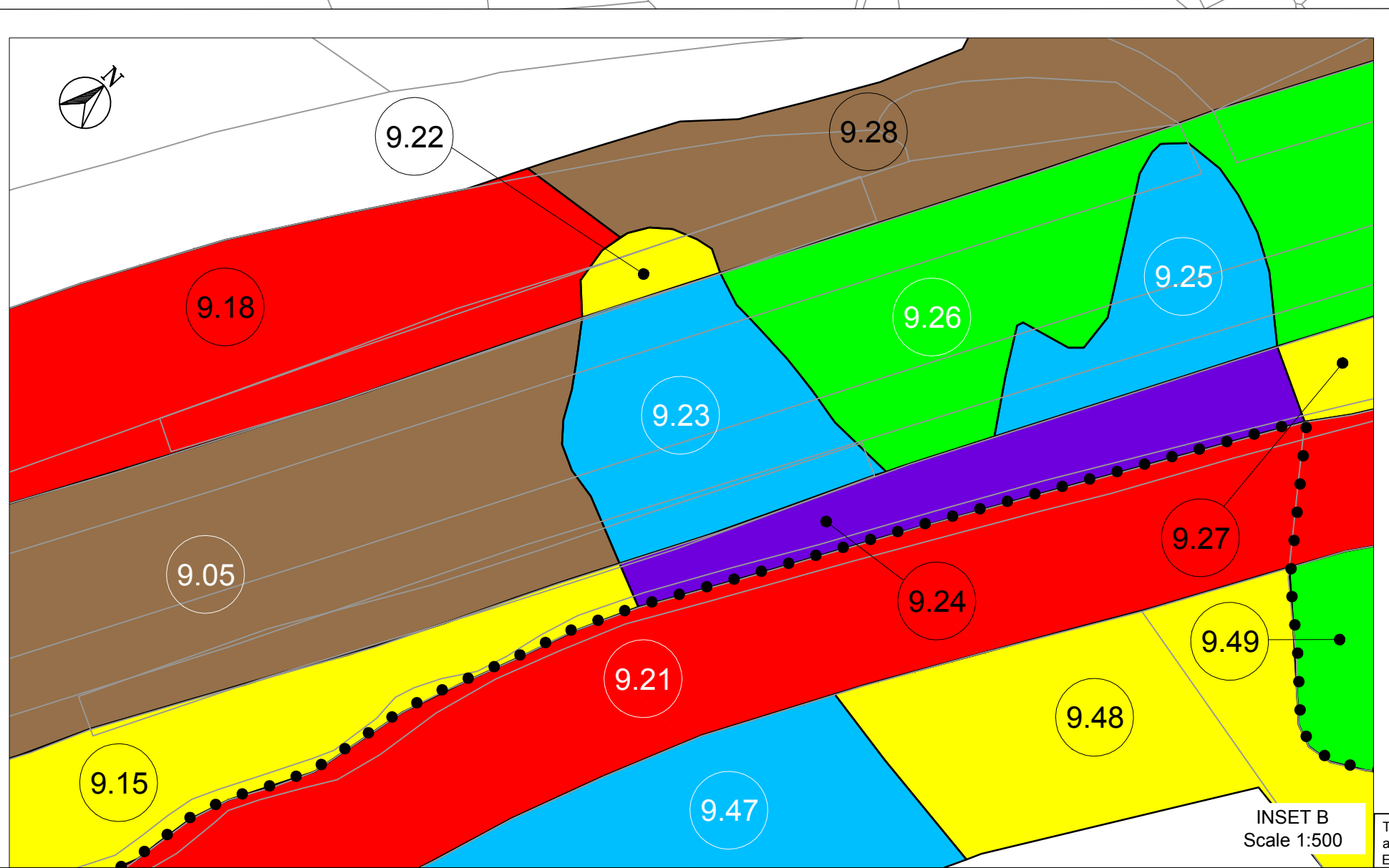

INSET B
Scale 1:500

F7	06/12/11	MD	CE	JMcG
Final Vesting Order				
F6	06/01/11	CE	JMcG	CF
Inset annotation added				
F5	29/11/10	CE	JMcG	CF
Inset added				
F4	29/10/10	CE	JMcG	CF
Annotation removed				
F3	11/10/10	MD	JMcG	CF
Plot amendment				
F2	15/09/10	MD	JMcG	CF
Boundary amendment				
F1	10/09/10	MD	JMcG	CF
First issue				
Issue	Date	By	Chkd	Appd

ARUP

The Linerhall, 8th Floor, 32-38 Linerhall Street,
Belfast, BT2 8BG
Tel: +44(0)28 9089 0900 Fax: +44(0)28 9089 0901
www.arup.com



Northern Division
Job Title
**A8 Belfast to Larne
Dual Carriageway
(Coleman's Corner to
Ballyrickard Road)**

Drawing Title
**Land Plan
Sheet 9 of 10**

Scale at A1 1:2500

Discipline Highways

Drawing Status

Final

Job No	Drawing No	Issue
124785-00	A8_S3_4009	F7

This material is Crown Copyright and is reproduced with the permission of Land and Property Services under delegated authority from the Controller of Her Majesty's Stationery Office. © Crown Copyright and database rights NIMA ES&LA214. Unauthorised reproduction infringes © Crown Copyright and may lead to prosecution or civil proceedings

MAP 10

ORDNANCE SURVEY SHEET Nos. 070-14-NW, 070-14-NE, 070-14-SW, 070-14-SE, 083-02-NE, 070-10-SE, 070-15-NW, 070-15-SW

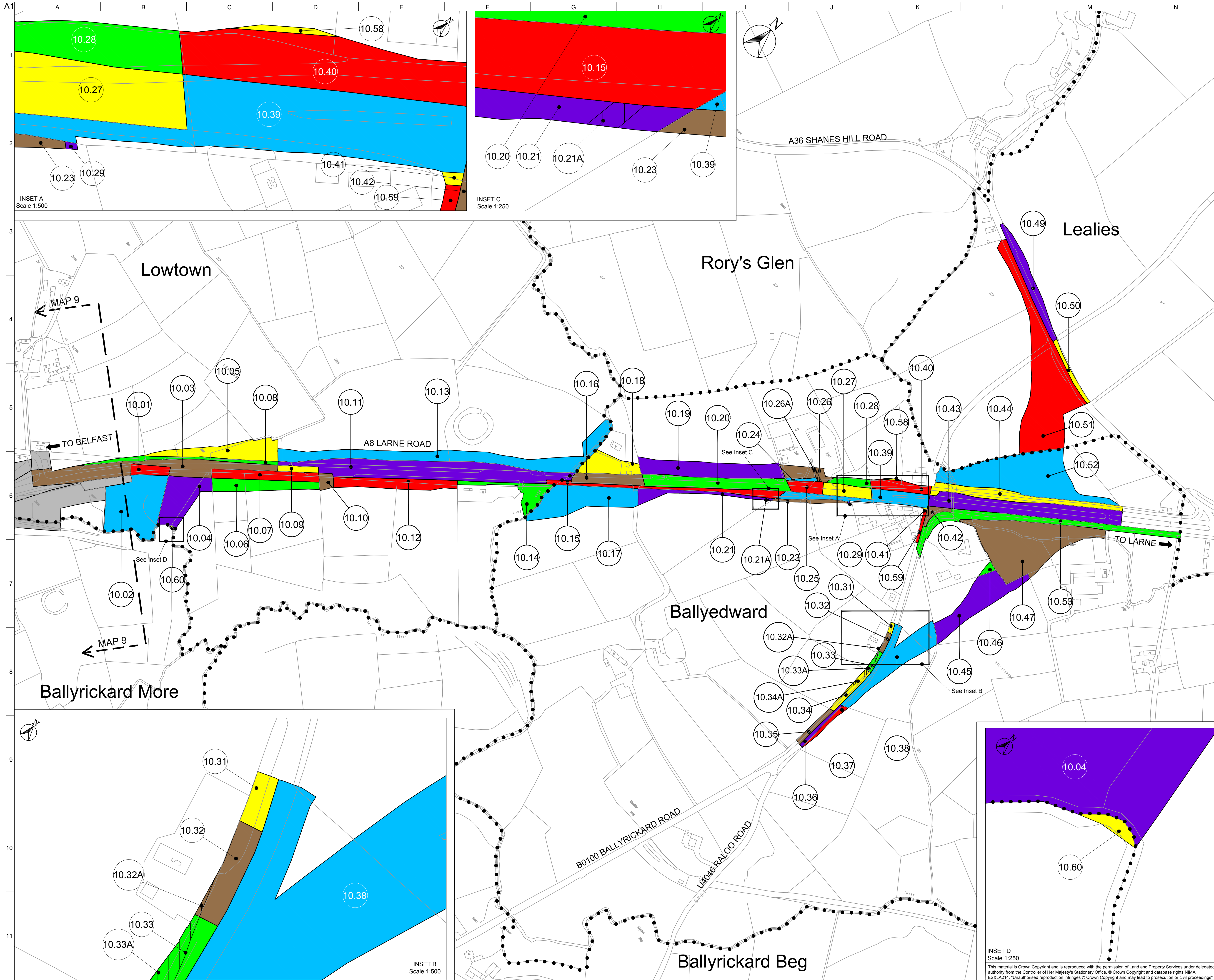

F7	06/12/11	MD	CE	JMcG
Final Vesting Order				
F6	06/01/11	CE	JMcG	CF
Inset annotation added				
F5	07/12/10	CE	JMcG	CF
Annotation added				
F4	29/11/10	CE	JMcG	CF
Plot amended				
F3	21/10/10	MD	JMcG	CF
Plot amended				
F2	11/10/10	MD	JMcG	CF
Insets added				
F1	10/09/10	MD	JMcG	CF
First Issue				
Issue	Date	By	Chkd	Appd

ARUP

The Linenhall, 8th Floor, 32-38 Linenhall Street, Belfast, BT2 8BG
 Tel: +44(0)28 9089 0900 Fax: +44(0)28 9089 0901
 www.arup.com



Client
Northern Division
 Job Title
A8 Belfast to Larne Dual Carriageway (Coleman's Corner to Ballyrickard Road)

Drawing Title
Land Plan Sheet 10 of 10

Scale at A1: 1:2500
 Discipline: Highways

Drawing Status
Final

Job No	Drawing No	Issue
124785-00	A8_S3_4010	F7