

THIS DRAWING MAY BE USED ONLY FOR THE PURPOSE INTENDED AND ONLY WRITTEN DIMENSIONS SHALL BE USED.

This material is based upon Crown Copyright and is reproduced with the permission of Land & Property Services under delegated authority from the Controller of Her Majesty's Stationery Office. © Crown copyright and database right. TMA (ES&A) 214. Unauthorised reproduction infringes © Crown copyright & may lead to prosecution or civil proceedings.

MAP 1

- Key:**
- TOWNLAND BOUNDARY
 - (X.XX) PLOT REFERENCE WITHIN SCHEDULE
 - - - - MATCHLINE
 - AREA VESTED FROM FOLIO

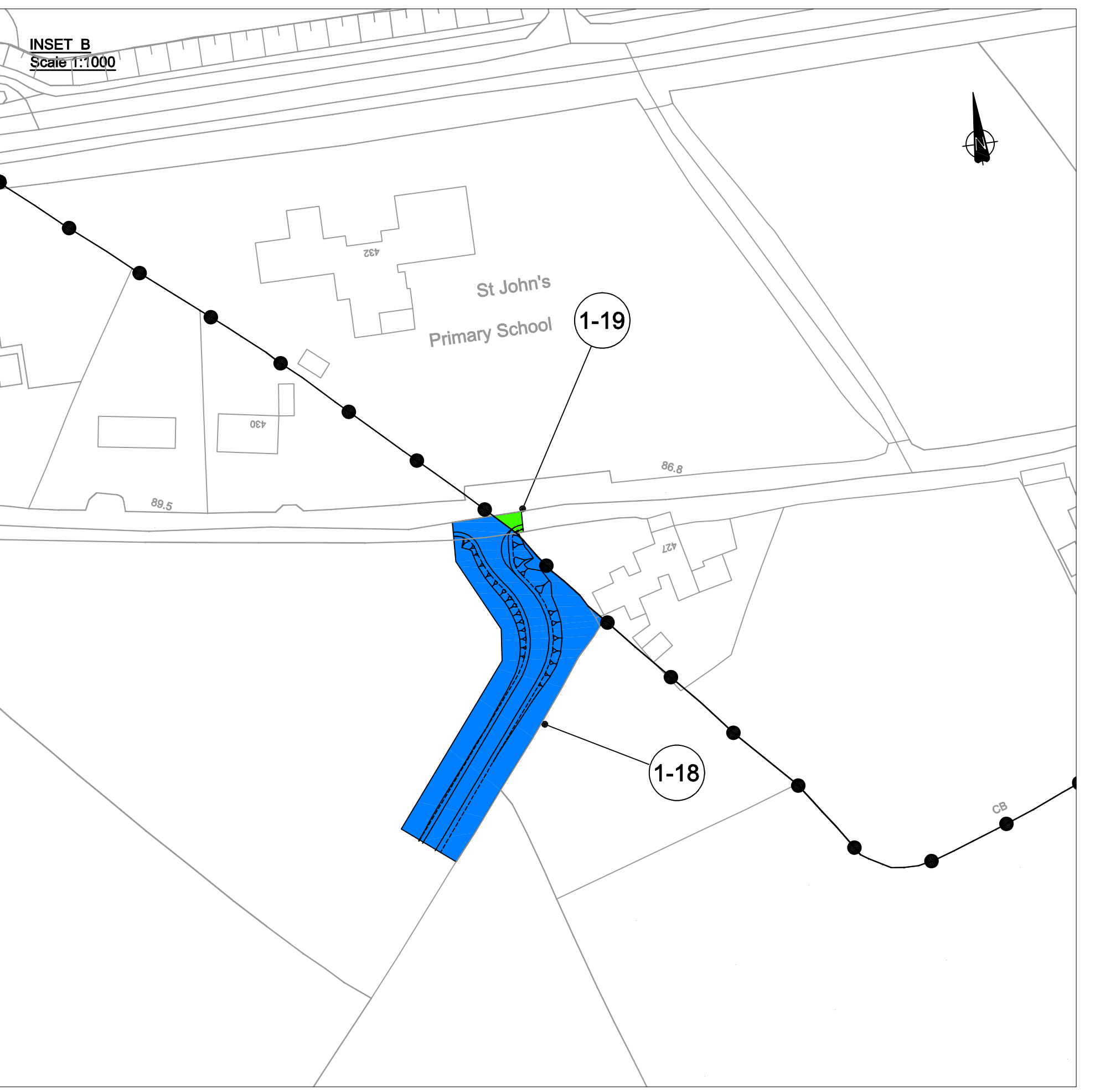
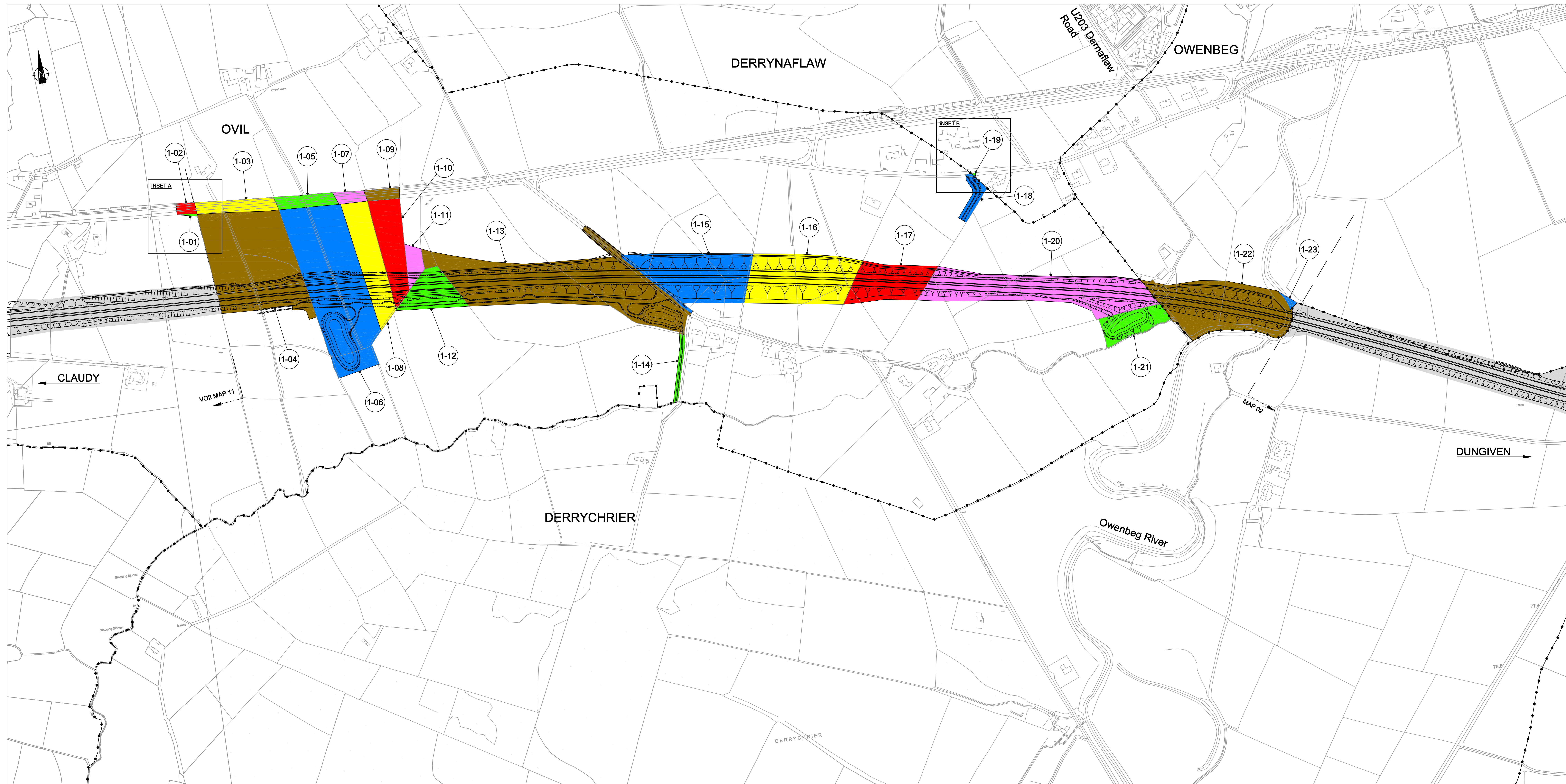

REVISED DRAWING TITLE	RM	09-11-11	B
FIRST ISSUE	JC	20-10-11	A
Revision Details	By	Date	Suffix
	Check		

DRAFT

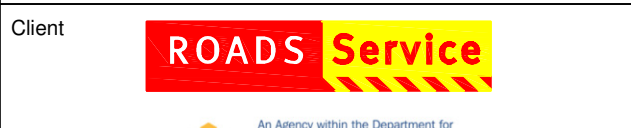

Co-financed by the European Union
 Trans-European Transport Network (TEN-T)
 THE SOLE RESPONSIBILITY OF THIS PUBLICATION LIES WITH THE AUTHOR. THE EUROPEAN UNION IS NOT RESPONSIBLE FOR ANY USE THAT MAY BE MADE OF THE INFORMATION CONTAINED THEREIN.

Job Title
 NORTH WESTERN KEY TRANSPORT CORRIDOR
 A6 LONDONDERRY TO DUNGIVEN DUALLING SCHEME

Drawing Title
 LAND PLAN SECTION 3
 DERRYCHRIER ROAD TO CREBARKEY ROAD
 MAP 1 OF 3

Scale at A0	1:2500, 1:1000	
Drawn	Checked	Approved
RM	JC	RG
Date	Date	Date
OCT 2011	OCT 2011	OCT 2011



Drawing Number: S106466 - VO(3) - 001 Rev: B

MAP 1

THIS DRAWING MAY BE USED ONLY FOR THE PURPOSE INTENDED AND ONLY WRITTEN DIMENSIONS SHALL BE USED.

This material is based upon Crown Copyright and is reproduced with the permission of Land & Property Services under delegated authority from the Controller of Her Majesty's Stationery Office. © Crown copyright and database right. TMA (E55) 2/11. Unauthorised reproduction infringes © Crown copyright and may lead to prosecution or civil proceedings.

MAP 2

- Key:**
- TOWNLAND BOUNDARY
 - (X.XX) PLOT REFERENCE WITHIN SCHEDULE
 - MATCHLINE
 - AREA VESTED FROM FOLIO

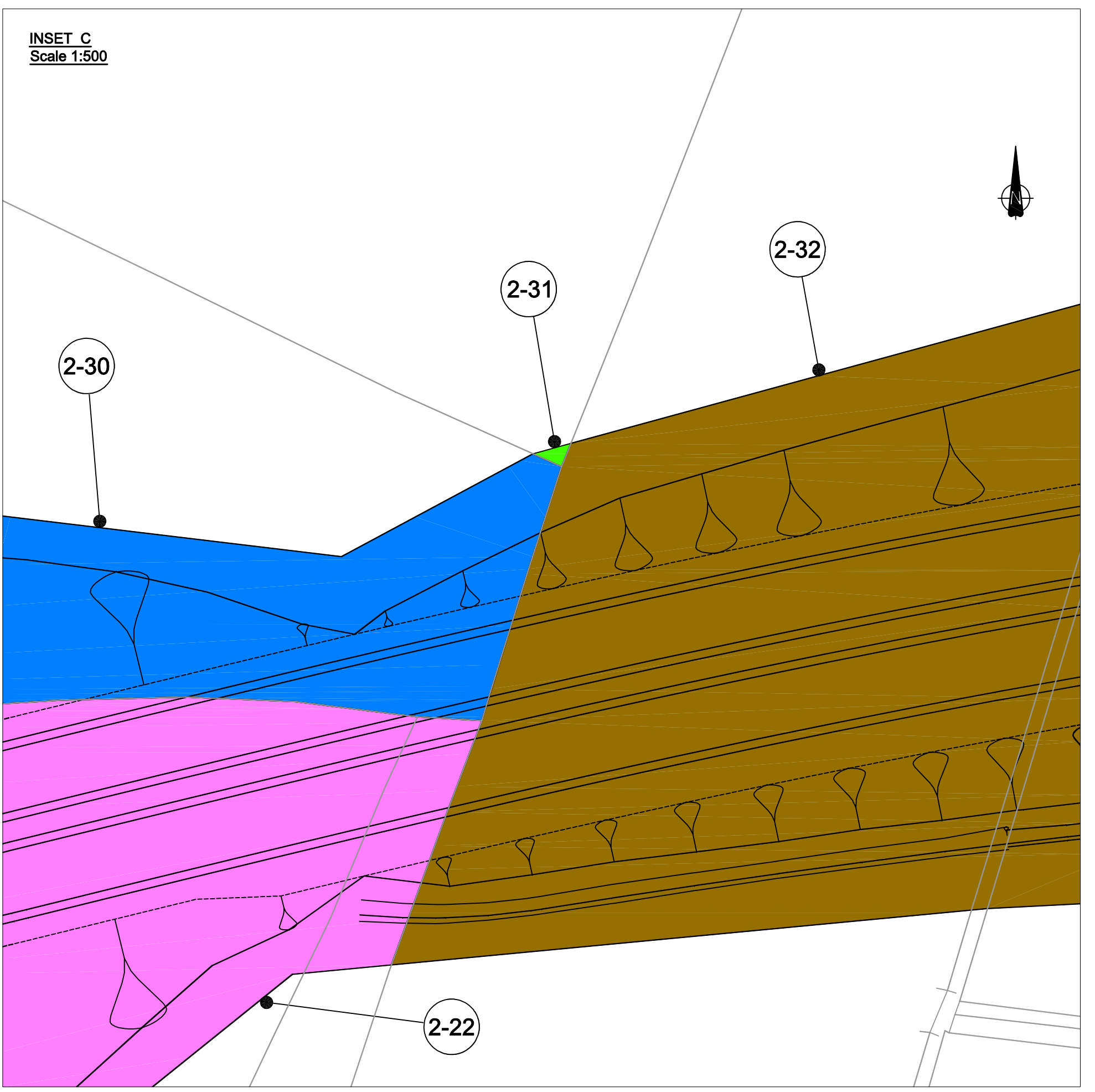
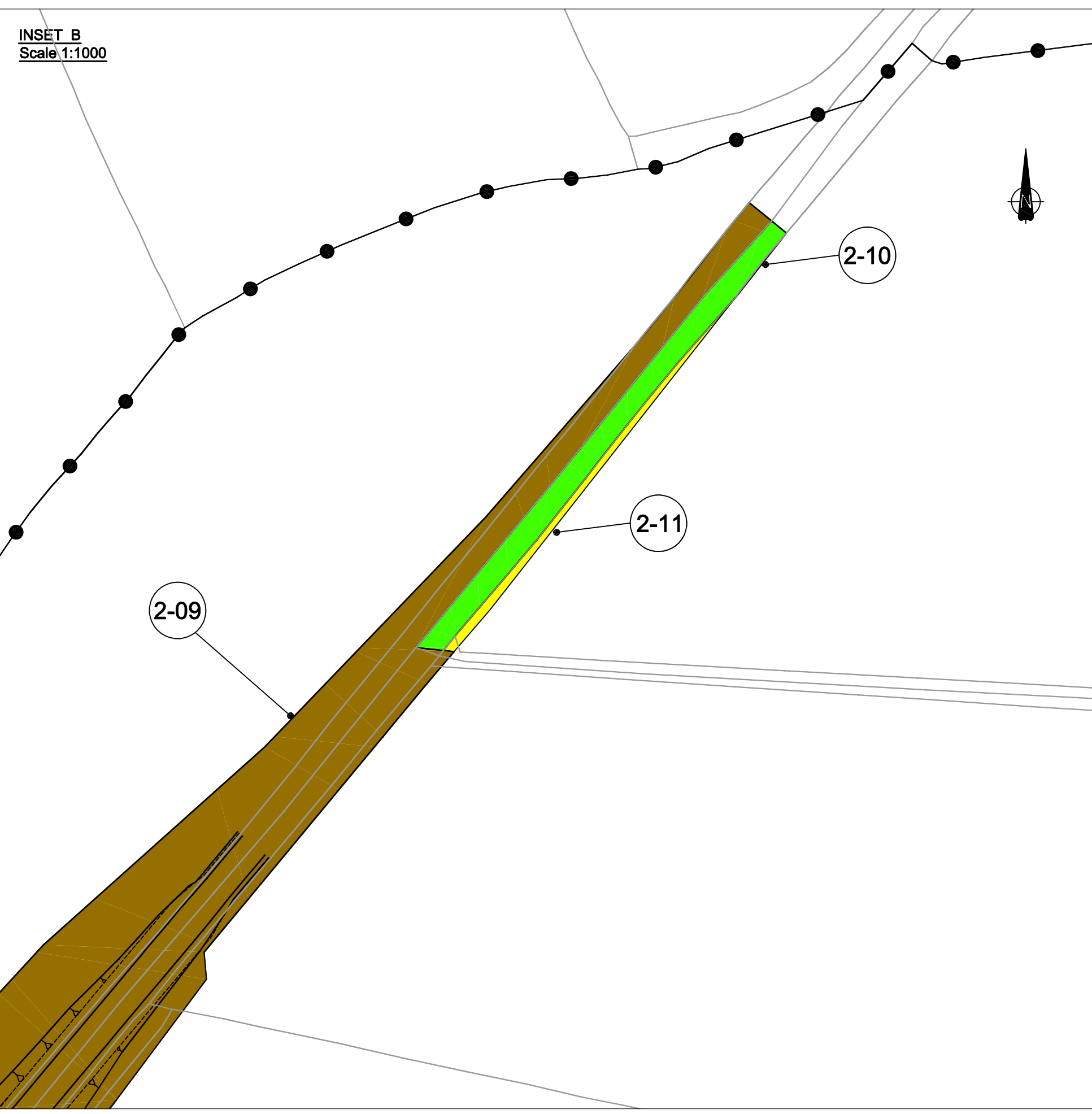
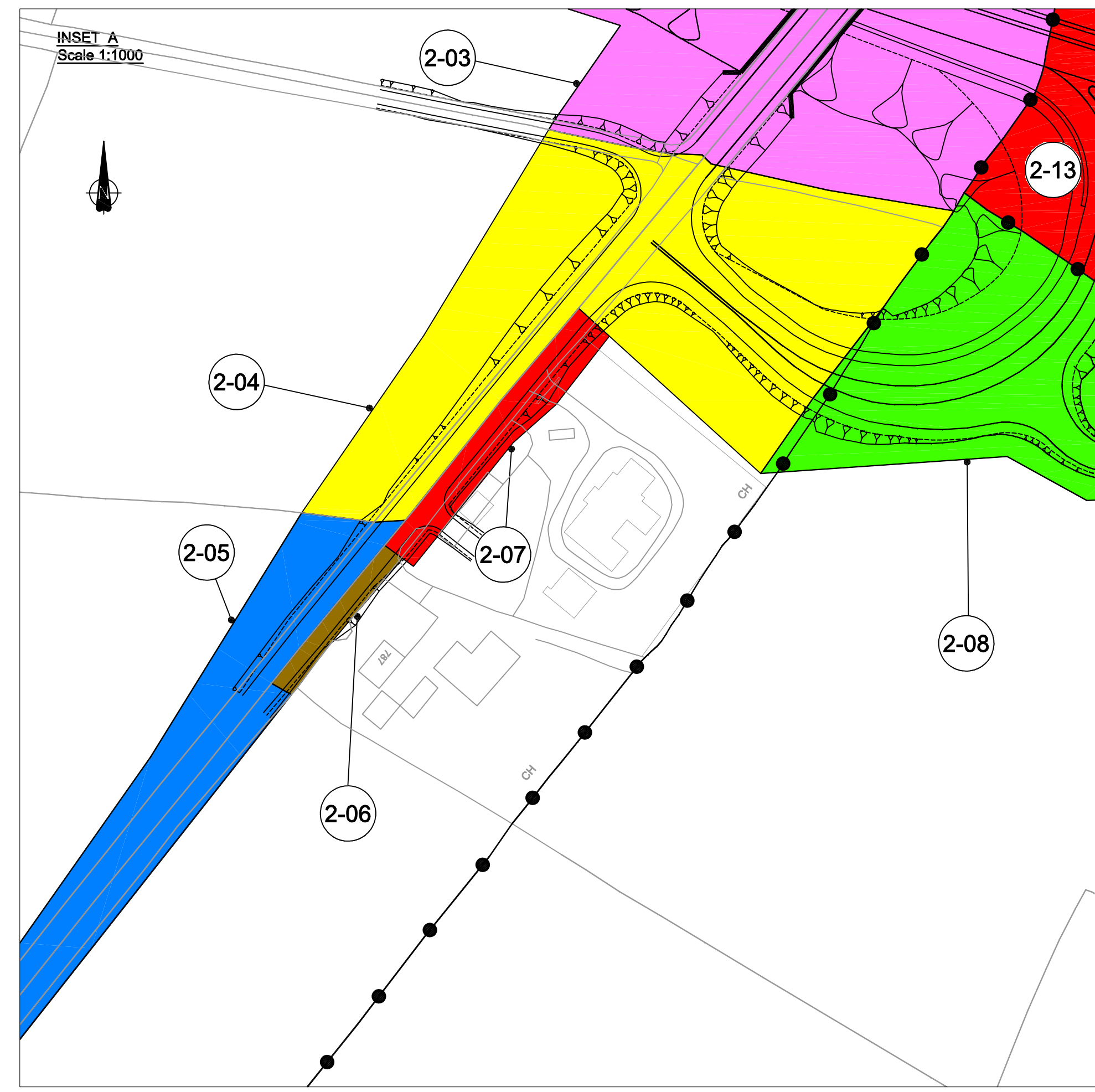
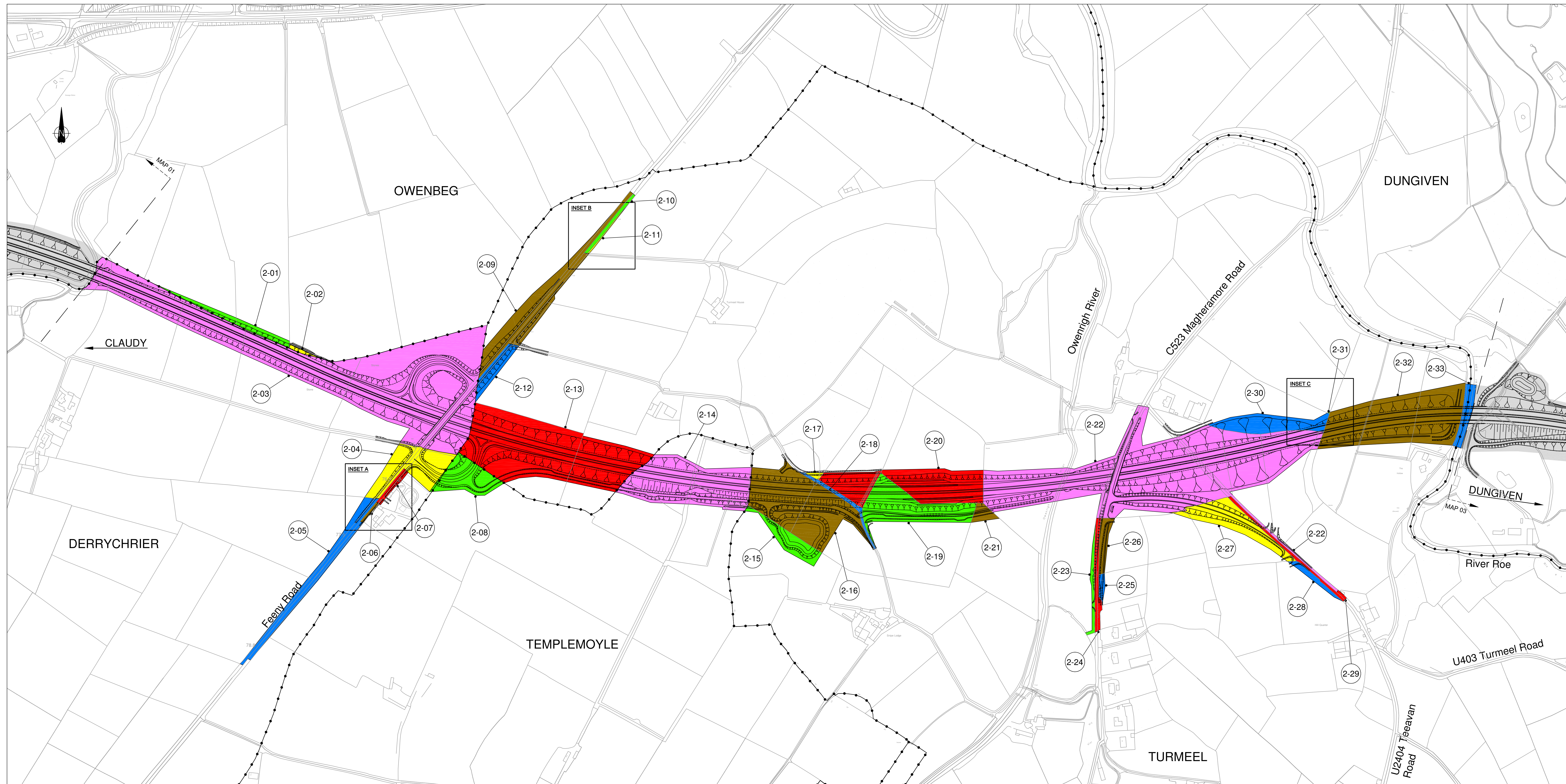

REVISED DRAWING TITLE	RM	JC	09-11-11	C
SECOND ISSUE	RM	JC	02-11-11	B
FIRST ISSUE	RM	JC	21-10-11	A
Revision Details	By	Date	Surfix	
	Crack			

DRAFT

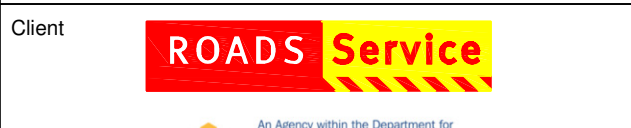

Co-financed by the European Union
Trans-European Transport Network (TEN-T)

Job Title
**NORTH WESTERN KEY TRANSPORT CORRIDOR
A6 LONDONDERRY TO DUNGIVEN
DUALLING SCHEME**

Drawing Title
**LAND PLAN SECTION 3
DERRYCHRIER ROAD TO
CREBARKEY ROAD
MAP 2 OF 3**

Scale at A0	1:2500, 1:1000, 1:500	Approved
Drawn	Checked	RG
RM	JC	
Date	Date	Date
OCT 2011	OCT 2011	OCT 2011



Drawing Number
S106466 - VO(3) - 002

MAP 2

File Path: AutoCAD File Name: 080V

THIS DRAWING MAY BE USED ONLY FOR THE PURPOSE INTENDED AND ONLY WRITTEN DIMENSIONS SHALL BE USED.

This material is based upon Crown Copyright and is reproduced with the permission of Land & Property Services under delegated authority from the Controller of Her Majesty's Stationery Office. © Crown copyright and database right. TMA (E) 54/2/14. Unauthorised reproduction infringes © Crown copyright & may lead to prosecution or civil proceedings.

MAP 3

- Key:**
- TOWNLAND BOUNDARY
 - (X.XX) PLOT REFERENCE WITHIN SCHEDULE
 - MATCHLINE
 - AREA VESTED FROM FOLIO

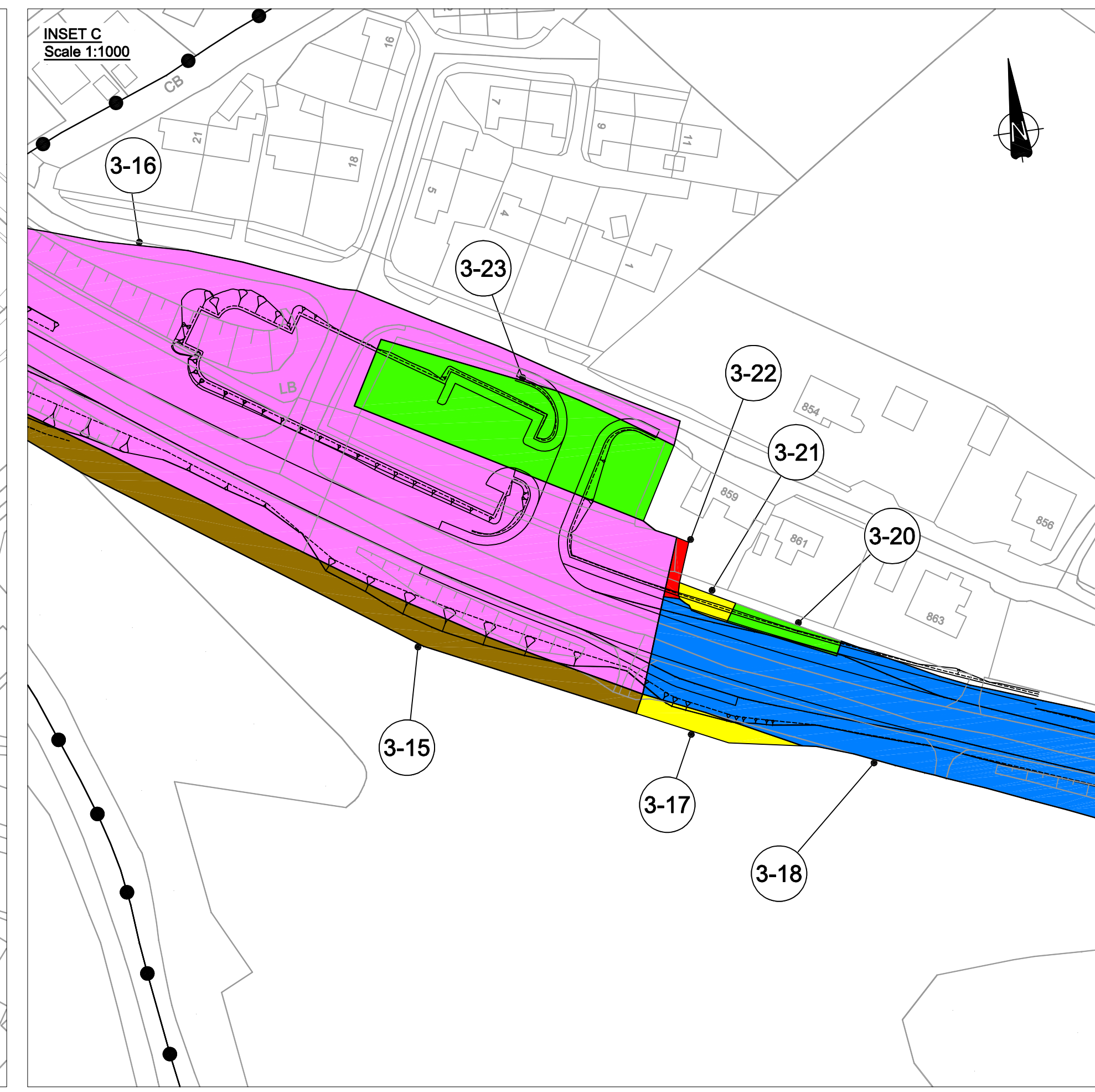
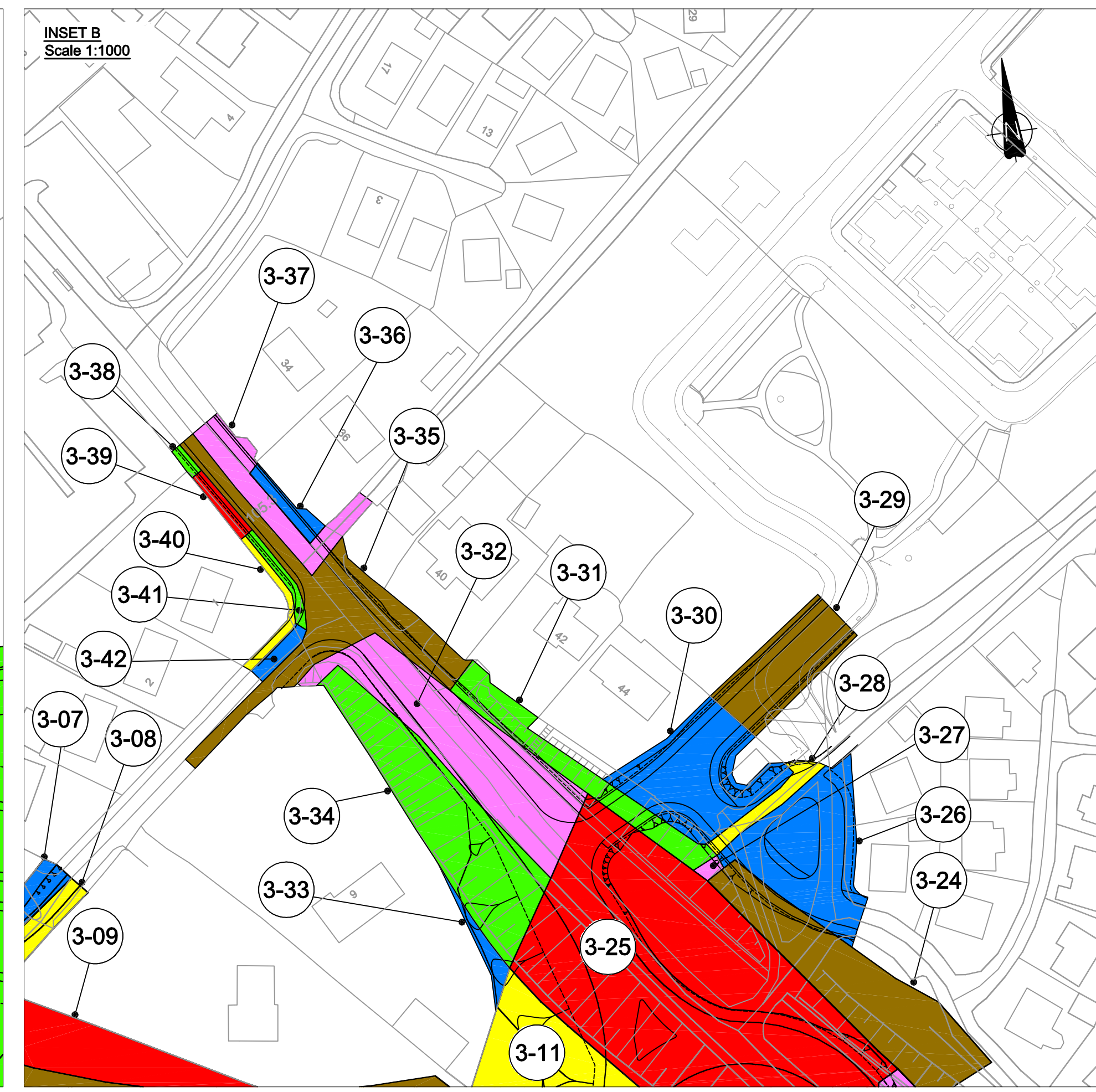
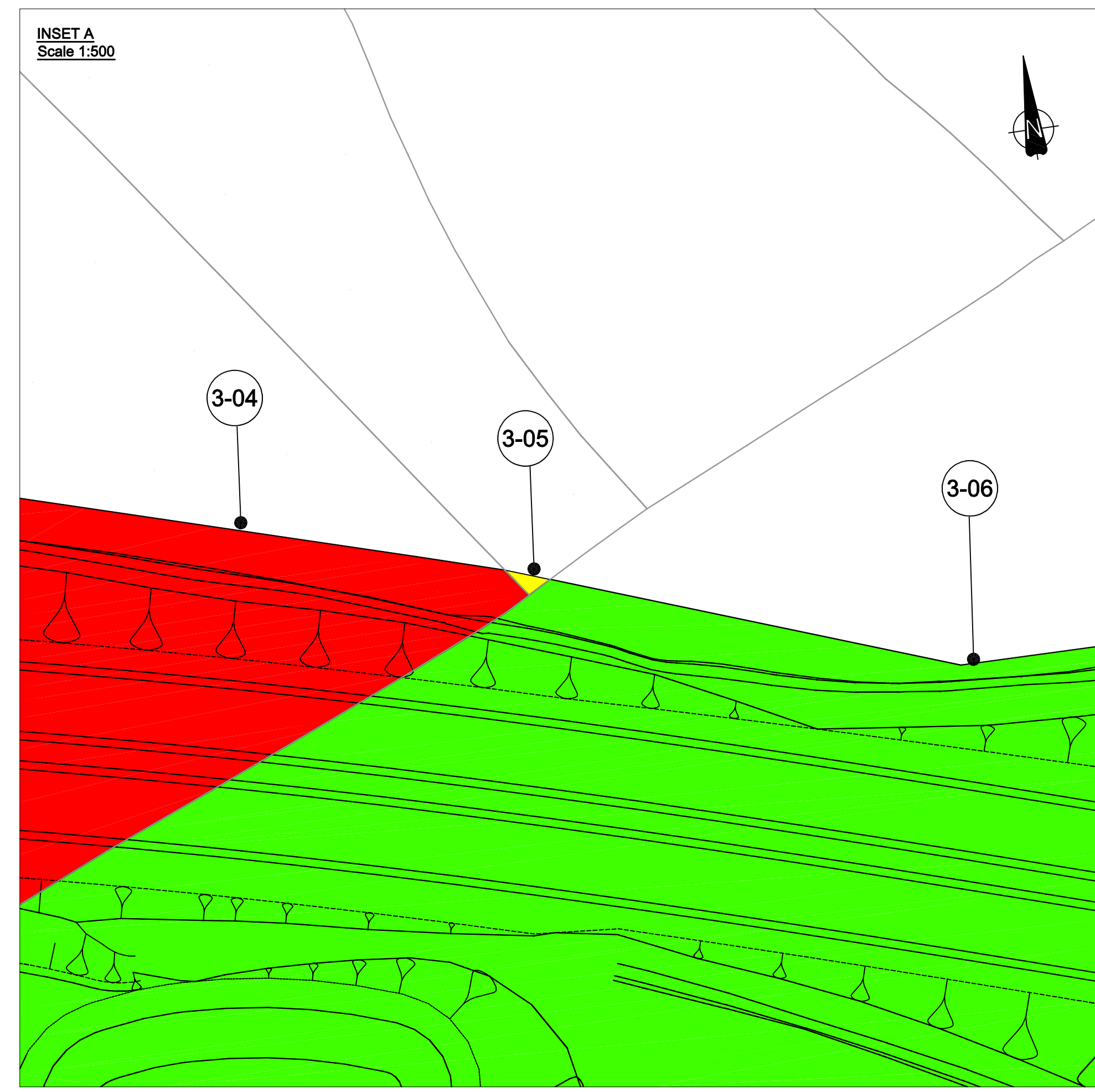
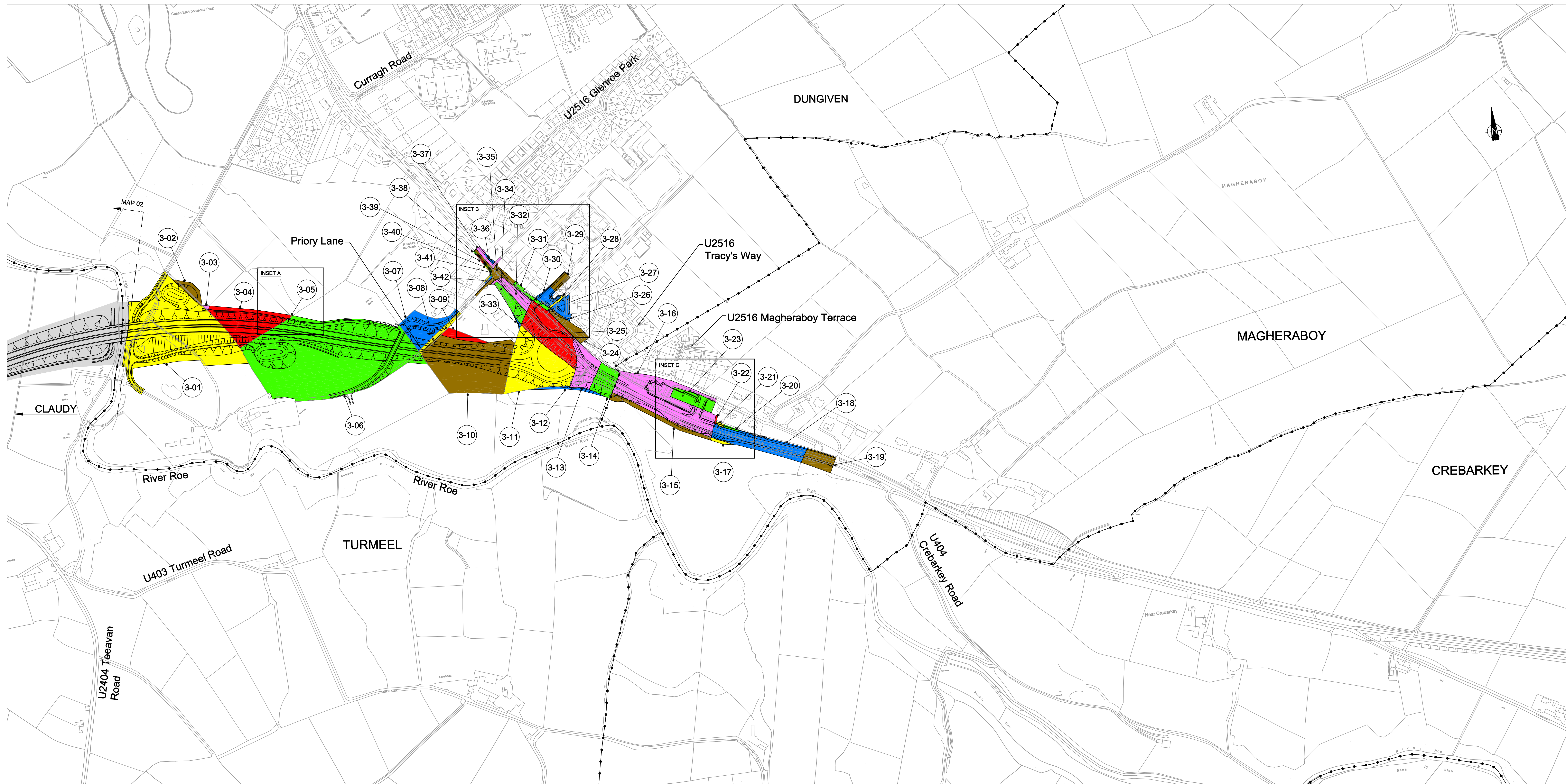

REVISED DRAWING TITLE	RM	JC	09-11-11	C
SECOND ISSUE	RM	JC	02-11-11	B
FIRST ISSUE	RM	JC	24-10-11	A
Revision Details	By	Date	Suffix	
	Crack			

DRAFT

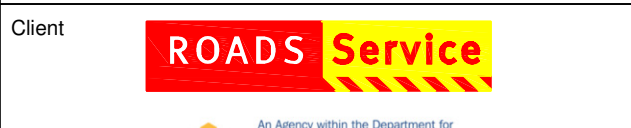

Co-financed by the European Union
Trans-European Transport Network (TEN-T)

Job Title
**NORTH WESTERN KEY TRANSPORT CORRIDOR
A6 LONDONDERRY TO DUNGIVEN
DUALLING SCHEME**

Drawing Title
**LAND PLAN SECTION 3
DERRYCHRIER ROAD TO
CREBARKEY ROAD
MAP 3 OF 3**

Scale at A0	1:2500, 1:1000, 1:500	Approved
Drawn	Checked	RG
RM	JC	
Date	Date	Date
OCT 2011	OCT 2011	OCT 2011



Drawing Number
S106466 - VO(3) - 003

MAP 3