

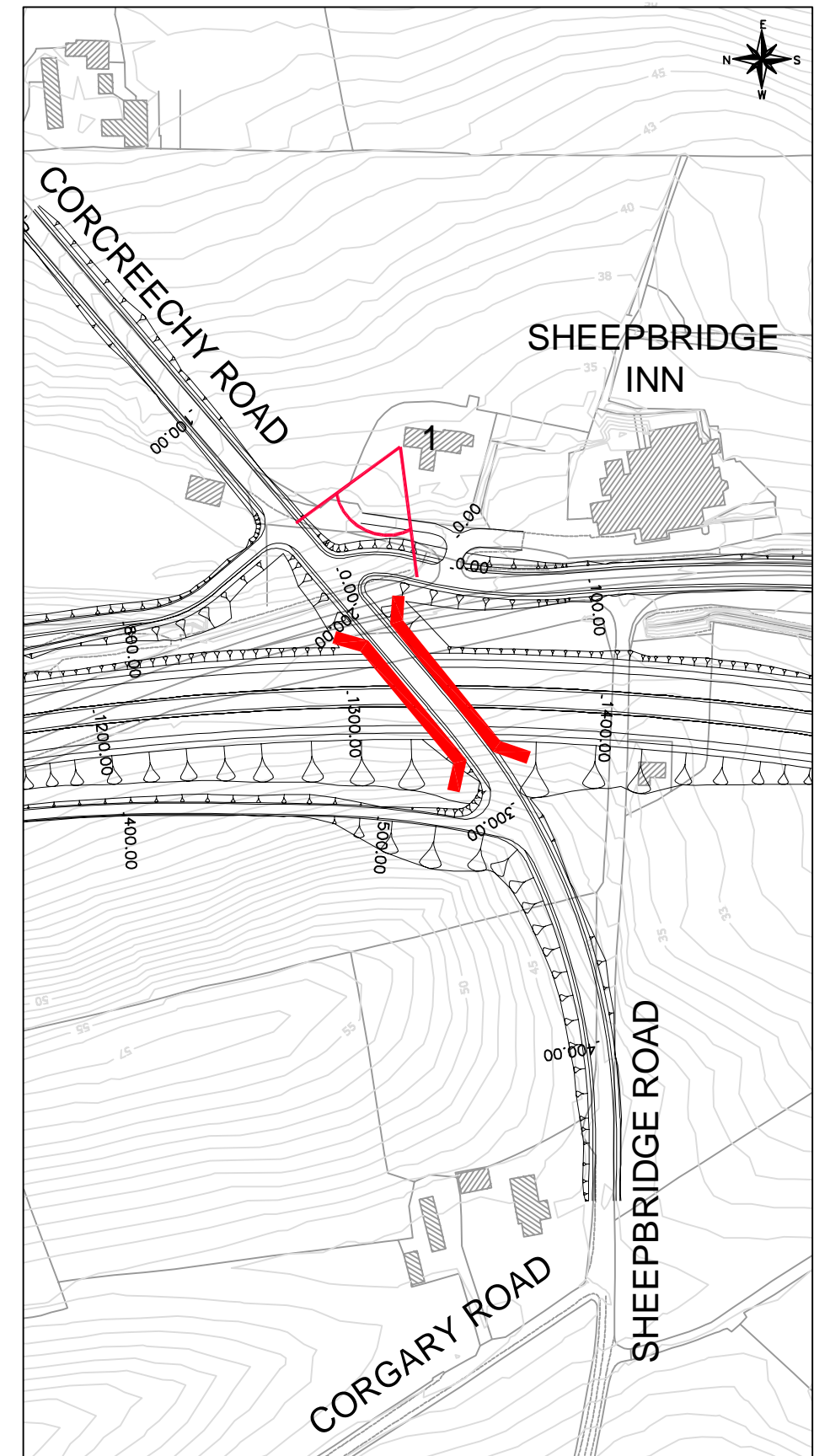

VIEWPOINT 01 - VIEW FROM HOUSE No.1 CORCREECHY ROAD (EXISTING)



VIEWPOINT 01 - PROPOSED SHEEPBRIDGE ROAD OVERBRIDGE (PRIOR TO MITIGATION)



**LOCATION OF VIEWPOINT 01
SCALE 1:2,500**



VIEWPOINT 02 - VIEW LOOKING NORTH WEST FROM CLOGHANRAMER ROAD NEAR HOUSE No.83 (EXISTING)



VIEWPOINT 02 - PROPOSED A1 DUAL CARRAIGEWAY (PRIOR TO MITIGATION)

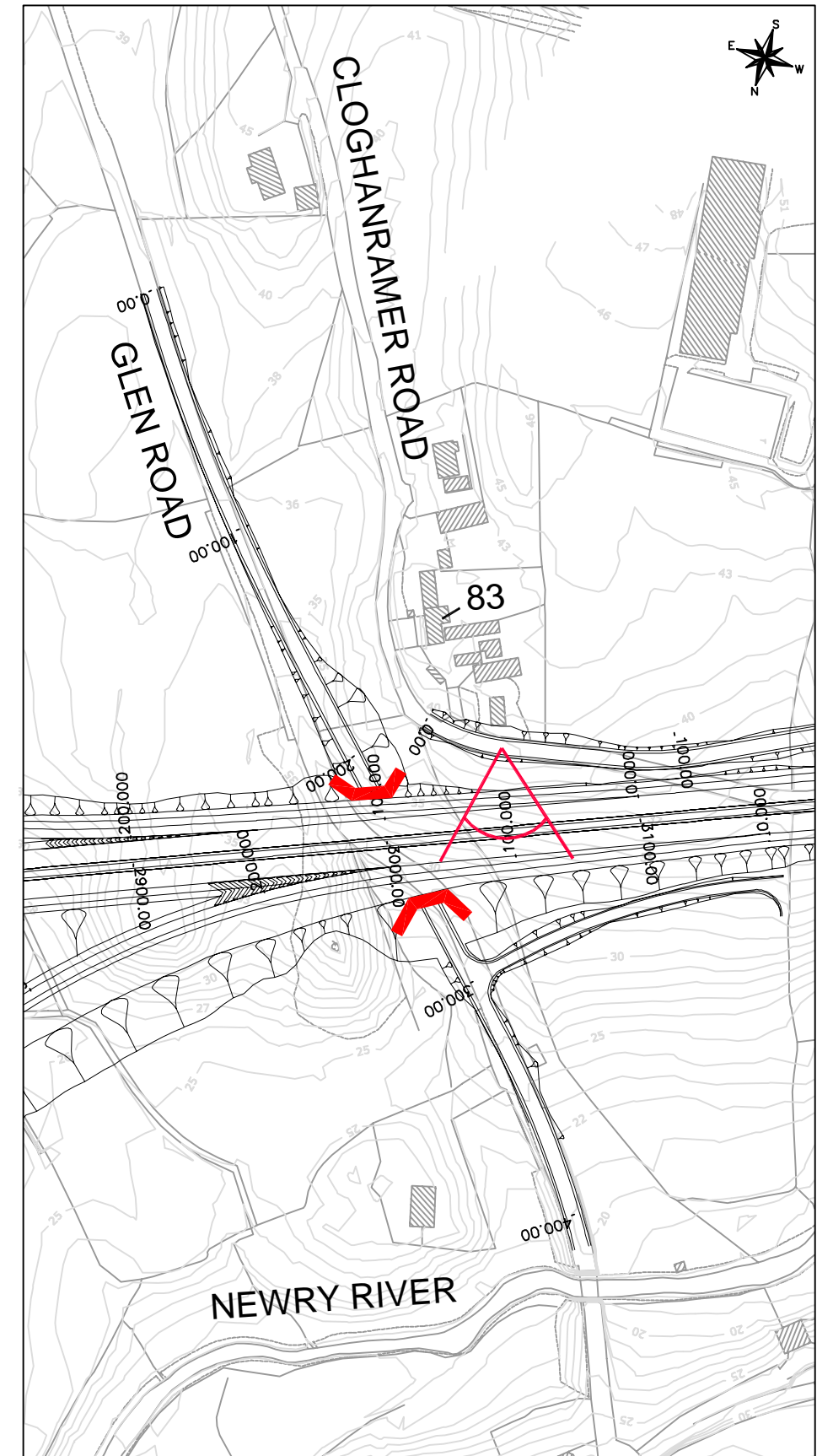

**LOCATION OF VIEWPOINT 02
SCALE 1:2,500**



VIEWPOINT 03 - VIEW LOOKING NORTH WEST FROM CLOGHANRAMER ROAD NEAR HOUSE No.69 (EXISTING)

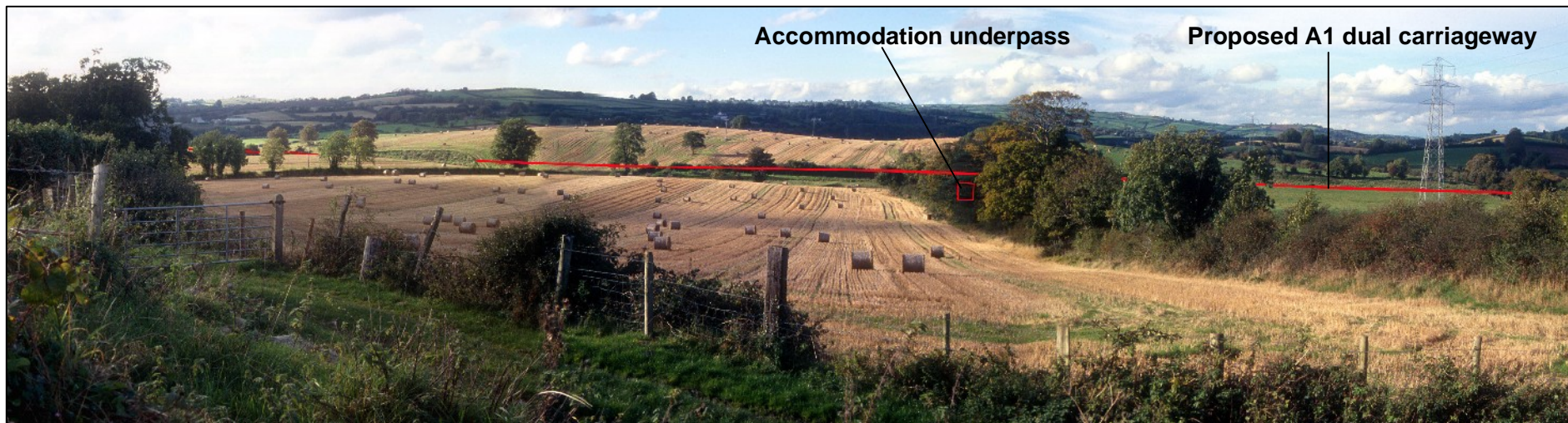

VIEWPOINT 03 - LOCATION OF PROPOSED ROAD (PRIOR TO MITIGATION)

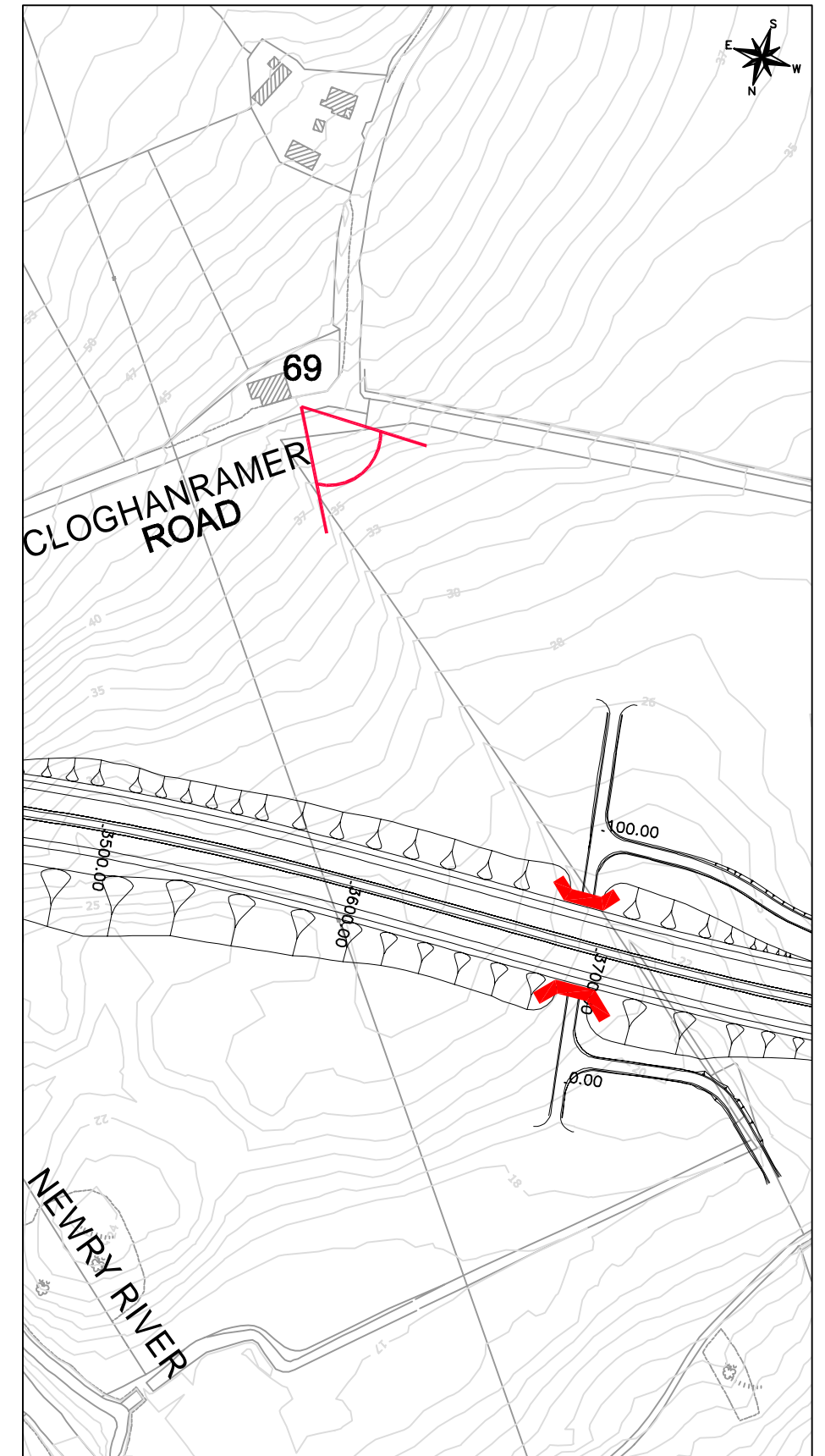

**LOCATION OF VIEWPOINT 03
SCALE 1:2,500**



VIEWPOINT 04 - VIEW SOUTH ADJACENT TO HOUSE No.56 TANDRAGEE ROAD (EXISTING)



VIEWPOINT 04 - LOCATION OF PROPOSED BRIDGE AND ABUTMENT

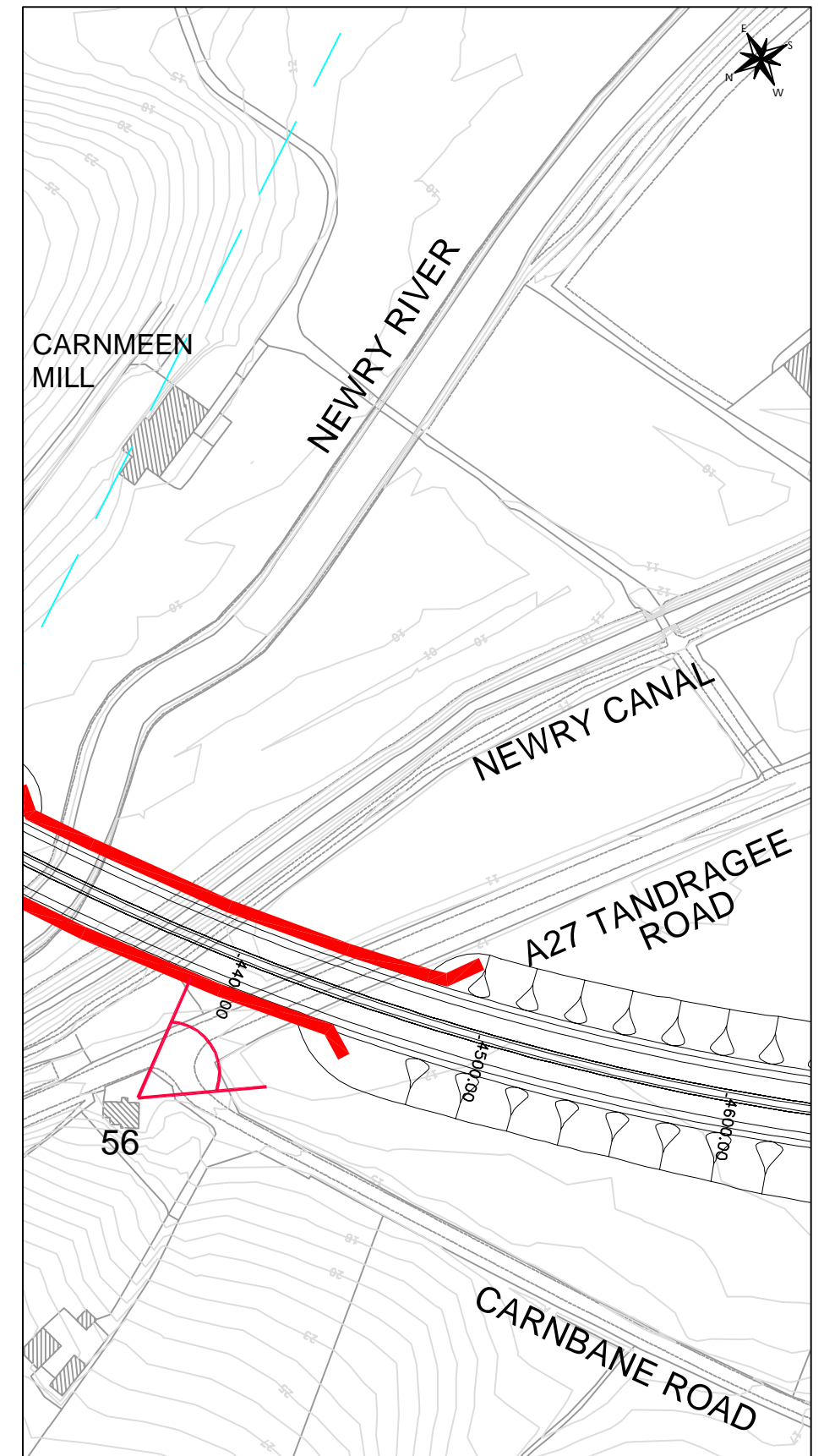

**LOCATION OF VIEWPOINT 04
SCALE 1:2,500**



VIEWPOINT 05 - VIEW ADJACENT TO HOUSE No.144 ARMAGH ROAD (A28) LOOKING SOUTH EAST (EXISTING)

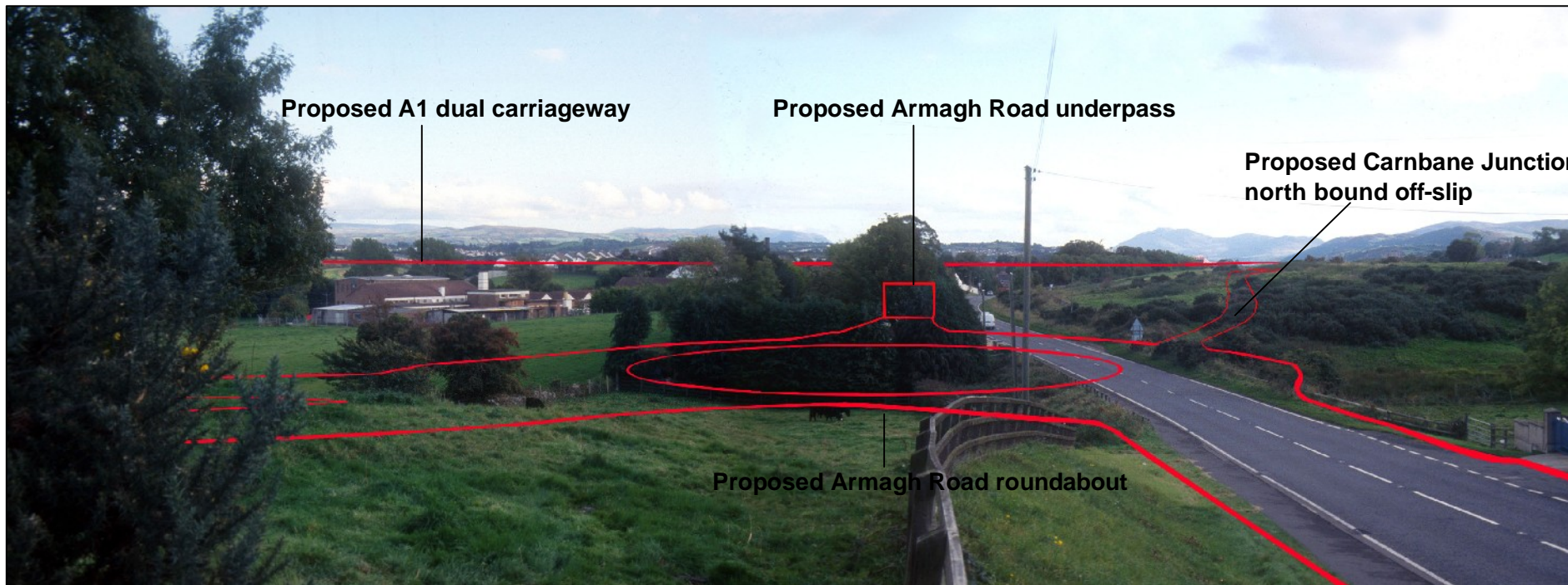

VIEWPOINT 05 - LOCATION OF PROPOSED CARNBANE JUNCTION

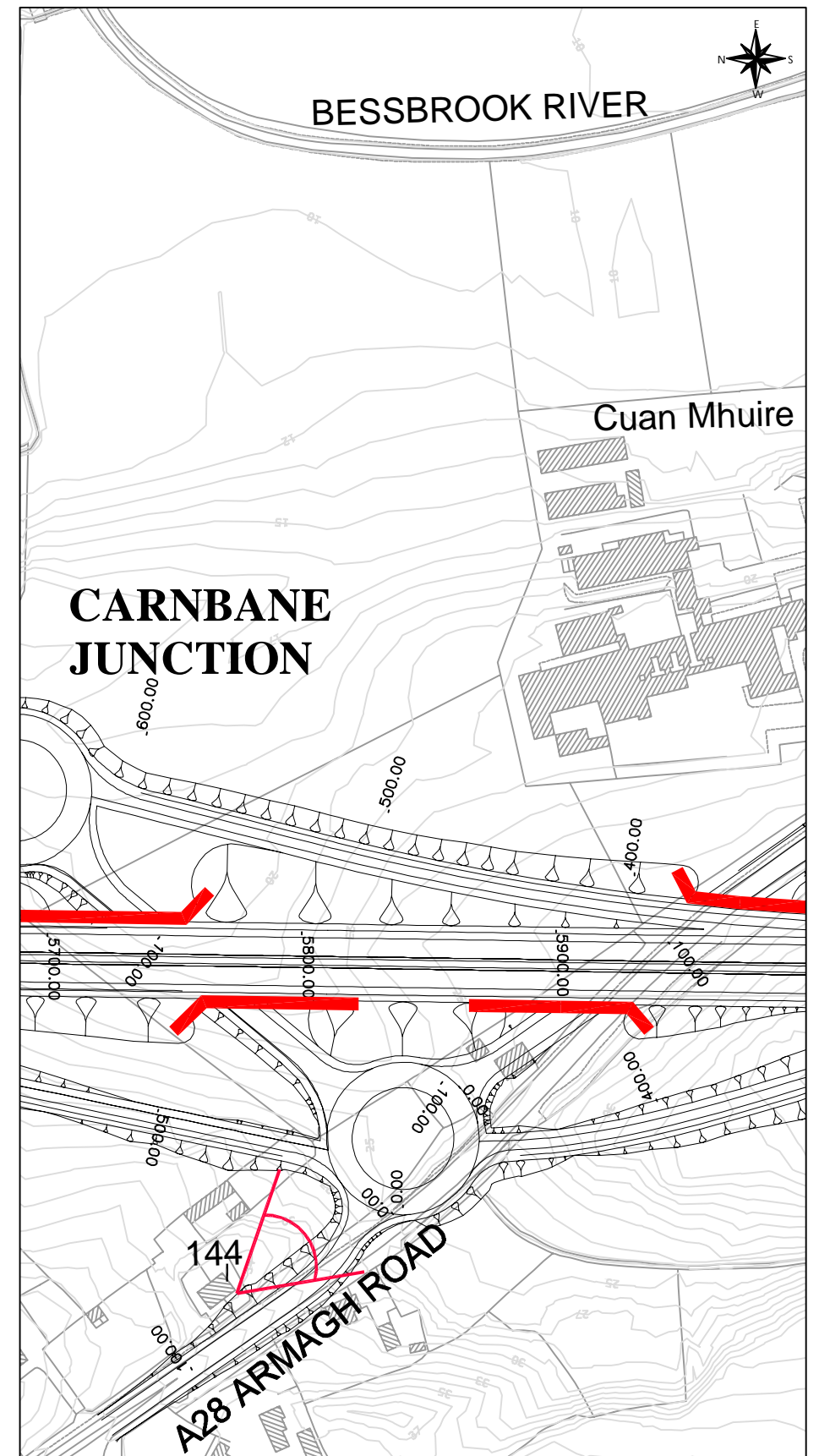

LOCATION OF VIEWPOINT 05
SCALE 1:2,500



VIEWPOINT 06 - VIEW FROM CAMLOUGH ROAD LOOKING EAST TOWARDS EGYPTIAN ARCH (EXISTING)



VIEWPOINT 06 - LOCATION OF PROPOSED CAMLOUGH ROAD JUNCTION AS SEEN THROUGH EGYPTIAN ARCH

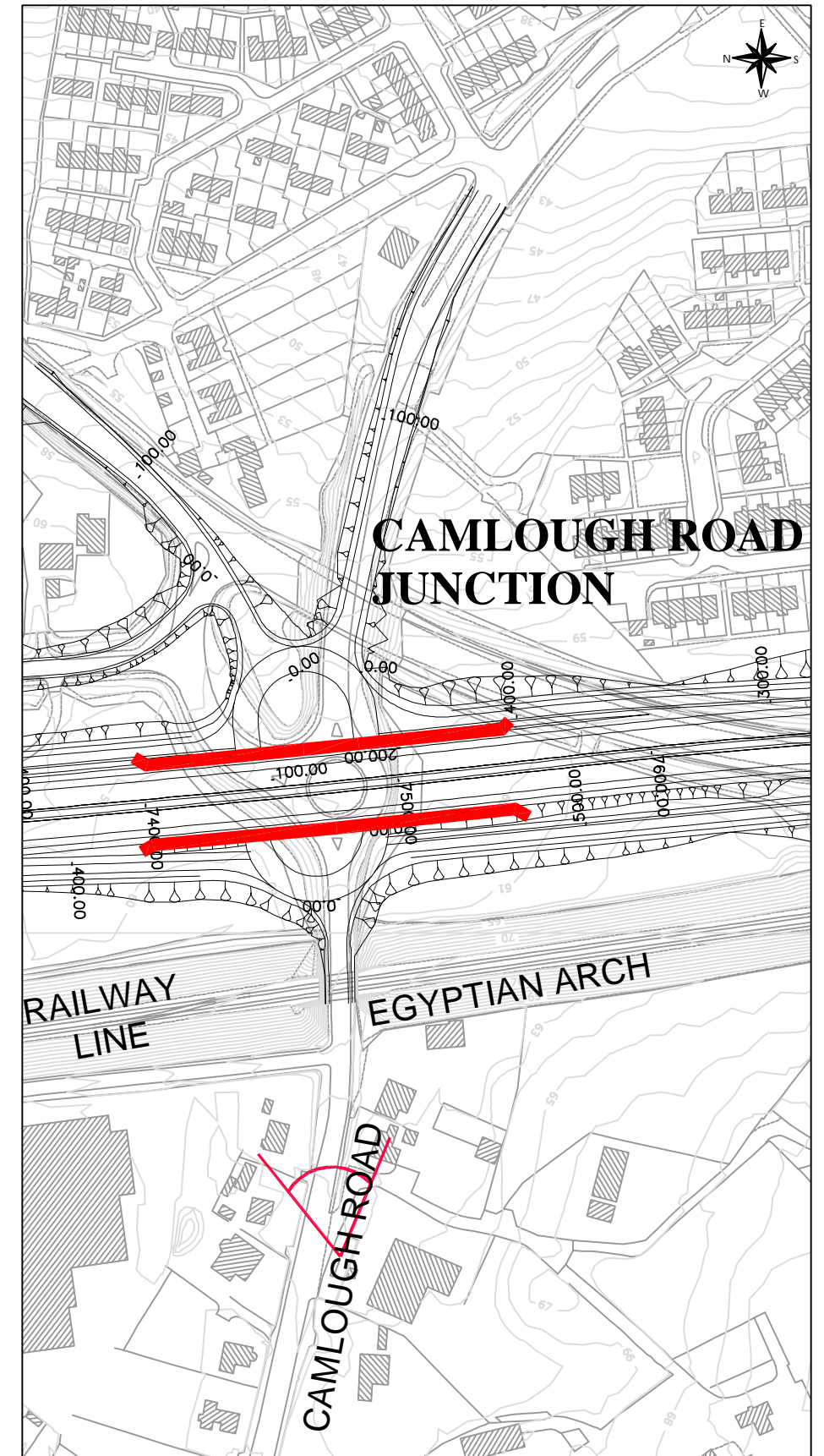

**LOCATION OF VIEWPOINT 06
SCALE 1:2,500**



VIEWPOINT 07 - VIEW FROM 10 MOURNEVIEW TERRACE (EXISTING)



VIEWPOINT 07 - LOCATION OF PROPOSED BRIDGE AND ABUTMENT

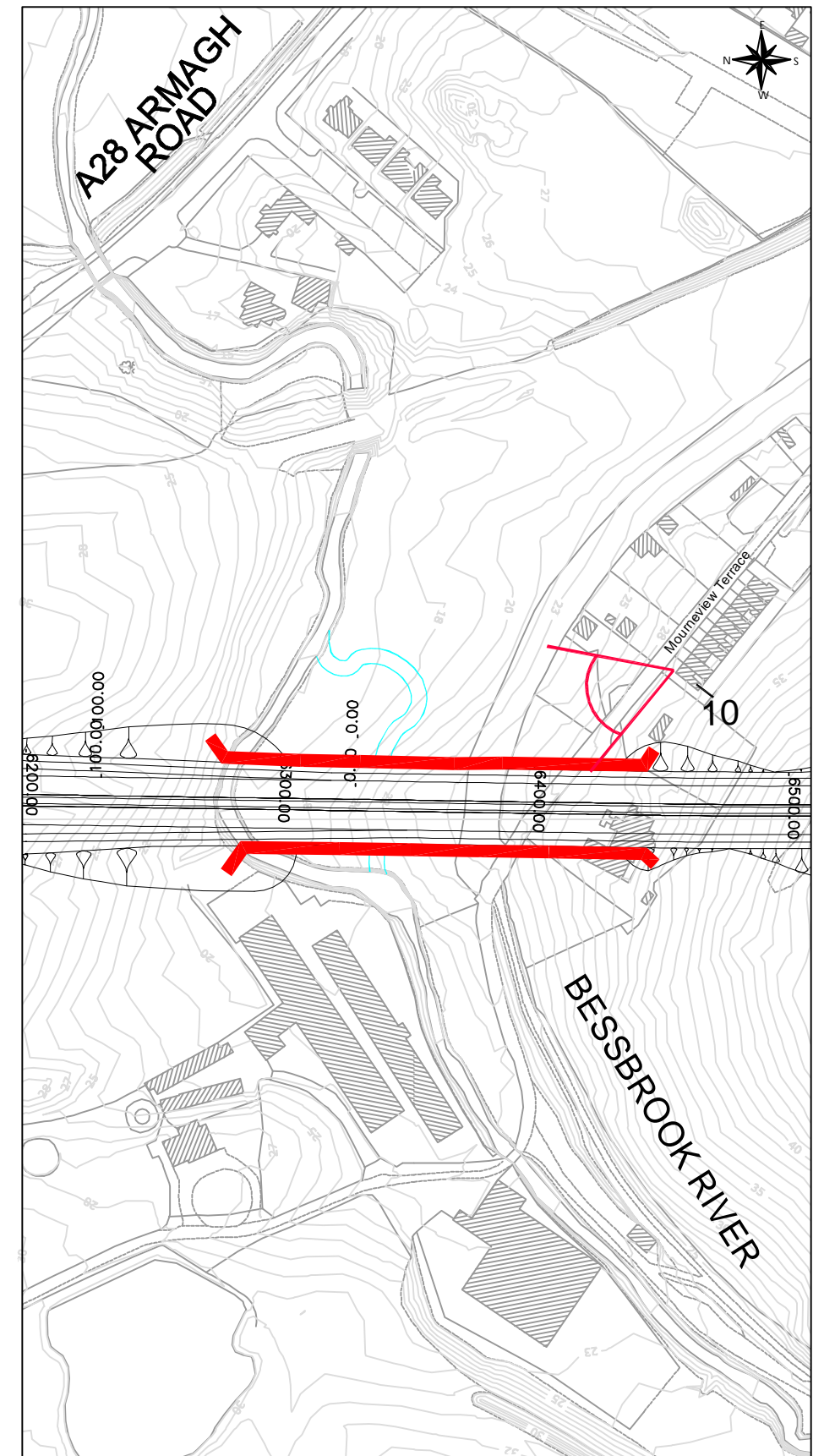

**LOCATION OF VIEWPOINT 07
SCALE 1:2,500**