

- DO NOT SCALE**
- Existing boundary line
 - Sign face and pole to be removed to tip off site
 - Sign face plate to be removed from where previously set aside and mounted on new sign post
 - Proposed road markings
 - Proposed 100 x 100mm square non-reflective road stud
 - Proposed 20mm trapezoidal delineator strip
 - Proposed 60mm kerb
 - Proposed 100mm kerb
 - Proposed 125mm kerb
 - Proposed 60mm drain kerb
 - Proposed 100mm drain kerb
 - Proposed 125mm drain kerb
 - Proposed dropped kerbs
 - Proposed transition kerb
 - Proposed bus stop kerb
 - Proposed edge kerb
 - Proposed precast buff blistered tactile flags for uncontrolled pedestrian crossings
 - Proposed precast red blistered tactile flags for controlled pedestrian crossings
 - Proposed precast buff segregated shared cycletrack/ footway tactile flags
 - Proposed sinusoidal cycle track transition.
 - Proposed flat top road hump.
 - Proposed footway
 - Proposed carriageway
 - Proposed cycle track
 - Proposed landscaping strip / grass verge
 - Proposed mini ensign bollard
 - Existing tree to be retained
 - Existing tree to be removed
 - Existing precast concrete ditched channel to be removed.
 - Proposed precast concrete ditched channel with footpath gully.
 - Existing gully to remain.
 - Existing gully cover, frame and pot to be taken up and removed to tip off site. Hole to be backfilled with granular Type 1 unbound material and surface using bituminous material to proposed levels.
 - Proposed standard gully to be connected to existing drainage network. Cycle friendly grating when in cycle path.
 - Proposed Bus Shelter
 - Bus Shelter to be removed / relocated
 - Proposed traffic signal pole
 - Proposed zebra crossing belisha beacon
 - Advanced stop line carriageway surfacing
 - Indicative land acquisition
 - Proposed boundary fence
 - Existing post box to be retained

P01.01	20/04/26	JF	First Revision	RH	CB
REV	DATE	BY	DESCRIPTION	CHK	APP

DRAWING STATUS: Suitable for Information

SUITABILITY: S1



PROJECT TITLE: Ravenhill Road / Ormeau Embankment

DRAWING TITLE: Speed Limit Order
General Arrangement
Sheet 1 of 3

SCALE:	1:250	DRAWN:	JF	CHECKED:	RH	APPROVED:	CB	AUTHORISED:	---
ORIGINAL SIZE:	A1	DATE:	20/04/2026	DATE:	---	DATE:	---	DATE:	---

DRAWING NUMBER:	Project Originator	System Key	Type	Number	REVISION:
UK0039665-WSP-AT-TM036-D-H-001260					P01.01

© WSP UK Ltd

File name: C:\P\WORKDIR\WSP-UK-PW-23\DWG\WSP-AT-TM036-D-H-001260.DWG, printed on: 20 April 2026 17:06:37, by: Ferguson, Jack

This is Based upon Crown Copyright and is reproduced with the permission of Land & Property Services under delegated authority from the Keeper of Public Records, Crown copyright and database right (2024) NIMA MOUS77.7

File name: C:\P\WORKDIR\WSP-LJK-PW-23\DWG\WSP-AT-TM036-D-H-001261.DWG, printed on 21 April 2026 10:43:24, by Ferguson, Jack

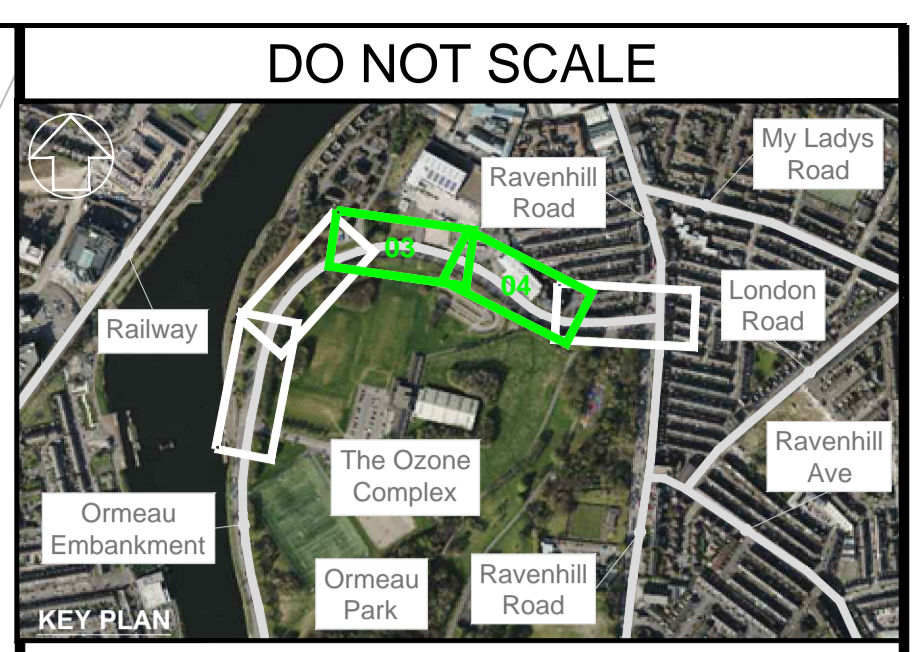
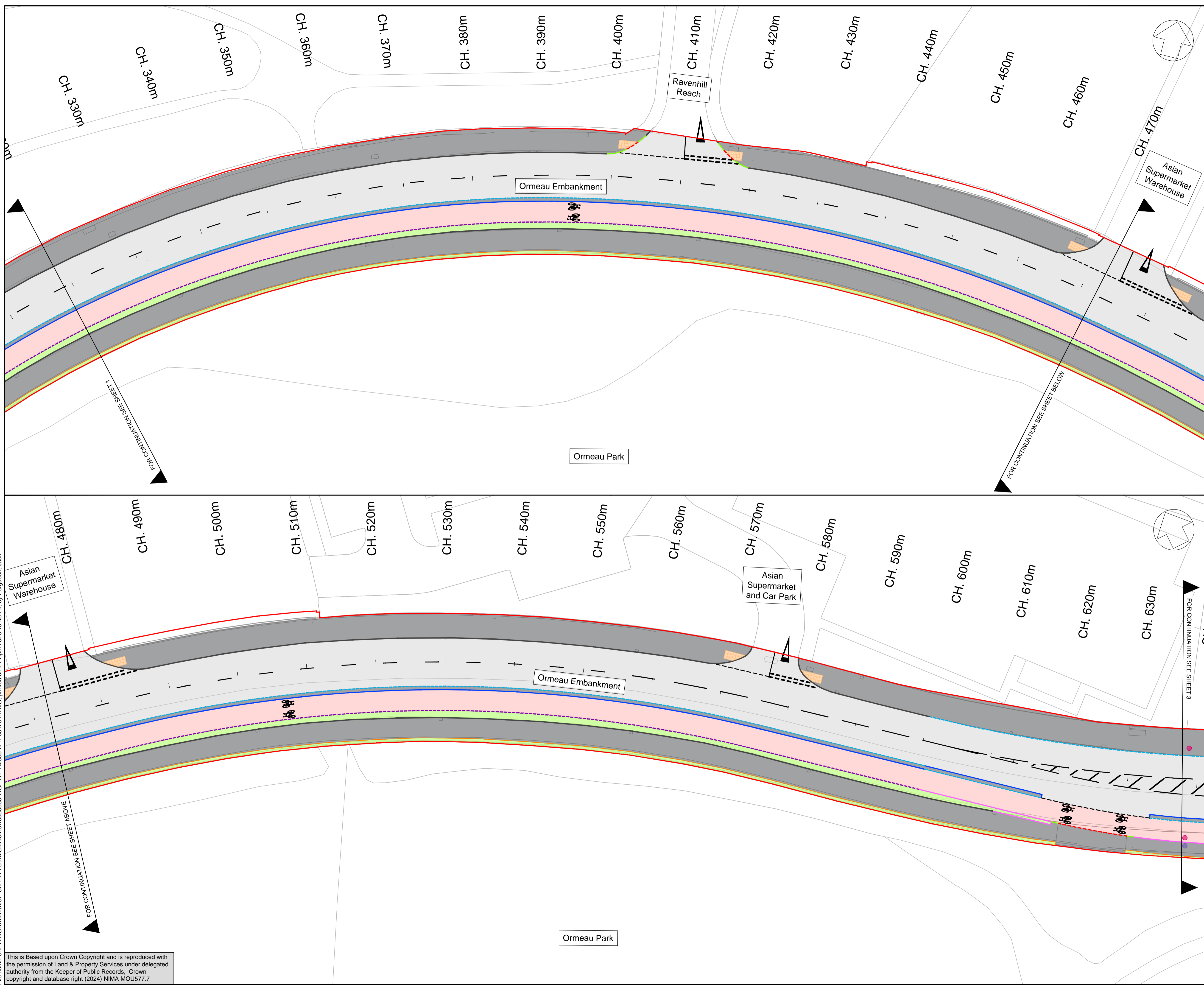

- DO NOT SCALE**
- Existing boundary line
 - Sign face and pole to be removed to tip off site
 - Sign face plate to be removed from where previously set aside and mounted on new sign post
 - Proposed road markings
 - Proposed 100 x 100mm square non-reflective road stud
 - Proposed 20mm trapezoidal delineator strip
 - Proposed 60mm kerb
 - Proposed 100mm kerb
 - Proposed 125mm kerb
 - Proposed 60mm drain kerb
 - Proposed 100mm drain kerb
 - Proposed 125mm drain kerb
 - Proposed dropped kerbs
 - Proposed transition kerb
 - Proposed bus stop kerb
 - Proposed edge kerb
 - Proposed precast buff blistered tactile flags for uncontrolled pedestrian crossings
 - Proposed precast red blistered tactile flags for controlled pedestrian crossings
 - Proposed precast buff segregated shared cycletrack/ footway tactile flags
 - Proposed sinusoidal cycle track transition.
 - Proposed flat top road hump.
 - Proposed footway
 - Proposed carriageway
 - Proposed cycle track
 - Proposed landscaping strip / grass verge
 - Proposed mini ensign bollard
 - Existing tree to be retained
 - Existing tree to be removed
 - Existing precast concrete ditch channel to be removed.
 - Proposed precast concrete ditch channel with footpath gully.
 - Existing gully to remain.
 - Existing gully cover, frame and pot to be taken up and removed to tip off site. Hole to be backfilled with granular Type 1 unbound material and surface using bituminous material to proposed levels.
 - Proposed standard gully to be connected to existing drainage network. Cycle friendly grating when in cycle path.
 - Proposed Bus Shelter
 - Bus Shelter to be removed / relocated
 - Proposed traffic signal pole
 - Proposed zebra crossing belisha beacon
 - Advanced stop line carriageway surfacing
 - Indicative land acquisition
 - Proposed boundary fence
 - Existing post box to be retained

P01.01	20/04/26	JF	First Revision	RH	CB
REV	DATE	BY	DESCRIPTION	CHK	APP
DRAWING STATUS: Suitable for Information				SUITABILITY: S1	

wsp
 Ground Floor, The Solist, Lanyon Place, Belfast, BT1 3LP, UK
 T+ 44 (0) 28 9595 3053
 wsp.com

CLIENT:

Department for Infrastructure
 An Roinn Bonnegain
 Department for Infrastructure
 www.infrastructure-ni.gov.uk

PROJECT TITLE:
 Ravenhill Road / Ormeau Embankment

DRAWING TITLE:
 Speed Limit Order
 General Arrangement
 Sheet 2 of 3

SCALE:	DRAWN:	CHECKED:	APPROVED:	AUTHORISED:
1:250	JF	RH	CB	---
ORIGINAL SIZE:	DATE:	DATE:	DATE:	DATE:
A1	20/04/2026	---	---	---

DRAWING NUMBER:	REVISION:
Project Originator System Key Type Number	P01.01
UK0039665-WSP-AT-TM036-D-H-001261	

© WSP UK Ltd

This is Based upon Crown Copyright and is reproduced with the permission of Land & Property Services under delegated authority from the Keeper of Public Records, Crown copyright and database right (2024) NIMA MOU577.7

File name: C:\P\WORKDIR\WSP-UK-PW-23\DWG\WSP-AT-TM036-D-H-001262.DWG, printed on 20 April 2026 17:12:27, by Ferguson, Jack

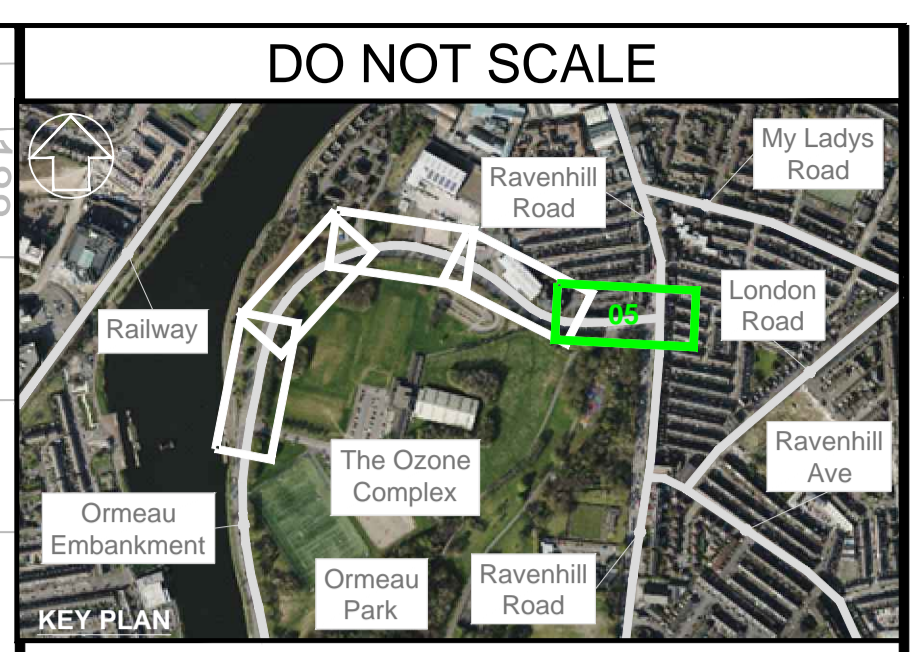
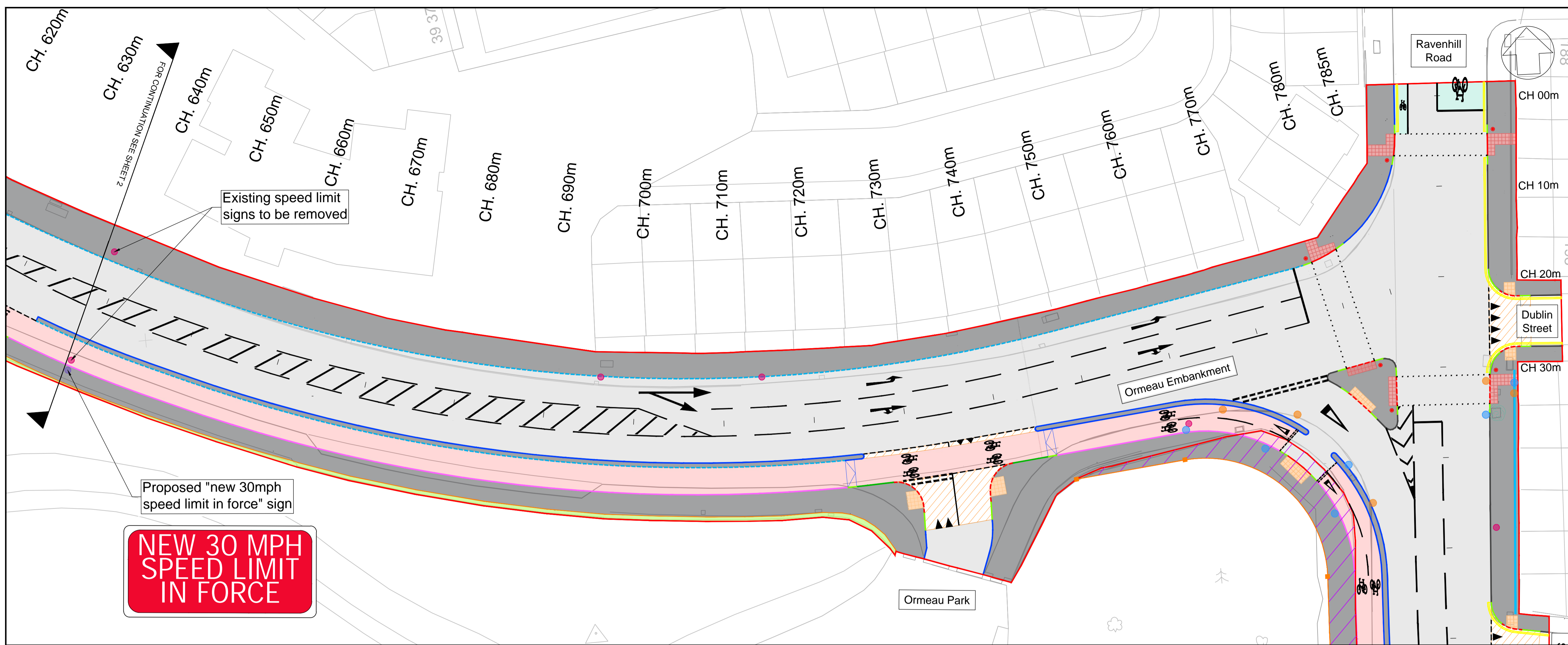

- DO NOT SCALE**
- Existing boundary line
 - Sign face and pole to be removed to tip off site
 - Sign face plate to be removed from where previously set aside and mounted on new sign post
 - Proposed road markings
 - Proposed 100 x 100mm square non-reflective road stud
 - Proposed 20mm trapezoidal delineator strip
 - Proposed 60mm kerb
 - Proposed 100mm kerb
 - Proposed 125mm kerb
 - Proposed 60mm drain kerb
 - Proposed 100mm drain kerb
 - Proposed 125mm drain kerb
 - Proposed dropped kerbs
 - Proposed transition kerb
 - Proposed bus stop kerb
 - Proposed edge kerb
 - Proposed precast buff blistered tactile flags for uncontrolled pedestrian crossings
 - Proposed precast red blistered tactile flags for controlled pedestrian crossings
 - Proposed precast buff segregated shared cycletrack/ footway tactile flags
 - Proposed sinusoidal cycle track transition.
 - Proposed flat top road hump.
 - Proposed footway
 - Proposed carriageway
 - Proposed cycle track
 - Proposed landscaping strip / grass verge
 - Proposed mini ensign bollard
 - Existing tree to be retained
 - Existing tree to be removed
 - Existing precast concrete ditch channel to be removed.
 - Proposed precast concrete ditch channel with footpath gully.
 - Existing gully to remain.
 - Existing gully cover, frame and pot to be taken up and removed to tip off site. Hole to be backfilled with granular Type 1 unbound material and surface using bituminous material to proposed levels.
 - Proposed standard gully to be connected to existing drainage network. Cycle friendly grating when in cycle path.
 - Proposed Bus Shelter
 - Bus Shelter to be removed / relocated
 - Proposed traffic signal pole
 - Proposed zebra crossing belisha beacon
 - Advanced stop line carriageway surfacing
 - Indicative land acquisition
 - Proposed boundary fence
 - Existing post box to be retained

P01.01	20/04/26	JF	First Revision	RH	CB
REV	DATE	BY	DESCRIPTION	CHK	APP

DRAWING STATUS: Suitable for Information
SUITABILITY: S1

Ground Floor, The Solist, Lanyon Place, Belfast, BT1 3LP, UK
T+ 44 (0) 28 9595 3053
wsp.com

CLIENT:

Department for Infrastructure
An Roinn Bonneagair
Department for Infrastructure
www.infrastructure-ni.gov.uk

PROJECT TITLE:
Ravenhill Road / Ormeau Embankment

DRAWING TITLE:
Speed Limit Order
General Arrangement
Sheet 3 of 3

SCALE:	DRAWN:	CHECKED:	APPROVED:	AUTHORISED:
1:250	JF	RH	CB	---
ORIGINAL SIZE:	DATE:	DATE:	DATE:	---
A1	20/04/2026	---	---	---

DRAWING NUMBER:	REVISION:
Project Originator System Key Type Number	P01.01
UK0039665-WSP-AT-TM036-D-H-001262	

© WSP UK Ltd

This is Based upon Crown Copyright and is reproduced with the permission of Land & Property Services under delegated authority from the Keeper of Public Records, Crown copyright and database right (2024) NIMA MOU577.7